



20 Elinor Bell Road Leschenault, WA

 4
  2
  3

FLAWLESS LESCHENAUPT RESIDENCE

A flawless display of colonial inspired design, this stunning residence blends effortless sophistication with the space and comfort of the ultimate entertainers home.

Showcasing high-end inclusions, the floorplan of this appealing home flows over two levels and has a focus on providing graceful living dedicated to rest, relaxation and entertaining for even the largest of families.

Ground Floor

- Generous family layout features both formal and informal living zones

For more details please visit :
<https://www.summitbunbury.com.au/4706471>

Price: Offers over \$680,000

Council Rates: \$2,064.91/year (approx)

Water Rates: \$257.90/year (approx)



Adrian Triplett

0419 971 888

Ground Floor

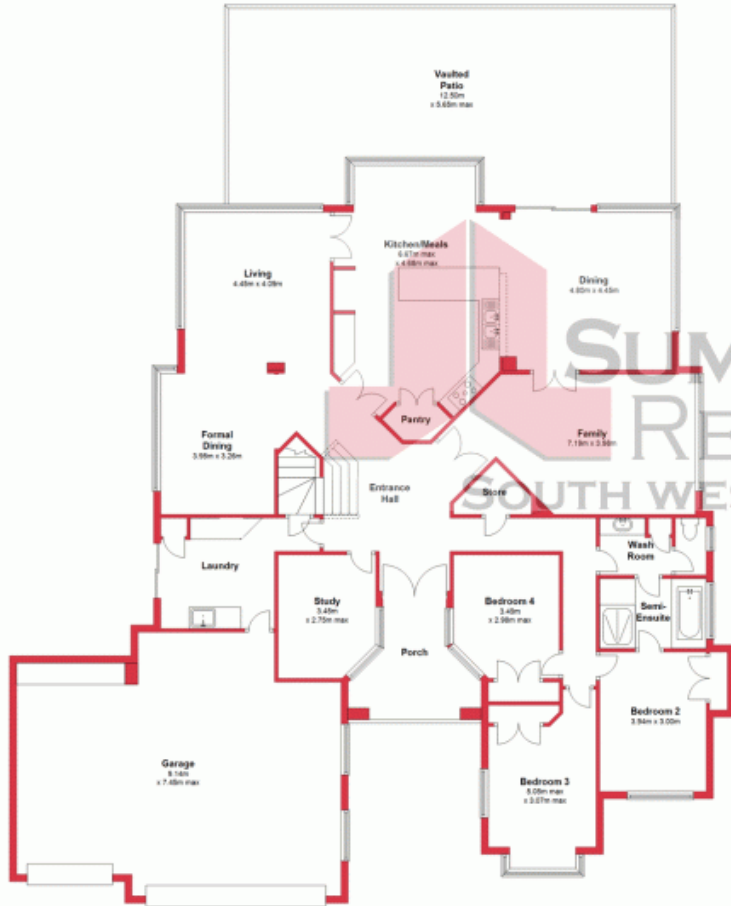

First Floor



This plan has been prepared for marketing purposes only. Whilst every care is taken in the production of this plan, measurements, angles and positioning of doors/windows may not be accurate. Interested parties are strongly advised to undertake their own checks when establishing the suitability for furniture etc. Not To Scale. Plan produced using PlanUp.

20 Elinor Bell Road, Leschenault

20 Elinor Bell Road

Leschenault, WA

