



26 Henslagh Turn Australind, WA

5 3 2

DESIGNER QUALITY, AMAZING LIFESTYLE

The grand entrance of this spectacular 5-bedroom, 3-bathroom residence welcomes you into its elegant spacious rooms, each one beautifully finished and fitted with every convenience to create your own peaceful haven.

A designer chefs kitchen features stone benchtops and quality stainless steel appliances with an abundance of drawers and cupboards and also the added bonus of a walk-in pantry, allowing you to be a MasterChef in the convenience of your own home.

Only an inspection will provide justice to capture all this home has to offer.

Price: \$560000



Lorraine Grassie



Adrian Triplett

For more details please visit :
<https://www.summitbunbury.com.au/4706565>

0419 971 888

Ground Floor

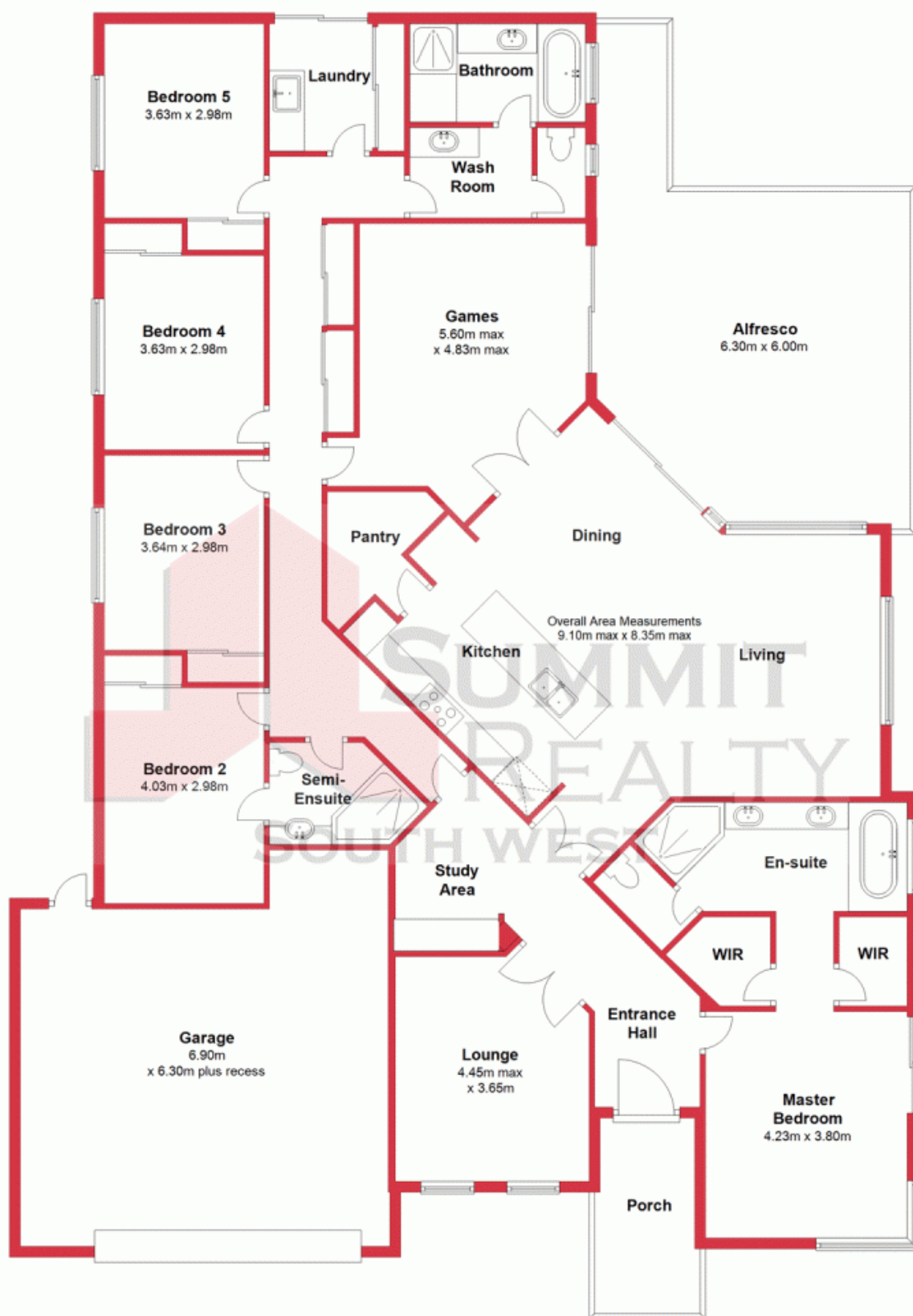

This plan has been prepared for marketing purposes only. Whilst every care is taken in the production of this plan, measurements, angles and positioning of doors/windows may not be accurate. Interested parties are strongly advised to undertake their own checks when establishing the suitability for furniture etc. Not To Scale.

Plan produced using PlanUp.

26 Henslagh Turn

26 Henslagh Turn, Australind,
Australind, WA

