



38 Lakeside Terrace Preston Beach, WA

 4
  2
  2

VIEWS VIEWS VIEWS!!!

From the upstairs balcony with views over the public golf course and beyond with the magnificent backdrop of the National Park and Preston Lake, this 2 storey holiday home is also a short drive to the sand and the sea, from dusk to dawn you will be able to enjoy all presto Beach has to offer in this Serene holiday setting!

This Practical Holiday home, includes views of the golf course and the picturesque Yalgorup National Park, is located only 1.6kms form Preston s Beach front.

The Functional design which includes both Living areas upstairs and downstairs which also includes Bathrooms on both levels makes this home perfectly set up for the large family o

For more details please visit :

<https://www.summitbunbury.com.au/4728732>

Price: \$345000



Lorraine Grassie

Ground Floor

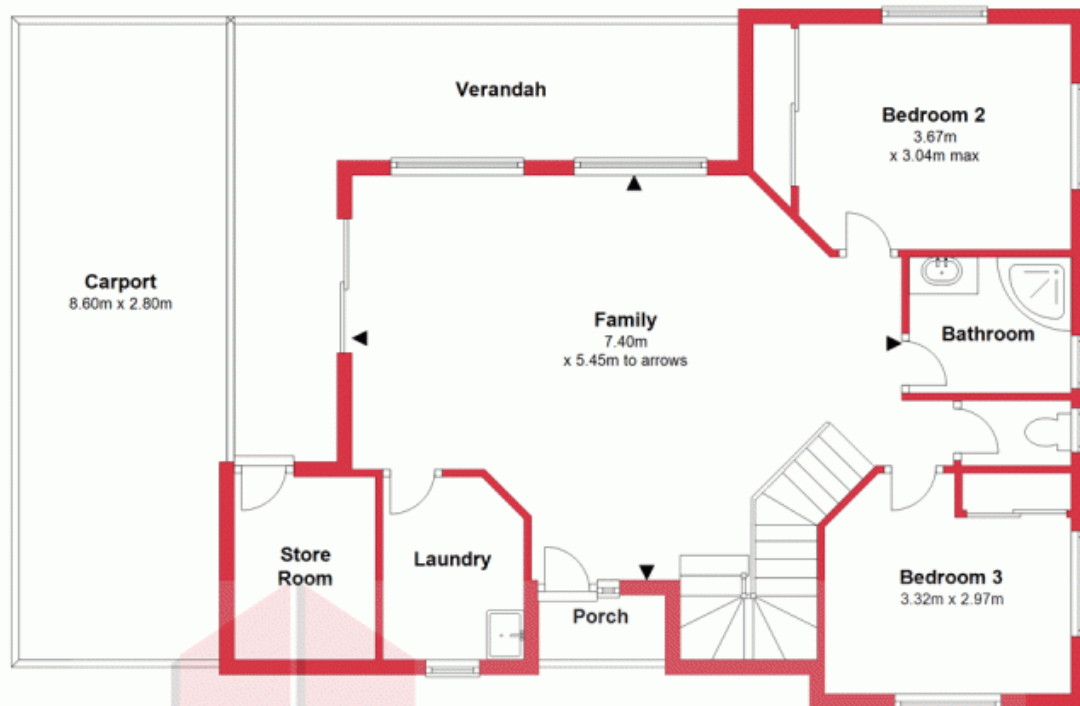

First Floor

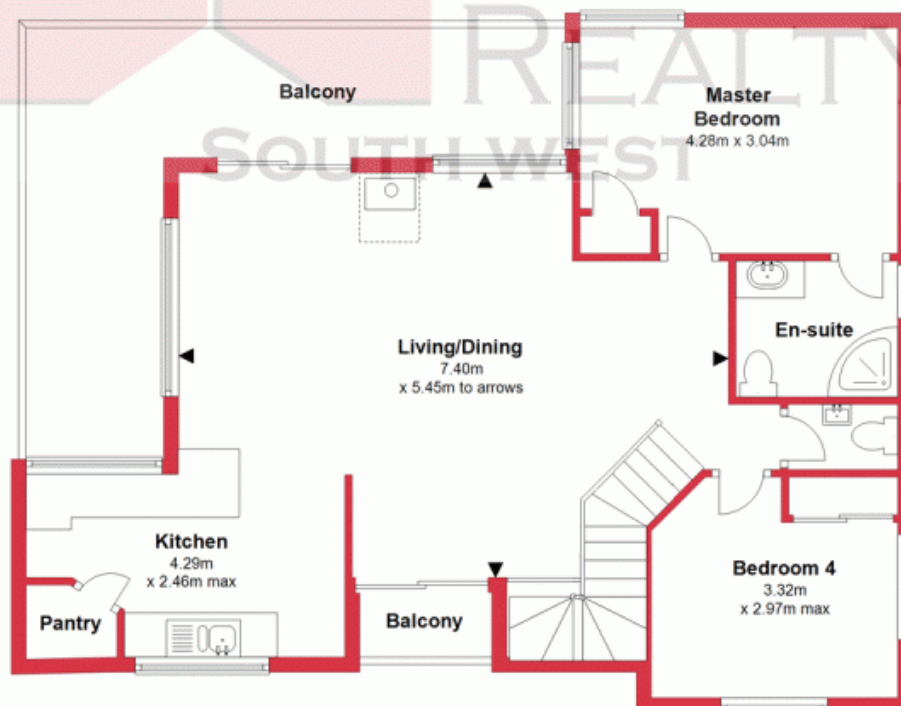

This plan has been prepared for marketing purposes only. Whilst every care is taken in the production of this plan, measurements, angles and positioning of doors/windows may not be accurate. Interested parties are strongly advised to undertake their own checks when establishing the suitability for furniture etc. Not To Scale.
Plan produced using PlanUp.

38 Lakeside Terrace

38 Lakeside Terrace, Preston Beach,
Preston Beach, WA

