



842 Clifton Road Brunswick, WA



4



2



6

Edge of Suburbia Meets Serene Rural Lifestyle

Watch the sun set over your very own piece of paradise and enjoy the best of both worlds on your 12.7 acre lifestyle property. The property is located only minutes from Australinds New Treendale Shopping Precinct and of course the New 24 hour Spud Shed. This unique property has a magnificent family home built in 2002 by a local reputable builder, which is constructed of double brick & colour-bond and has a 4x2 configuration.

Dads youre not forgotten either with a Workshop fit for a King. Room for the Boat, Caravan and still room for a workshop to create your next masterpiece.

Practicality was top of mind when they designed and built this home. Modern open plan with storage galore, apart from a corner pantry in the kitchen, directly adjacent has the biggest store room I have seen could be converted to a Butlers Kitchen or just extra pantry s

For more details please visit :

<https://www.summitbunbury.com.au/4728808>

Price: \$615000



Lorraine Grassie

Ground Floor
Approx. 201.8 sq. metres

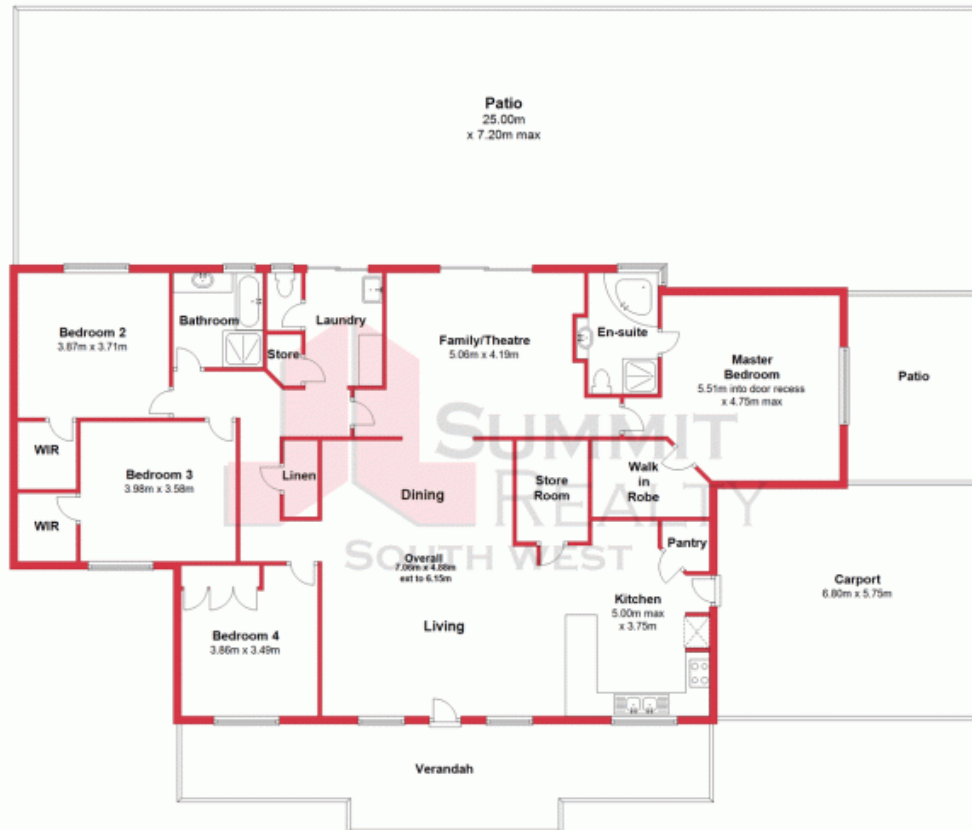

Total area: approx. 201.8 sq. metres

This plan has been prepared for marketing purposes only. Whilst every care is taken in the production of this plan, measurements, angles and positioning of doors/windows may not be accurate. Interested parties are strongly advised to undertake their own checks when establishing the suitability for furniture etc. Not To Scale.
Plan produced using PlanUp.

842 Clifton Road, Brunswick

842 Clifton Road

Brunswick, WA

