



11 Lilly Court AUSTRALIND, WA

 4
  2
  2

4 x 2 with a View

The home offers a great start to the property market or an addition to your current portfolio. This 4 bedroom 2 bathroom property is close to Primary Schools, Australind and the Treendale Shopping precincts.

Sit around the fire place with the open plan living and dining area jus off the generously appointed kitchen. Take the morning coffee out on the balcony and soak up the summer sun.

With a double garage, access to a workshop and store room and side driveway access to the rear of the home, there is room for everything.

- 770m2 block

Price: \$350000



Lorraine Grassie



Adrian Triplett

0419 971 888

For more details please visit :
<https://www.summitbunbury.com.au/4728833>

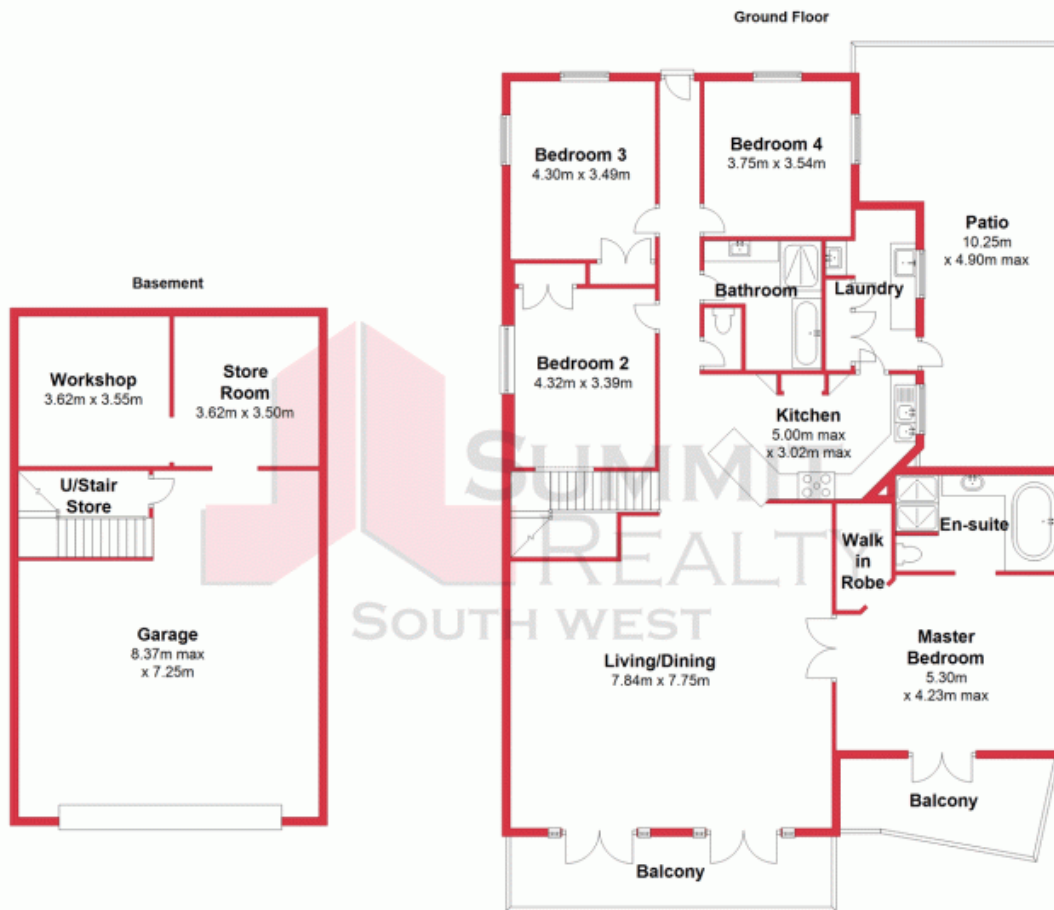

This plan has been prepared for marketing purposes only. Whilst every care is taken in the production of this plan, measurements, angles and positioning of doors/windows may not be accurate. Interested parties are strongly advised to undertake their own checks when establishing the suitability for furniture etc. Not To Scale. Plan produced using Planisp.

11 Lilly Ct, Australind

11 Lilly Court

AUSTRALIND, WA

