



3 Gilmore Street Dalyellup, WA

 4
  2
  2

EASY LIVING!

Attractively positioned nearby to both a bush corridor and green park with playground, this home holds the promise of very comfortable living for its fortunate new owners.

The front veranda stretches the full length of the homestead style property. The home sits very comfortably on a corner block and the subtle colouring of the build and style reflect its surroundings very well.

The multiple living areas mean there is space for all the family to spread out and enjoy time on their own or choose to party together.

Adding to the abundant storage already in the home, an additional attic space is a very us

For more details please visit :

<https://www.summitbunbury.com.au/4728896>

Price: Offers Above \$390,000



Lorraine Grassie

Ground Floor

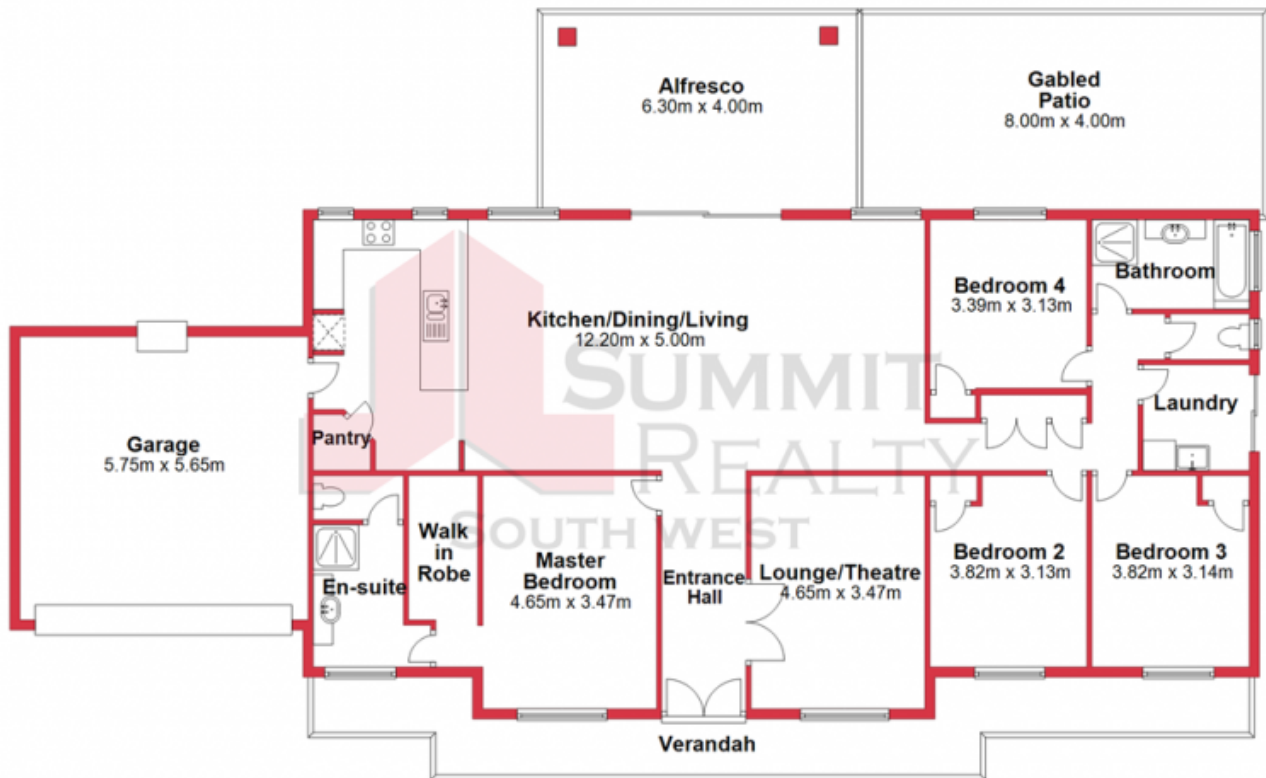

This plan has been prepared for marketing purposes only. Whilst every care is taken in the production of this plan, measurements, angles and positioning of doors/windows may not be accurate. Interested parties are strongly advised to undertake their own checks when establishing the suitability for furniture etc.
Not To Scale.
Plan produced using PlanUp.

3 Gilmore St, Dalyellup

3 Gilmore Street

Dalyellup, WA

