



4 Lewana Approach DALYELLUP, WA



4



2



2

SPACIOUS FAMILY HOME

Fantastic four bedroom, two bathroom family home located in a quiet section of the Dalyellup Beach Estate. Designed with family in mind, this home features a functional layout with multiple living areas good size bedrooms.

Positioned to the rear of the home is a spacious alfresco area perfect for outdoor entertaining and plenty of yard space for the kids to play.

Other features include:

- Four spacious bedrooms all with built in robes
- Large open plan living/dining area
- New timber look vinyl flooring throughout
- Large games room to the rear of the home

Price: \$360 per week



Lorraine Grassie

For more details please visit :
<https://www.summitbunbury.com.au/4731075>

Ground Floor

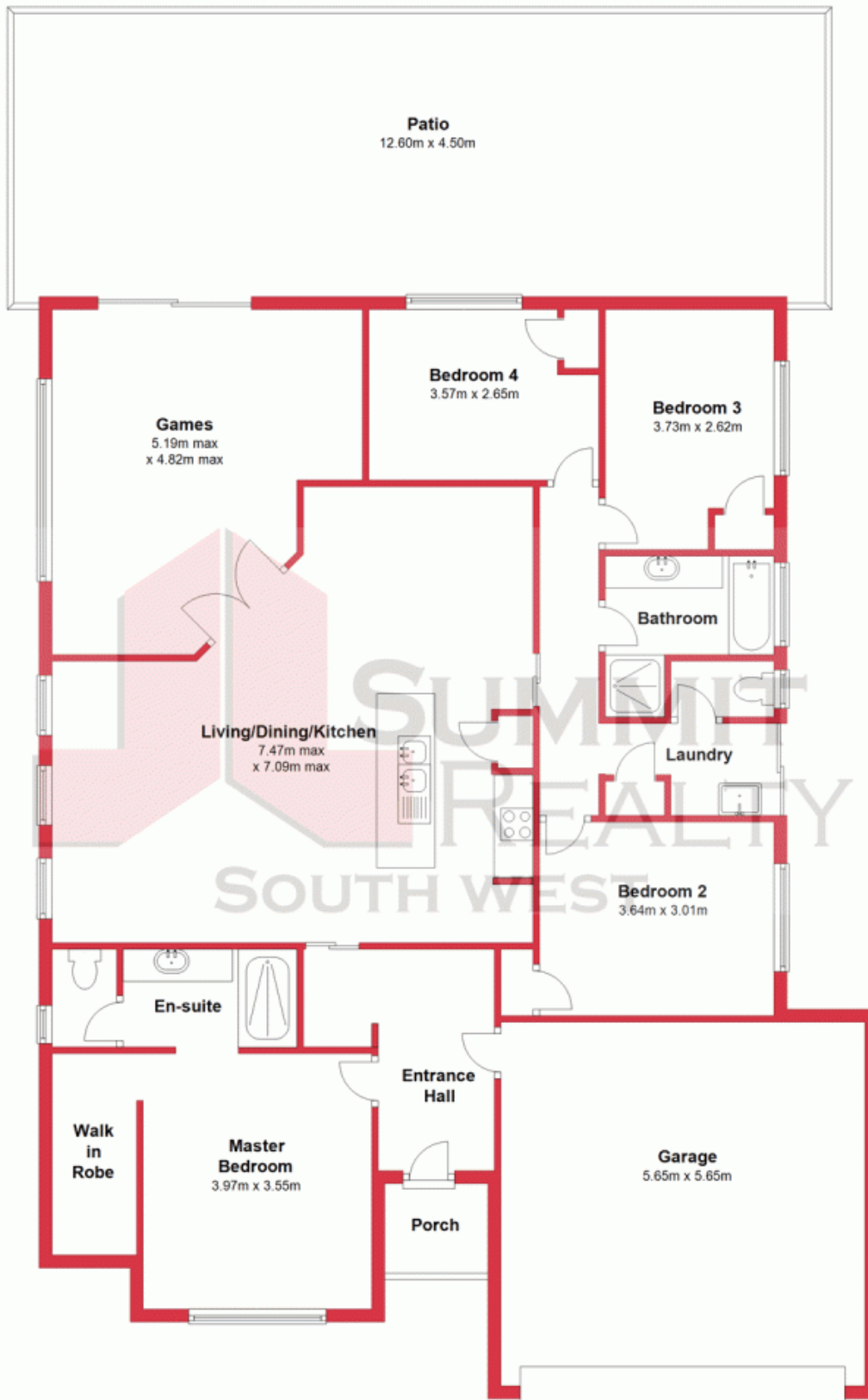

This plan has been prepared for marketing purposes only. Whilst every care is taken in the production of this plan, measurements, angles and positioning of doors/windows may not be accurate. Interested parties are strongly advised to undertake their own checks when establishing the suitability for furniture etc. Not To Scale.
Plan produced using PlanUp.

4 Lewana Approach

4 Lewana Approach, Dalvellup
DALVELLUP, WA

