

DALYELLUP, WA



4



2



2

LOCATION IS EVERYTHING

Facing parklands & in an elevated position sits this huge prestigious quality home built by Ventura & based on The Laguna design this home is a must see for family looking for space. Features are as follows:

Elevated position with landscaped gardens & feature walls

Double doors lead to grand hallway with high recessed ceiling & lights

4 bedrooms & 2 bathrooms

Dedicated study

Activity room



Lorraine Grassie

For more details please visit :

<https://www.summitbunbury.com.au/4731605>

P42-B3
ATTORNEY

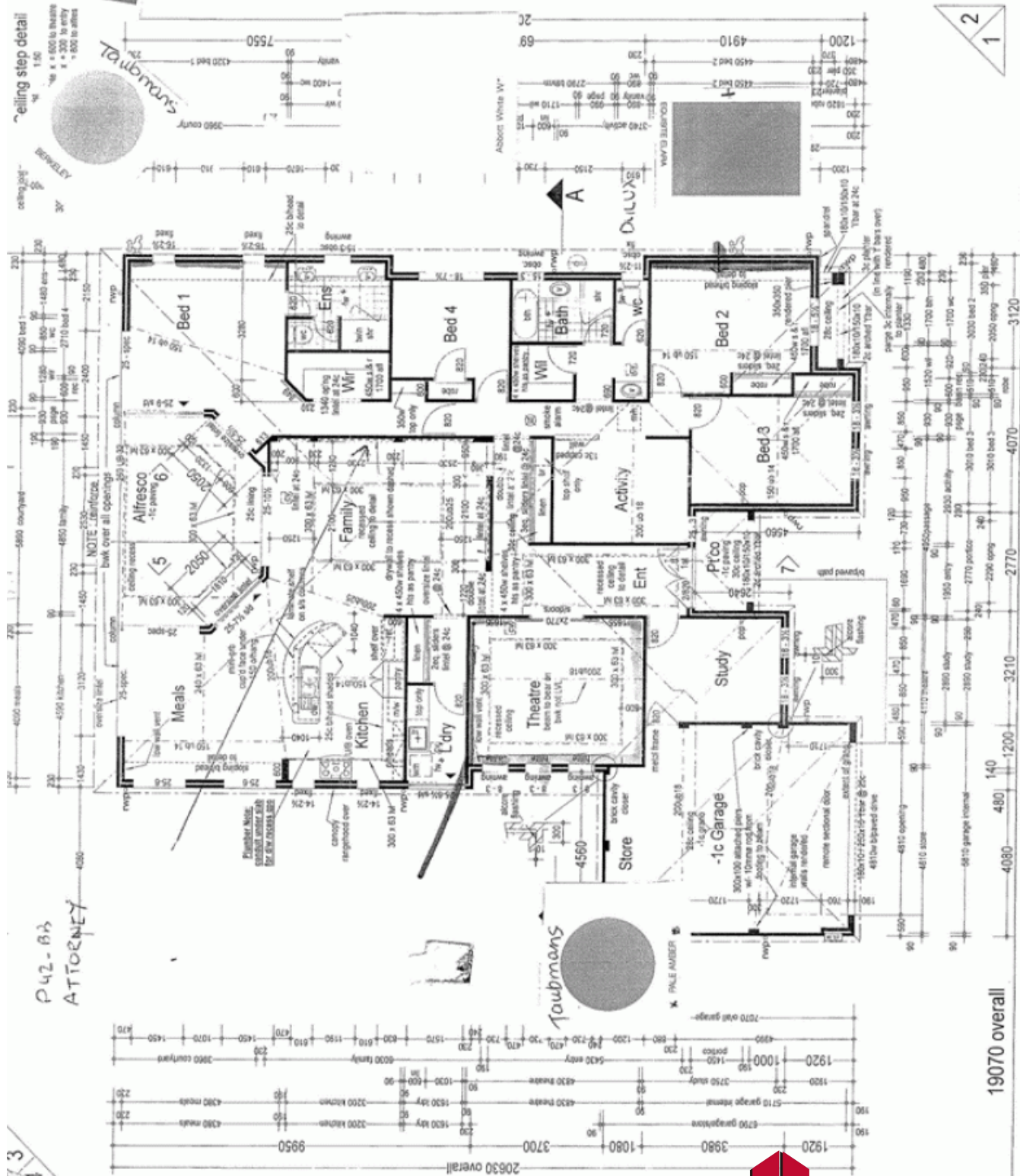

Notes
 Bedlayer Note:
 Hoop iron to be at 12004 & setdown 1200mm below plate
 Concretor Note:
 30mm setdown to tiled area
 Refer to Engineer's detail for slab & footing requirements
 Smoke alarm to comply with A.S. 3786 - 1993
 Roof Plumber Note:
 Downpipes to be positioned as per plan and to plumbers discretion.
 Impervious floor covering by owner to unfinished wet areas
 Ventura Homes reserves the right to specify an engineer designed roof truss in lieu of conventional timber roof construction
 Plumber Note:
 Floorwaste to be positioned as per plan and to plumbers discretion.

Clients 1: _____
 Signature 2: _____
 Witness _____
 Date _____
 Area: 246.95m² Garage: 39.56m²
 perim: 4.45m Portico: 4.54m²
 Alfresco: 21.22m² Painter: 1.90m²
 Roof: 336.22m²
 Drawn: _____
 Date: _____
 MFB: 09/09/03 contract
 Jan No: 230480 Sheet: 2 of 7
 © Copyright Ventura Homes
 ADDRESS:
 Lot 1756, Wentworth Avenue,
 Dalyellup.

DALYELLUP, WA

