



8 Sepia Approach DALYELLUP, WA



4



2



2

OCEANSIDE PACKAGE

What an opportunity to move into Dalyellup Oceanside

Price: \$423,000

- 4 Bedrooms all with robes
- Front office
- Activity room
- Theatre room
- Open plan kitchen, dining and family room with a split reverse cycle air-conditioner
- Paved Alfresco
- Auto retic lawns and garden
- Double auto garage

For more details on this exclusive listing call Gillian Trench on 0419 196 740



Lorraine Grassie

For more details please visit :
<https://www.summitbunbury.com.au/4732207>

Ground floor		
Location	Area (m ²)	Price (\$/m ²)
ALFRESCO	15,680	11,020
GARAGE	36,640	21,350
HOUSE	178,610	51,960
PORCH 1	0,800	220
PORCH 2	1,250	5,120
	232,980	101,680

ROOF AREA (ON FLAT) = 257.57m²

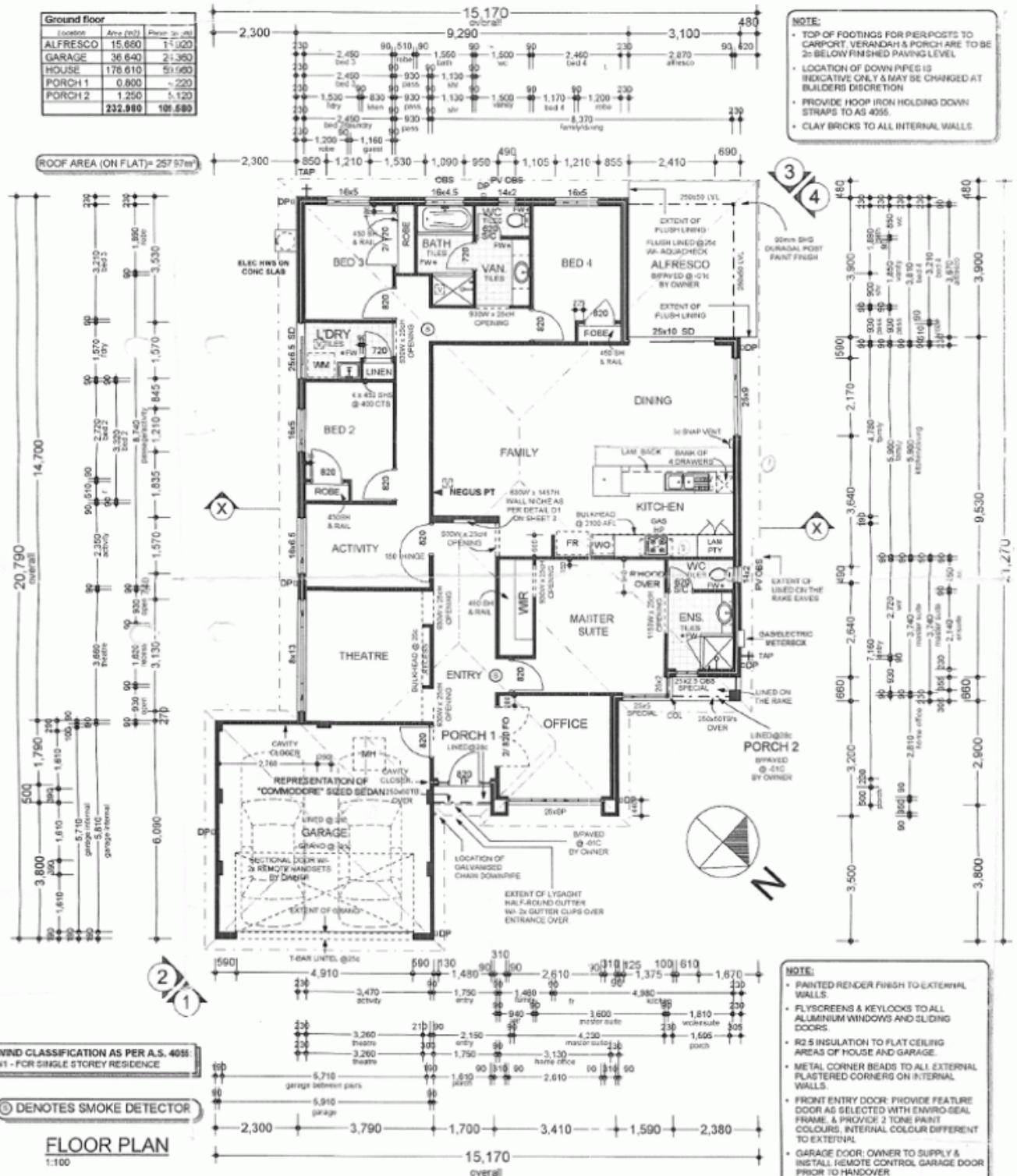

8 Sepia Approach

DALYELLUP, WA

