



9 Taylorhill Road AUSTRALIND, WA

 4
  2
  3

## Spoil Your Family

Galway Green is the perfect location for busy, young families and this large family home has something for all the family.

Built in 2007, the home is north facing with views from the front portico across to the Darling Range. Inside, you will find a well proportioned home. The master suite is at the front of the home with large double walk through robes and a large ensuite with fully screened shower, vanity, corner bath & separate toilet.

Adjacent to the master bedroom, behind double glass doors is the theatre room, complete with high ceilings & double blinds.

The combined kitchen, dining area and living room make up the largest room in the house. The functional galley style kitchen is finished in crisp white with dark grey granite look benchtops. It has a dishwasher, stainless steel rangehood and stove, double sink, fridge r

For more details please visit :

<https://www.summitbunbury.com.au/4732446>

**Price:** OFFERS OVER \$499,000



**Ruth Nandapi**

0419 955 965



**SUPERVISOR NOTE**  
CONTRACT

**NI WIND CLASSIFICATION**

SC1 - 100x50x3 RHS  
Refer to engs detail  
GP204 for info

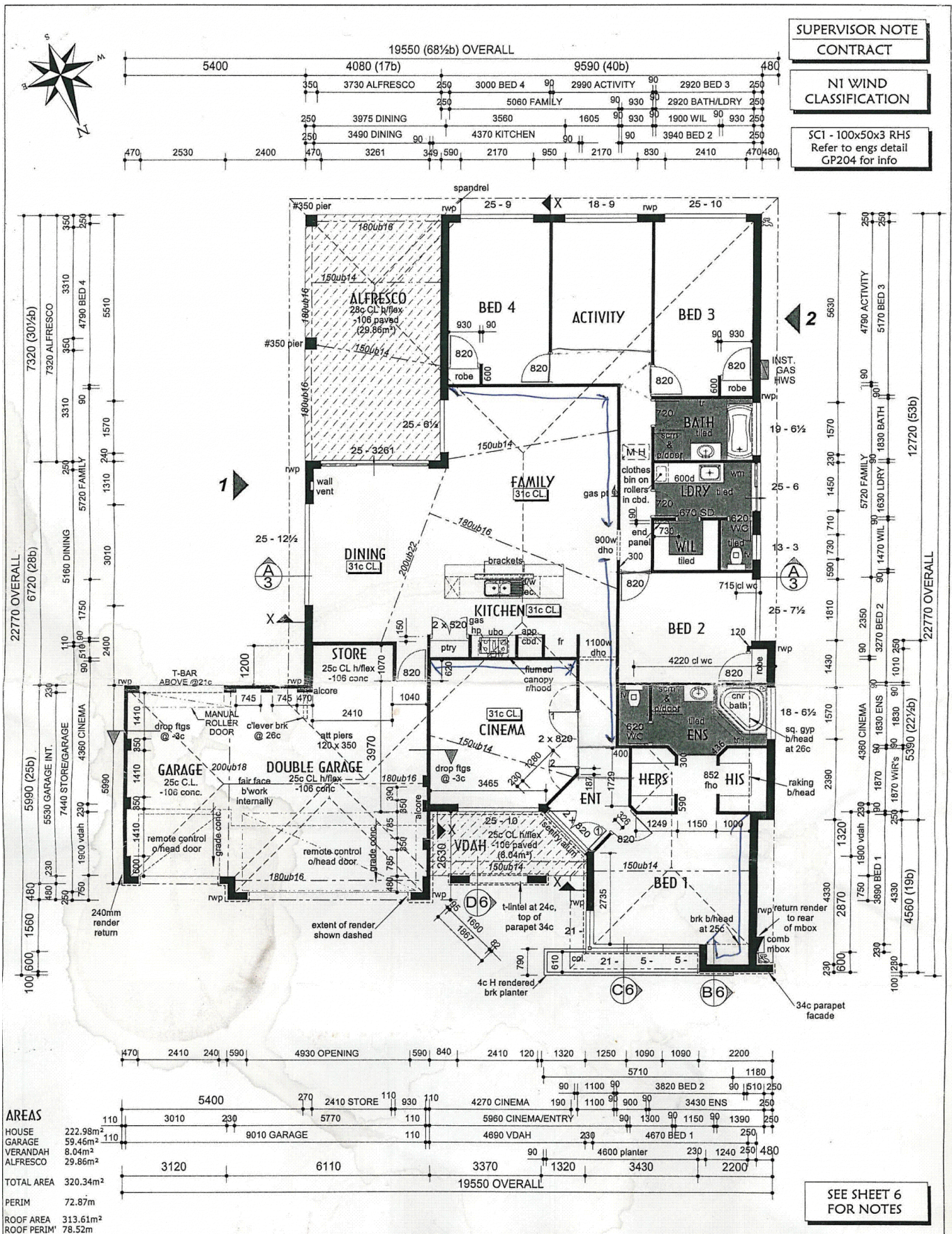

9 Taylorhill Road

AUSTRALIND, WA

**SUMMIT REALTY**  
SOUTH WEST

PROPOSED RESIDENCE TO BE ERECTED ON -  
LOT 303 TAYLORHILL ROAD,  
GALWAY GREEN, LESCHENAULT.

This is one of the Drawings  
Referred to in our Contracts  
Builder *Spec*

AMENDMENT  
09/10 CONTRACT AC

DRAWN - AC  
DATE - 09/10/06  
SCALE - 1 : 100