



47A Eulalia Street CAREY PARK, WA



2



1



1

Wise Investment or First Home

Do yourself a favour and take a look at this lovely low maintenance duplex half situated in Crosslands in Carey Park.

Perfect for first home buyers or the astute investor, it's within close proximity to many of Bunbury's amenities and is well worth an inspection.

Features include:

- 2 Bedrooms
- 1 Bathroom
- Separate kitchen
- Lounge and dining
- Freshly painted and new carpets
- Large outdoor patio area
- Single carport

Located only a short stroll down to the Parks Centre and only moments away from the Southw

For more details please visit :

<https://www.summitbunbury.com.au/4733176>

Price: \$189,000



Tracy Mills

0429 000 887

Ground Floor

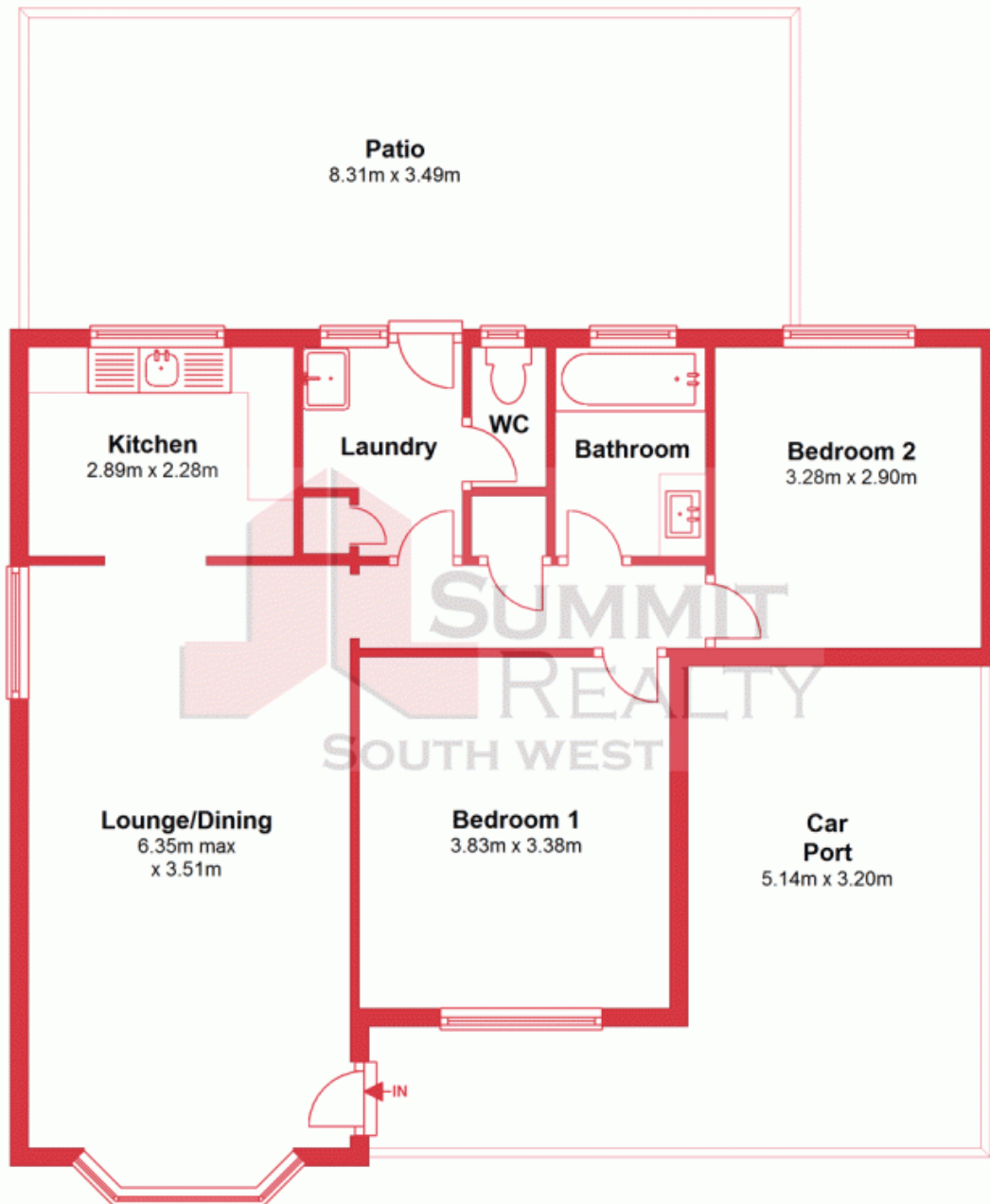

This plan has been prepared for marketing purposes only. Whilst every care is taken in the production of this plan, measurements, angles and positioning of doors/windows may not be accurate. Interested parties are strongly advised to undertake their own checks when establishing the suitability for furniture etc. Not To Scale.
Plan produced using PlanUp.

47A Eulalia Street

47a Eulalia Street, Bunbury
CAREY PARK, WA

