



23 Greensill Crescent AUSTRALIND, WA



4



2



2

Massive Shed - Ripper Buy!

Brick and tile home in Australind sitting on a 742m2 block which just needs a little TLC. Located conveniently close to schools, parks, shops and the Brunswick River.

So many great features to mention but the big ticket item is the massive shed! 9m x 5m workshop, perfect for the handy man or car enthusiast, or convert to a man cave!

This home has great street appeal with an easy care front yard and a secure screen door. Double garage and side access.

The big master bedroom has a walk in robe and an ensuite.

Price: \$318,000



Lorraine Grassie

For more details please visit :
<https://www.summitbunbury.com.au/4733191>

Ground Floor

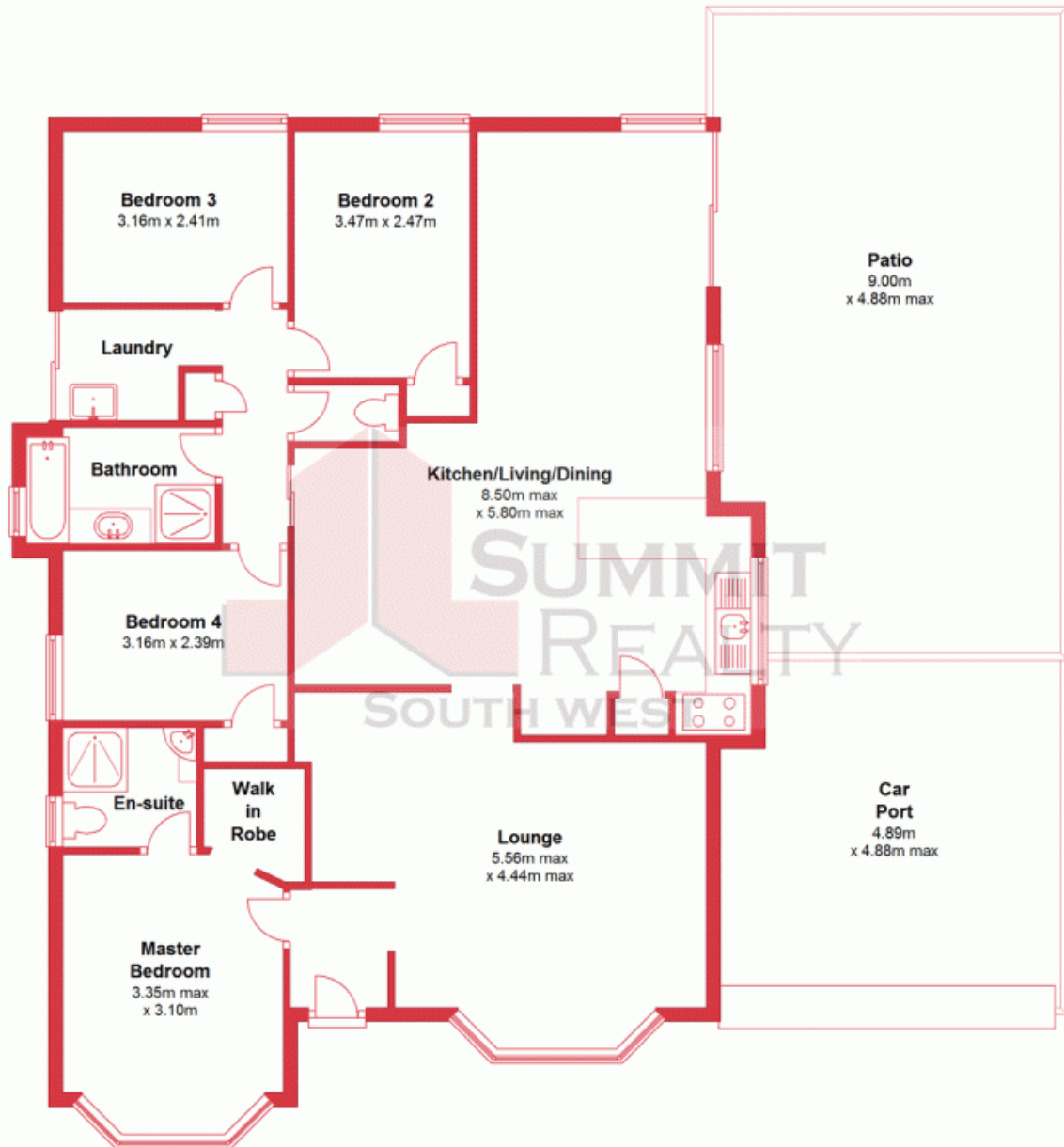

This plan has been prepared for marketing purposes only. Whilst every care is taken in the production of this plan, measurements, angles and positioning of doors/windows may not be accurate. Interested parties are strongly advised to undertake their own checks when establishing the suitability for furniture etc. Not To Scale.
Plan produced using PlanUp.

23 Greensill Crescent

23 Greensill Crescent, Australind
AUSTRALIND, WA

