



21-23 Heppingstone Road BRUNSWICK, WA



2



1

Just add the white picket fence!

From the moment you step through the front door you will be captivated by this home and it's potential, with it's stunning high ornate ceilings, large rooms and an old-world charm and ambiance which cannot be replicated today...

Just waiting for someone to bring it to it's full potential, it's the perfect opportunity for an astute renovator or someone looking to purchase a great first home on a large block.

Features include:

- 2 Bedrooms & 1 Bathroom
- Featuring wood dados throughout the home
- Beautiful wood fire
- Country-style kitchen

For more details please visit :

<https://www.summitbunbury.com.au/4733197>



Tracy Mills

0429 000 887

Ground Floor

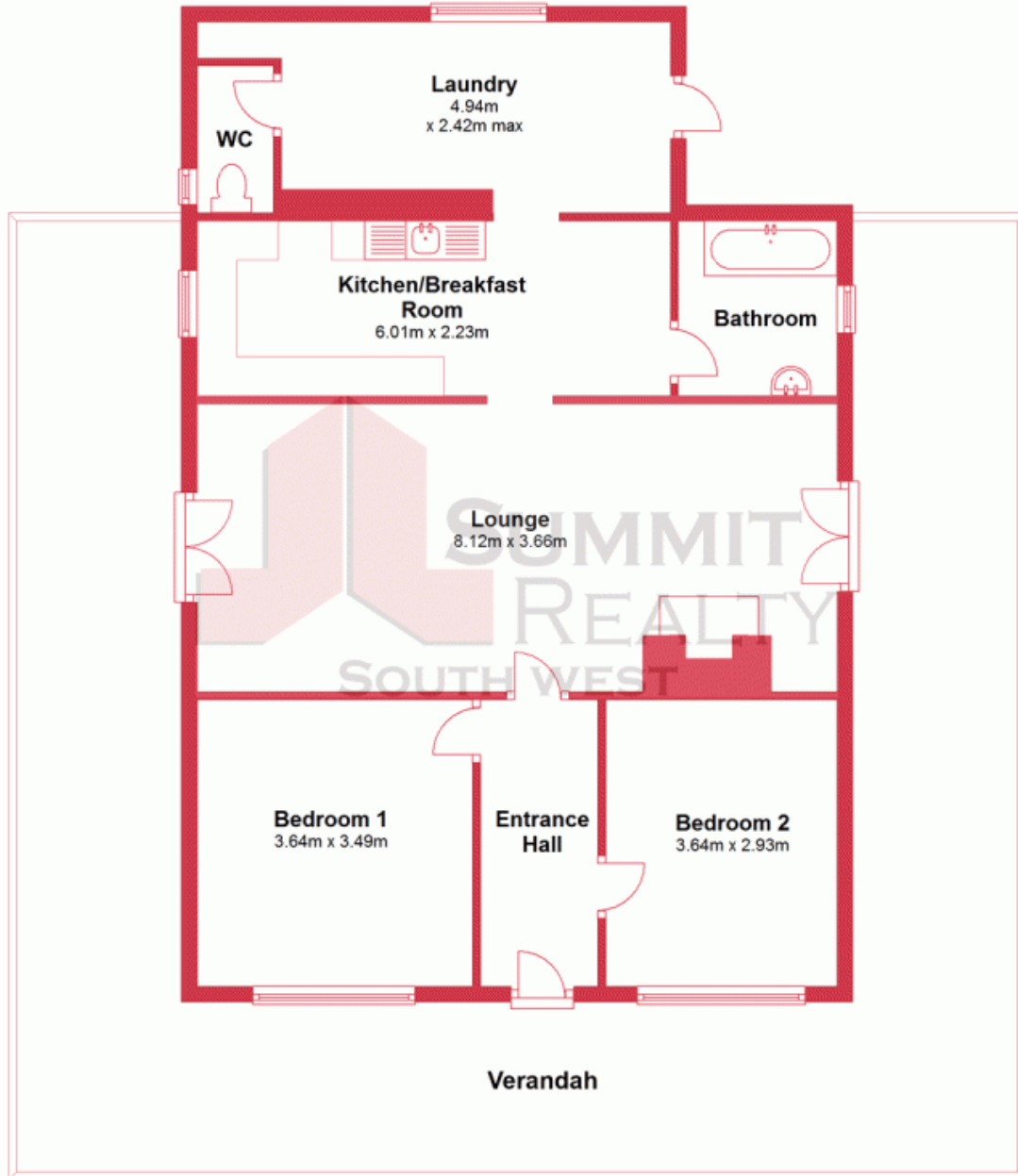

This plan has been prepared for marketing purposes only. Whilst every care is taken in the production of this plan, measurements, angles and positioning of doors/windows may not be accurate. Interested parties are strongly advised to undertake their own checks when establishing the suitability for furniture etc. Not To Scale.

Plan produced using PlanUp.

21-23 Heppingstone Road BRUNSWICK, WA

