



34 Apsley Circle MILLBRIDGE, WA



SHOW STOPPER!

If you are looking for a stylish, modern family home located in a quiet street in Millbridge, then you need to look at this property!

Situated on a 727m² block on a quiet street this stunning 4 bedroom 2 bathroom home recently built in 2011 by Summit Homes. Located close to sporting facilities, shops and parks in the heart of Millbridge.

Stylish modern front exterior, full reticulated manicured lawn and gardens. Side access for vehicles to access the shed.

Price: \$529,000



Lorraine Grassie

A glamorous feel to the big master bedroom with luxe carpets and bulk head about the bed w

For more details please visit :
<https://www.summitbunbury.com.au/4733273>

Ground Floor

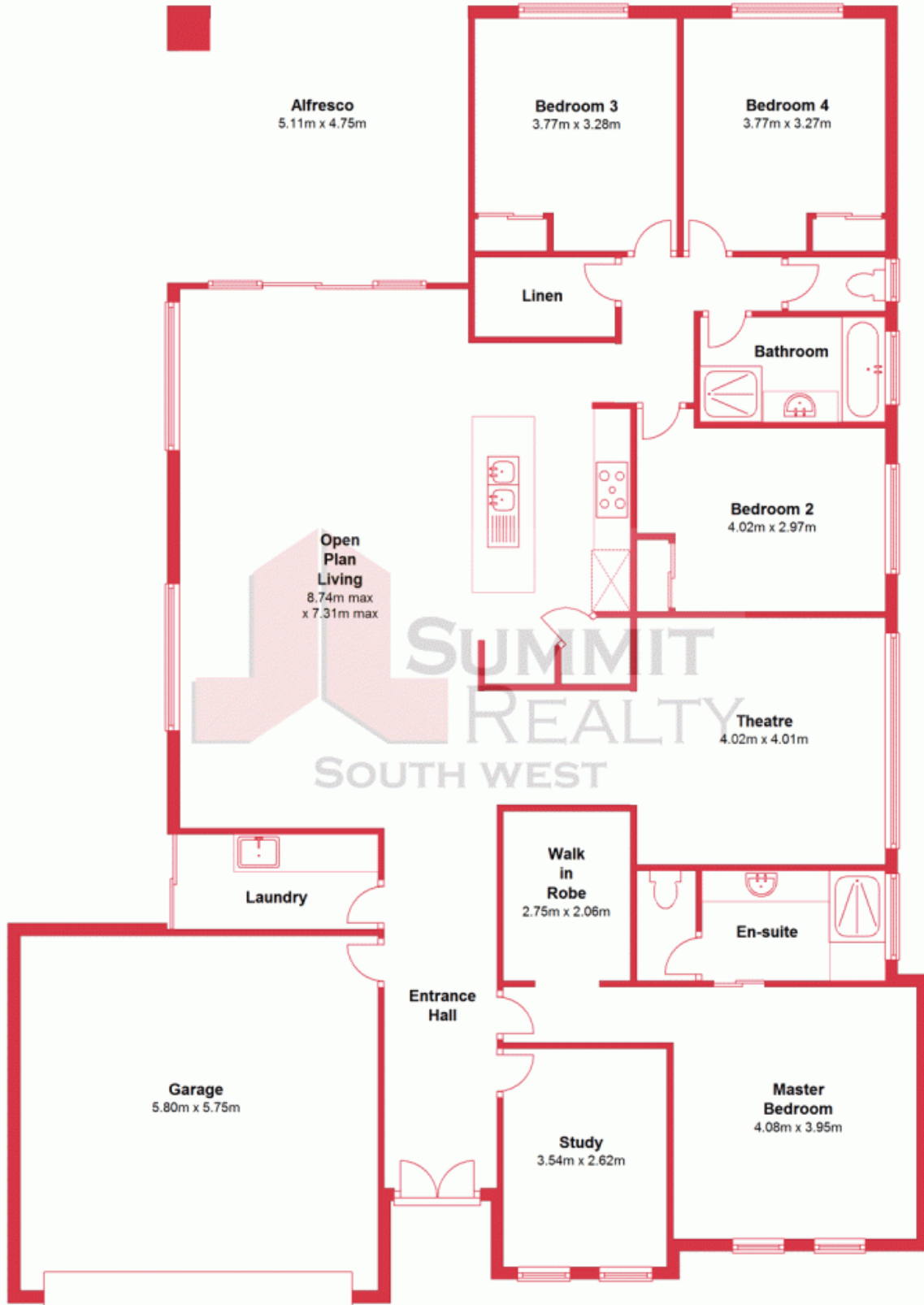

This plan has been prepared for marketing purposes only. Whilst every care is taken in the production of this plan, measurements, angles and positioning of doors/windows may not be accurate. Interested parties are strongly advised to undertake their own checks when establishing the suitability for furniture etc. Not To Scale.
Plan produced using PlanUp.

34 Apsley Circle

34 Apsley Circle, Millbridge
MILLBRIDGE, WA

