



2/14 Sinclair Close BUNBURY, WA

 3

 2

 2

CITY SANCTUARY

Every day is a holiday when it comes to this magnificent home located in the highly desirable Marlston Hill offering beautiful views of the Leschenault Inlet and green hills in the distance.

With 3 bedrooms, 2 bathrooms, a large living area, kitchen and dining plus balcony, enjoy the spaciousness and city style living along with the professional freshly painted walls and new carpet throughout.

Let the relaxation continue with a spot of shopping and a magnificent lunch in the cafe strip followed by a wonderful dinner at one of the many award winning restaurants close by.

Features Include:
3 large bedrooms

Price: Offers Over \$449,000



Lorraine Grassie

For more details please visit :
<https://www.summitbunbury.com.au/4733279>

Ground Floor

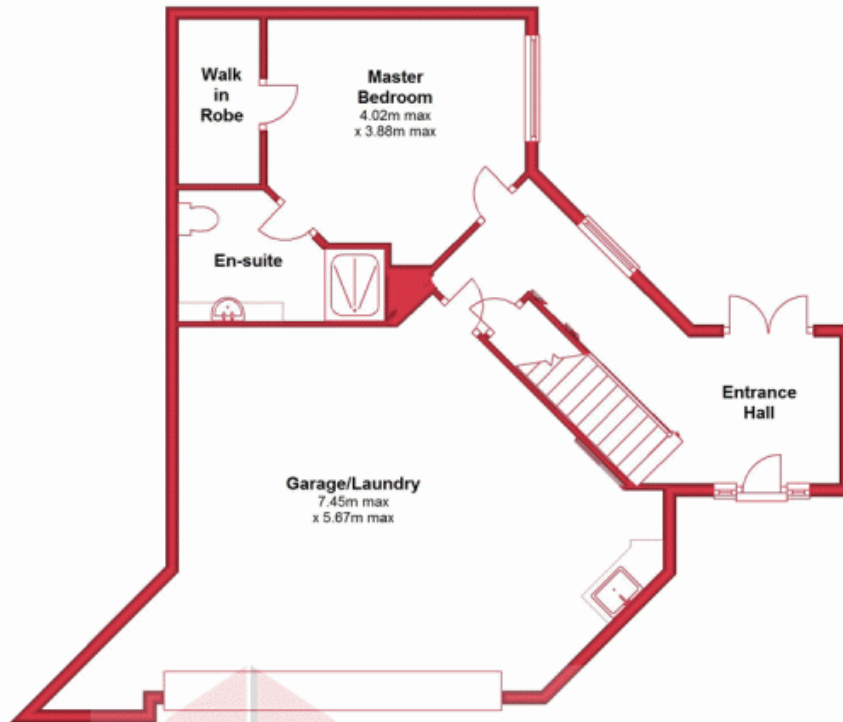

First Floor

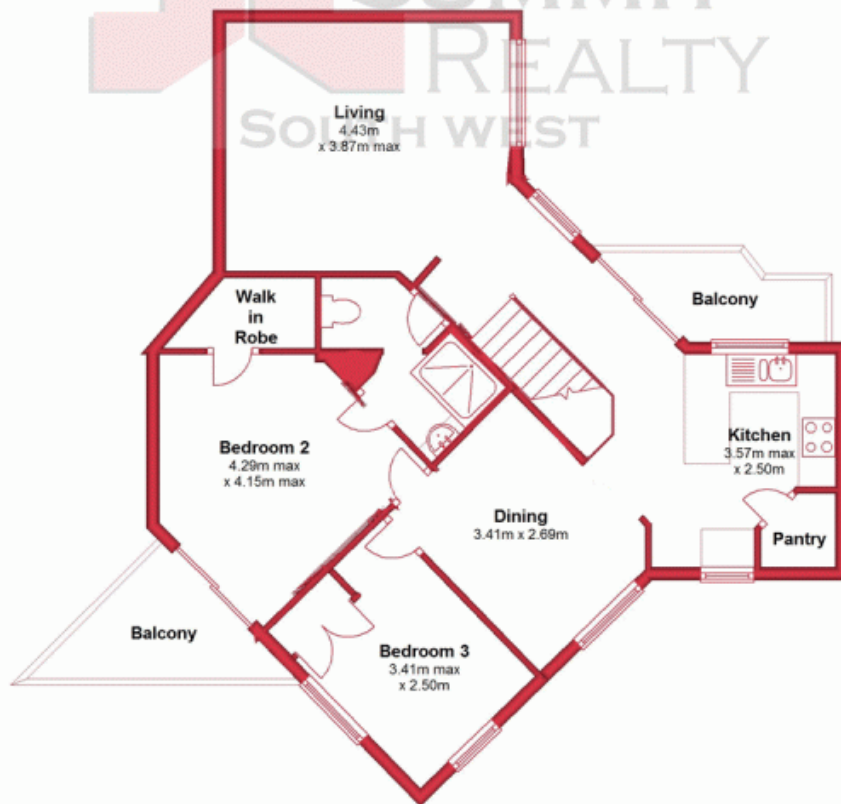

This plan has been prepared for marketing purposes only. Whilst every care is taken in the production of this plan, measurements, angles and positioning of doors/windows may not be accurate. Interested parties are strongly advised to undertake their own checks when establishing the suitability for furniture etc. Not to be used for legal purposes. Plan produced using PlanUp.

2/14 Sinclair Close

2/14 Sinclair Close, Bunbury

BUNBURY, WA

