

11 Gregory Street SOUTH BUNBURY, WA



4



2



2

South Bunbury Gem

So much to appreciate for both the super South Bunbury location as well as subdivision potential (STCA) of this fabulous 1114m2 block.

This 1948 character home oozes appeal with high ceilings and timber floors throughout.

This large home features open plan style living overlooked by the renovated kitchen.

High ceilings and timber floorboards accentuate quality from a bygone era.

Includes four double bedrooms and a study which could be used as a 5th bedroom. The Master

For more details please visit :

<https://www.summitbunbury.com.au/4733283>

Price:

Offers Over \$469,000



Lorraine Grassie

Ground Floor

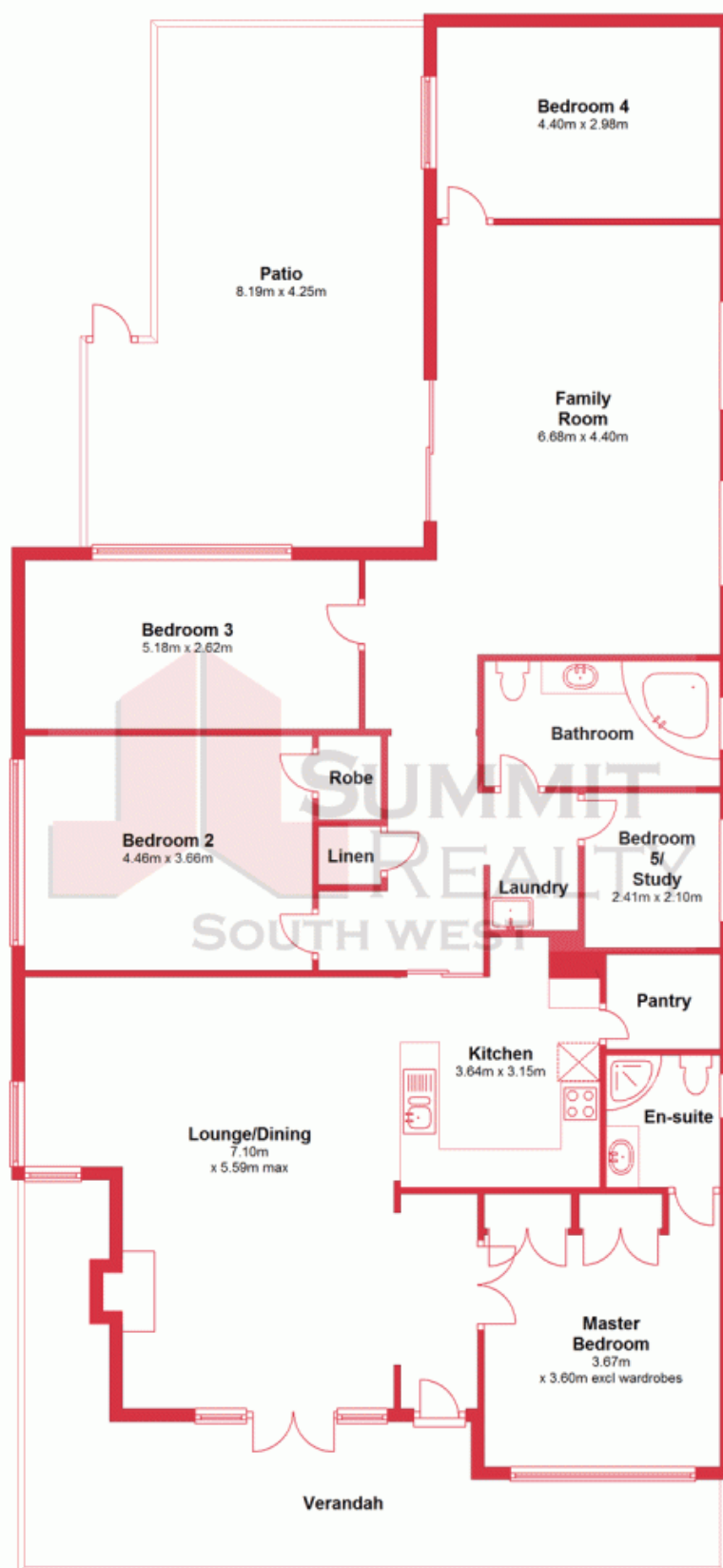

This plan has been prepared for marketing purposes only. Whilst every care is taken in the production of this plan, measurements, angles and positioning of doors/windows may not be accurate. Interested parties are strongly advised to undertake their own checks when establishing the suitability for furniture etc. Not a contract. Plan produced using PlanUp.

11 Gregory Street

11 Gregory Street, Bunbury,
SOUTH BUNBURY, WA

