



36 Lakeside Terrace PRESTON BEACH, WA

 4
  2
  2

Preston Paradise Views, Views and plenty of Roo's

From the balcony to the golf course, close to the sand and the sea, from dusk to dawn - your daily life has a holiday setting!

This superb home, with views of the golf course and the picturesque Yalgorup National Park, is located only 1.6kms from Prestons Beach front. Make your life complete by living in this beautiful 4 bedroom, 2 bathroom family home on 695 sqm. This 8 year old home has all the features necessary to make your life safe and comfortable from the roller shutters on all the windows to the reverse cycle air conditioning in the living areas.

There is a door from the extra large garage directly to the entry hall which leads to the spacious, open plan living area which has uninterrupted views over the golf course to the

For more details please visit :

<https://www.summitbunbury.com.au/4733293>

Price: \$549,000



Lorraine Grassie

Ground Floor

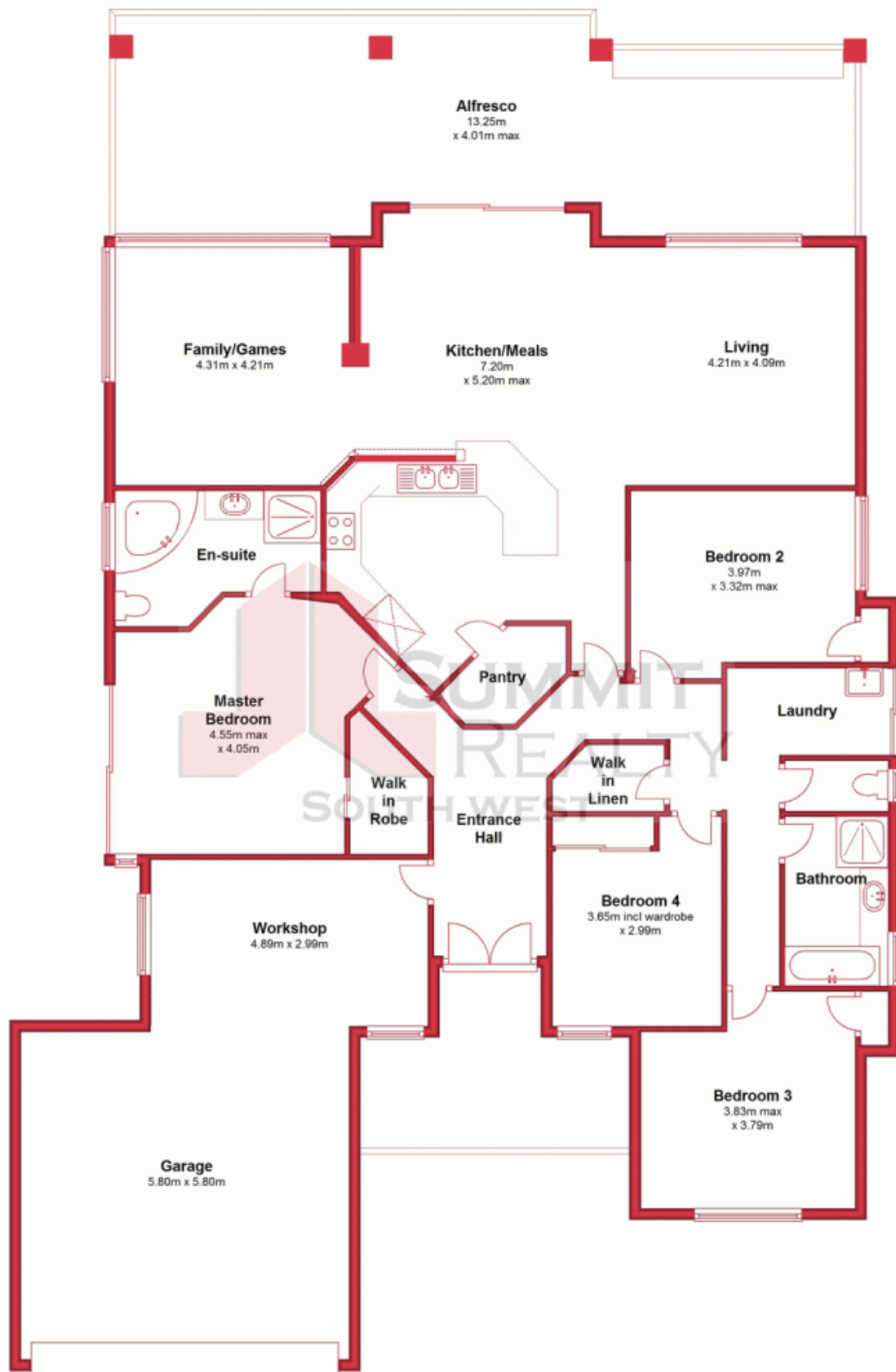

This plan has been prepared for marketing purposes only. Whilst every care is taken in the production of this plan, measurements, angles and positioning of doors/windows may not be accurate. Interested parties are strongly advised to undertake their own checks when establishing the suitability for furniture etc. Not a contract. Plan produced using PlanUp.

36 Lakeside Terrace

36 Lakeside Terrace, Preston Beach
PRESTON BEACH, WA

