



7A Thomas Street BUNBURY, WA

 2
  1
  3

A REAL SURPRISE

Step into your own slice of paradise with the lush tropical feel gardens that this home boasts. Relax in the large private outdoor entertaining area and take in the beauty of your surrounds.

Situated on a 357m2 block and built in 1998, this property has ample storage options with a garden shed, store room, room for at least 3 additional off street parking spaces- including a garage with roller door and rear access to the property perfect for parking up a trailer, caravan or boat.

To help cut costs, this property has 6 solar panels and fully reticulated gardens including raised veggie / herb patches which have the option of either bore water or scheme water. This well thought out property would be ideal for those wanting to be close to a loved on

For more details please visit :
<https://www.summitbunbury.com.au/4733303>

Price: Offers Over \$300,000



Lorraine Grassie

Ground Floor

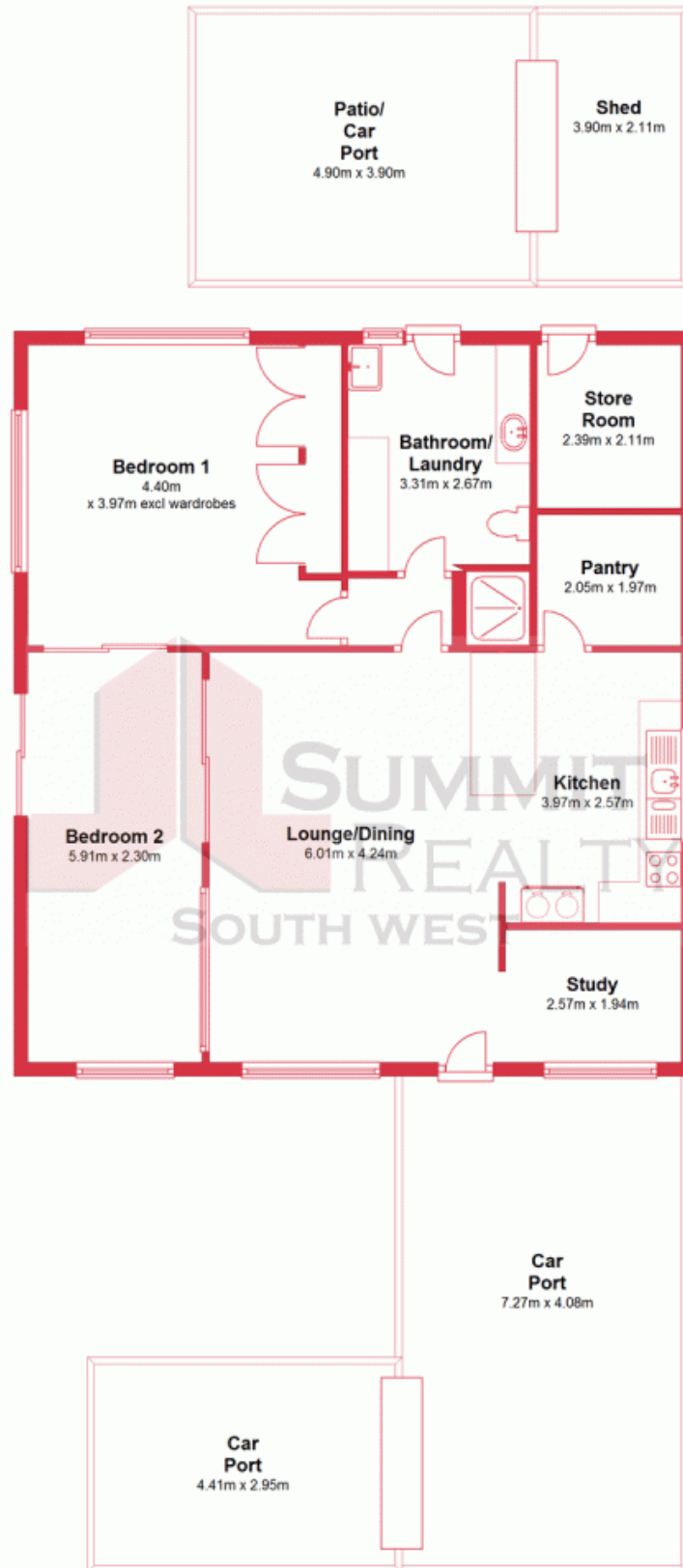

This plan has been prepared for marketing purposes only. Whilst every care is taken in the production of this plan, measurements, angles and positioning of doors/windows may not be accurate. Interested parties are strongly advised to undertake their own checks when establishing the suitability for furniture. Not To Scale.
Plan produced using PlanUp.

7A Thomas Street

7a Thomas Street, East Bunbury
BUNBURY, WA

