



7 Charolais Mews EATON, WA

 4
  2
  2

The Full Package

This simply stunning home is presented to impress a range of buyers! Built in 2007 this tastefully designed 4x2 home is perfect for a growing family.

Set in the peaceful Eaton, located opposite the Collie River nestled on a decent 762sqm block. This modern and spacious home is all about the living space. The light and bright open plan living, dining and kitchen areas are perfect for entertaining. With an activity room, which could be used as a 5th bedroom, as well as study or home office this home really caters for all members of the family.

The home features bamboo flooring which flows throughout main living areas. The spacious and secluded master suite includes a fabulous walk in robe featuring built in shelving and drawers, coupled with a beautiful ensuite with his and hers vanity, large corner spa and s

For more details please visit :
<https://www.summitbunbury.com.au/4733335>

Price: Offers Over \$600,000



Lorraine Grassie

Ground Floor

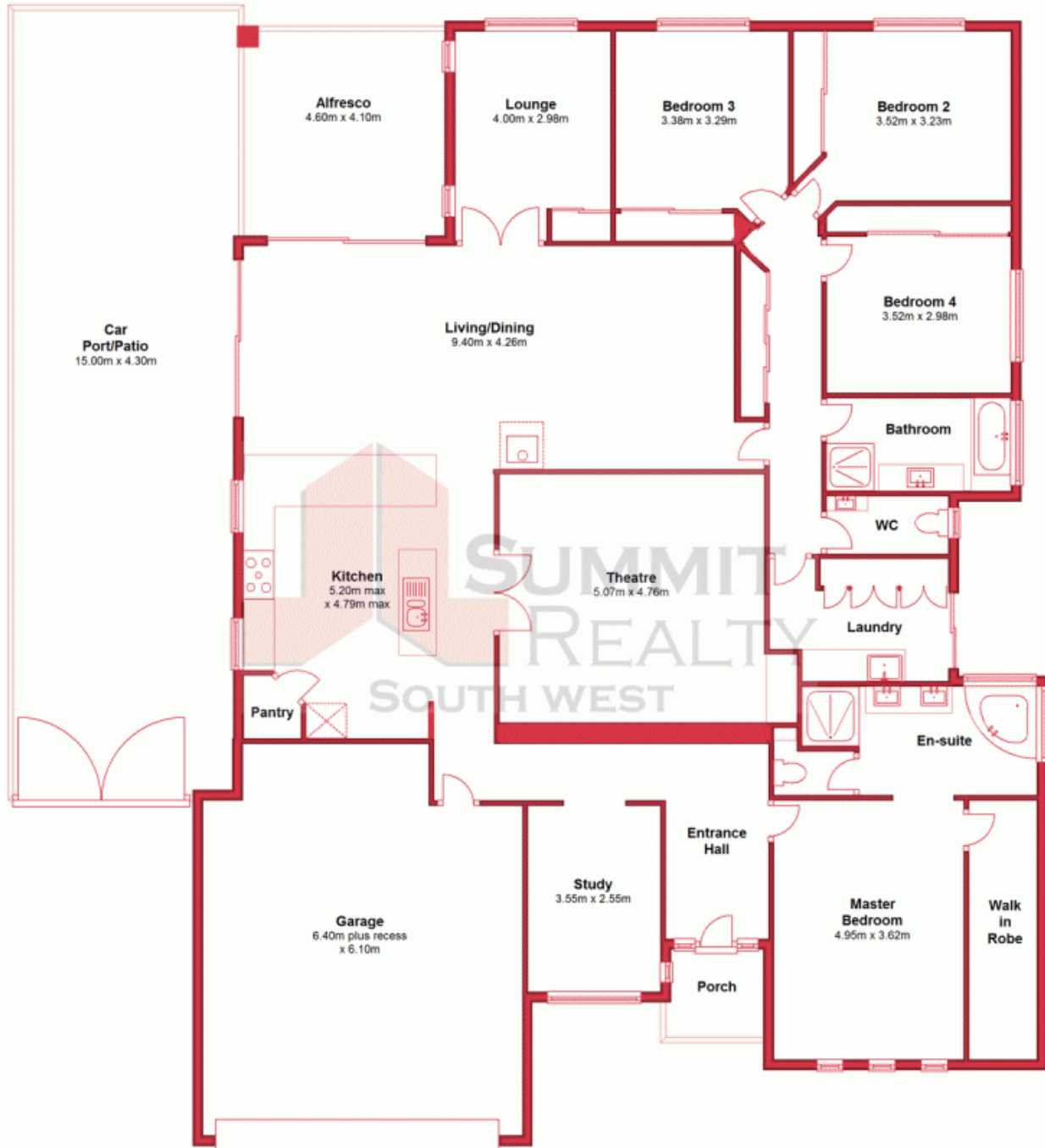

This plan has been prepared for marketing purposes only. Whilst every care is taken in the production of this plan, measurements, angles and positioning of doors/windows may not be accurate. Interested parties are strongly advised to undertake their own checks when establishing the suitability for furniture etc. Not to be used for legal purposes. Plan produced using PlanUp.

7 Charolais Mews

EATON, WA

