



1/12 Clifton Street BUNBURY, WA



IT'S ALL ABOUT LOCATION!

Perfect for the investor, first home buyer or professional couple looking to live in the CBD, this low maintenance 2 storey unit is located in a prime position only 100m from Bunbury's prestigious back beach and within walking distance to the town centre.

Featuring 2 Bedrooms, 1 Bathroom and the conveniences of 2 toilets, this unit also has plenty of room to move with the open plan living/meals and kitchen area.

The bedrooms are located upstairs and both have built in robes and easy access to the bathroom.

There is access to a courtyard and a single carport for parking.

Property Code: 6554

For more details please visit :
<https://www.summitbunbury.com.au/4733336>

Price: From \$319,000



Tracy Mills

0429 000 887

Ground Floor

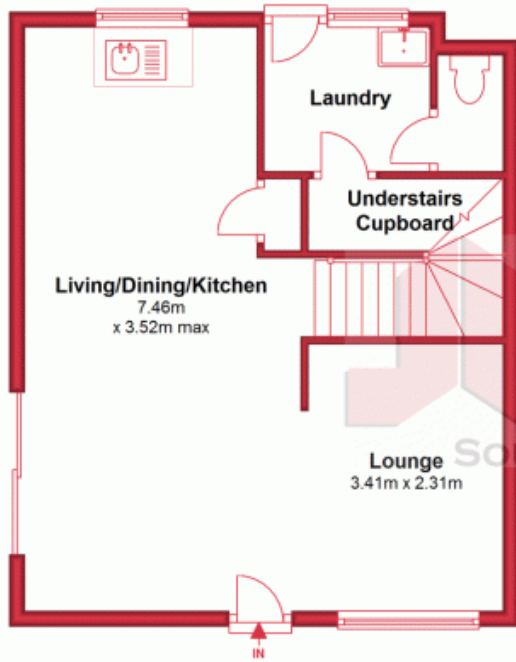

First Floor

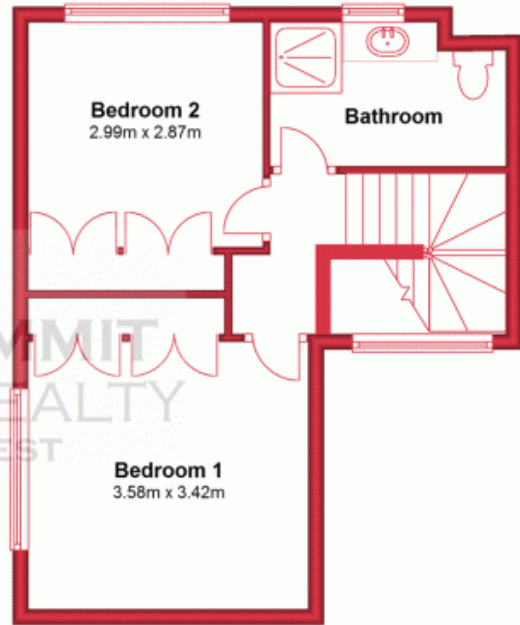

SUMMIT
REALTY
SOUTH WEST

This plan has been prepared for marketing purposes only. Whilst every care is taken in the production of this plan, measurements, angles and positioning of doors/windows may not be accurate. Interested parties are strongly advised to undertake their own checks when establishing the suitability for furniture etc. Not To Scale.

Plan produced using PlanUp.

1/12 Clifton Street, Bunbury