



16 Wollaston Crescent EAST BUNBURY, WA



STOP THROWING YOUR MONEY AWAY ON RENT!

Located in a quiet pocket of East Bunbury and just a short stroll to local schools and shops is this neat and tidy three bedroom, one bathroom brick and tile home.

Perfect for the astute investor or those looking to enter the property market, this home represents fantastic value for money and is well worth your inspection.

Features include:

- 3 Spacious bedrooms
- Recently renovated kitchen with stainless steel appliances, ample bench space and combined meals area
- Front entry which flows through to a comfortable lounge area
- Currently rented at \$270 p/week

For more details please visit :

<https://www.summitbunbury.com.au/4733341>

Price:

From \$219,000



Tracy Mills

0429 000 887

Ground Floor

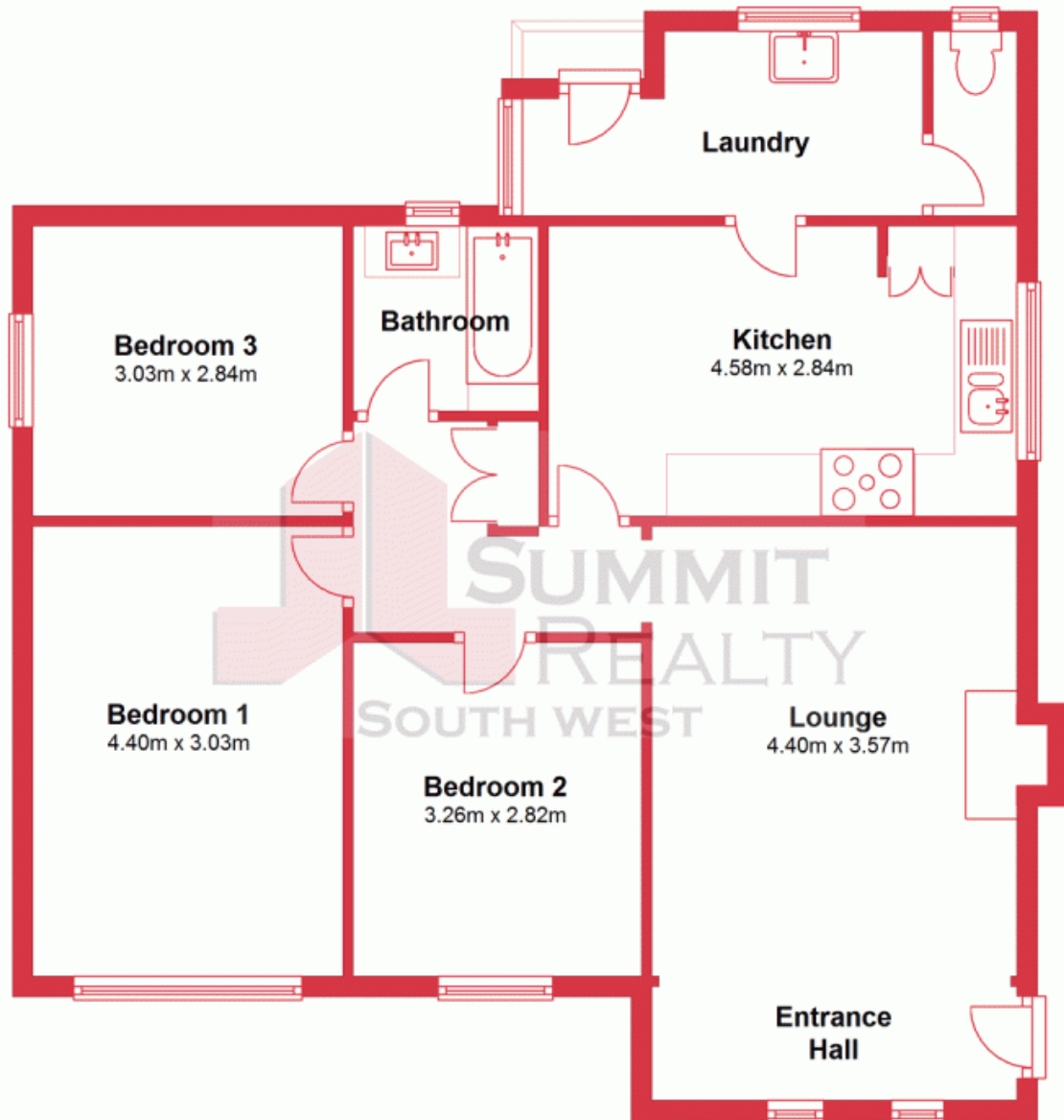

This plan has been prepared for marketing purposes only. Whilst every care is taken in the production of this plan, measurements, angles and positioning of doors/windows may not be accurate. Interested parties are strongly advised to undertake their own checks when establishing the suitability for furniture etc. Not To Scale.

Plan produced using PlanUp.

16 Wollaston Crescent

16 Wollaston Crescent, East Bunbury
EAST BUNBURY, WA

