

174 Lucy Victoria Avenue AUSTRALIND, WA



## The Perfect Start

Be quick to snap up this beautiful double brick home in family-orientated Clifton Park. Perfectly positioned in this highly sought-after area, this home is situated close to river walks, the golf course, a great primary school, the deli and tavern, and provides the perfect opportunity for those searching for a great first home, ideal investment or downsizer.

### Features include:

- 3 Good sized bedrooms, all with built-in robes
- Spacious open plan living design
- Split system reverse cycle air-conditioning and a tile fire for year round comfort
- Semi-ensuite bathroom
- Single carport with remote controlled door
- 6m x 6m powered shed and hardstand

For more details please visit :

<https://www.summitbunbury.com.au/4733374>

**Price:** \$329,900



**Tracy Mills**

0429 000 887

## Ground Floor

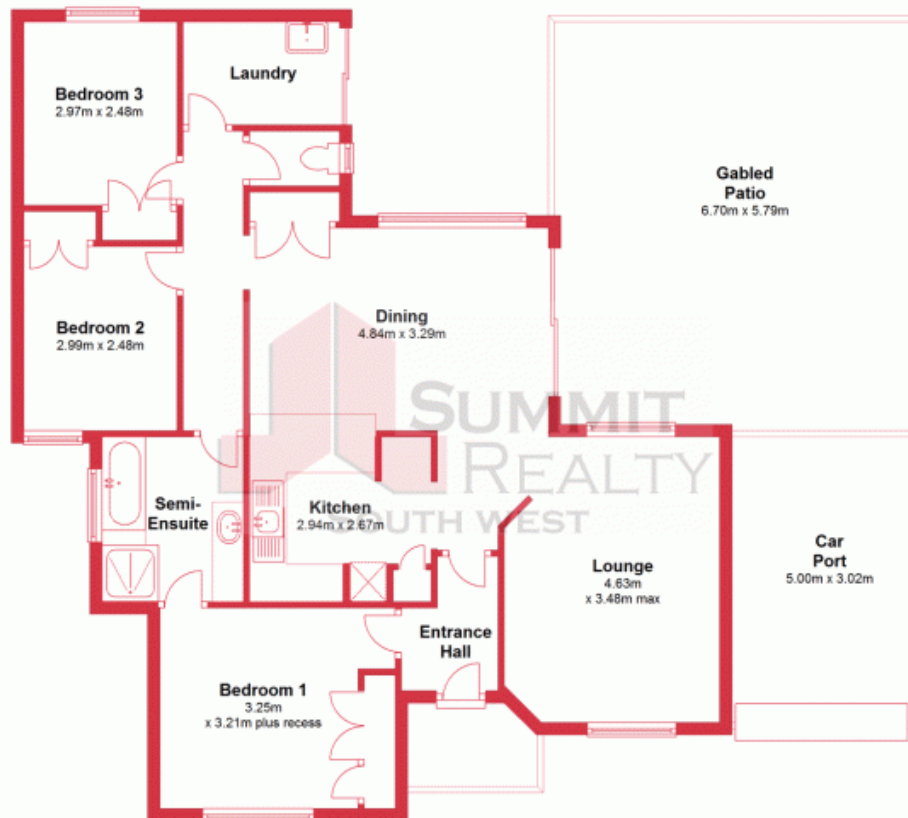

This plan has been prepared for marketing purposes only. Whilst every care is taken in the production of this plan, measurements, angles and positioning of doors/windows may not be accurate. Interested parties are strongly advised to undertake their own checks when establishing the suitability for furniture etc. Not To Scale.  
Plan produced using PlanUp.

174 Lucy Victoria Avenue, Australind

174 Lucy Victoria Avenue

AUSTRALIND, WA

