



28 Polwarth Circuit EATON, WA



4



2



2

## Sleek & Modern

Built in 2011 this modern home is situated in the much sort after Eaton suburb on a 656m2 block. Featuring vibrant healthy lawns and gardens and that sleek open plan design this home will not disappoint inside or outside. Featuring a heightened double garage for extra storage.

Stepping through the archway and through the wide door you will find yourself greeted by a wide hallway, quality flooring, neutral colour scheme and much more.

Featuring ducted air conditioning to keep the family cool throughout the summer months.

The kitchen is sleek and smart in design features overhead cupboards, island bench, gas stove, dishwasher, extra wide oven and all stainless steel. This kitchen will not disappoint

For more details please visit :

<https://www.summitbunbury.com.au/4733386>

**Price:** \$410000



**Lorraine Grassie**

## Ground Floor

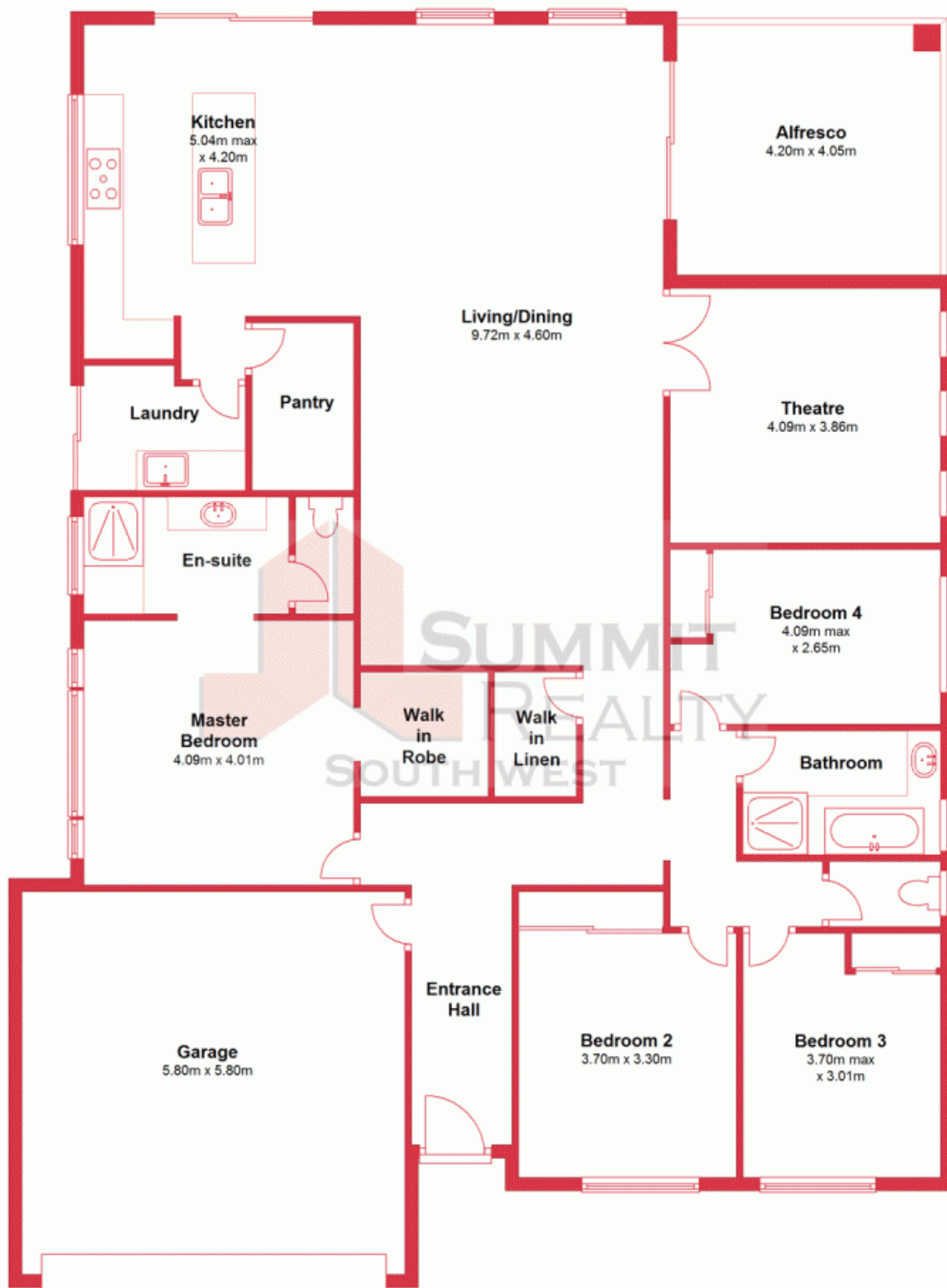

This plan has been prepared for marketing purposes only. Whilst every care is taken in the production of this plan, measurements, angles and positioning of doors/windows may not be accurate. Interested parties are strongly advised to undertake their own checks when establishing the suitability for furniture etc. Not To Scale.  
Plan produced using PlanUp.

28 Polwarth Circuit

28 Polwarth Circuit, Eaton  
EATON, WA

