



23 Beach Road SOUTH BUNBURY, WA

 3
  1
  2

## LOCATION, LOCATION, LOCATION!

If proximity to the ocean is key for you, consider putting yourself in a winning position, just 11 lots back from absolute beach front! Nestled behind tidy, low-maintenance gardens, this 1991 built home sits comfortably on a spacious 654sqm block.

The kitchen is the central heart of the home, hugged by 2 separate living spaces. To the front is an open-plan, L-shaped area, well suited to a combination of lounge and dining spaces. The rear living space looks out to the paved patio and backyard.

The main bedroom enjoys semi-ensuite access and all 3 bedrooms feature built-in-robos. The roomy bathroom offers shower, separate bathtub and single vanity.

The exterior of the home boasts a 6.7m x 2.7m approx. patio for casual entertaining. This

For more details please visit :

<https://www.summitbunbury.com.au/4733387>

**Price:** \$395,000



**Lorraine Grassie**

## Ground Floor

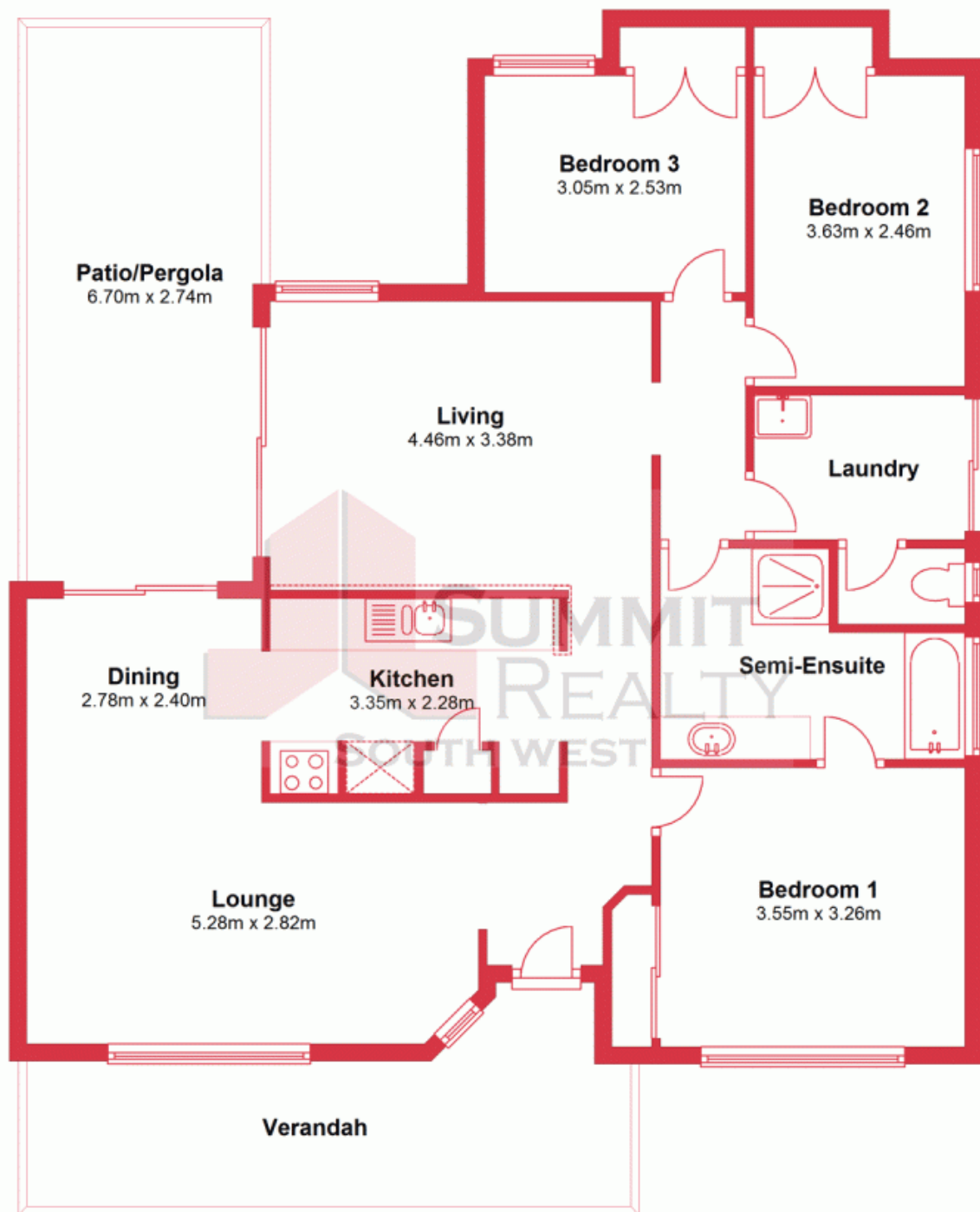

This plan has been prepared for marketing purposes only. Whilst every care is taken in the production of this plan, measurements, angles and positioning of doors/windows may not be accurate. Interested parties are strongly advised to undertake their own checks when establishing the suitability for furniture etc. Not To Scale.

Plan produced using PlanUp.

23 Beach Road

23 Beach Road, South Bunbury,  
SOUTH BUNBURY, WA

