

10 Eulalia Street CAREY PARK, WA

 3  1  1

SWEET HOME, MUST BE SOLD!

Located on an 810m² block located down the road from the Park Centre shopping complex this stunning home has undergone a recent renovation.

With a neat and tidy front exterior and the added bonus of access to the rear through the carport.

This wonderful home features two separate living areas which feature ceiling fans and ducted air conditioning to keep your family and friend cool through the warm summers.

Formal lounge room to the left of the entrance perfect to sit and relax or entertain family and friends.

A dream kitchen with space to move around while you cook up a storm. Featuring lots of bench

For more details please visit :

<https://www.summitbunbury.com.au/4733424>



Lorraine Grassie

Ground Floor

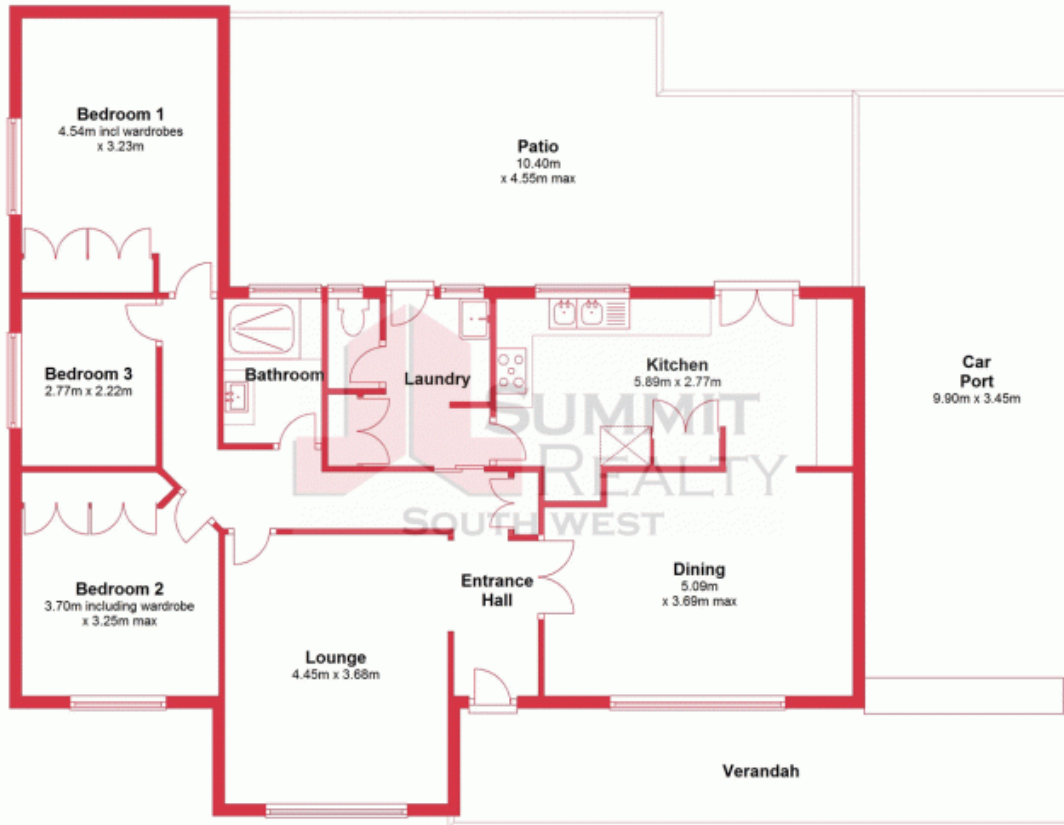

This plan has been prepared for marketing purposes only. Whilst every care is taken in the production of this plan, measurements, angles and positioning of doors/windows may not be accurate. Interested parties are strongly advised to undertake their own checks when establishing the suitability for furniture etc. Not To Scale.
Plan produced using PlanUp.

10 Eulalia Street, Carey Park

10 Eulalia Street

CAREY PARK, WA

