

9 Coronation Drive BINNINGUP, WA



4



2



4

Seaside Sanctuary

Properties in this tightly held street do not come onto the market very often & this is one you don't want to miss!

Built in 1999 by Rod Triplett Homes, this family home has been well maintained and the whole layout suits the relaxed beachside lifestyle of Binningup.

Inside you will find:

- A well proportioned home with generous sized rooms & quality fittings.
- A large entry foyer with display recess and terracotta tiled which extend through the living area.
- The minor bedrooms are all queen sized - two have double built in robes and the other has a 3 panel sliding door wardrobe.
- The kitchen has massive amounts of storage with overhead cupboards above the double fridge recess, large island bench, corner pantry & appliance cupboard. The cream cupboards and

For more details please visit :

<https://www.summitbunbury.com.au/4733427>

Price: \$679,000



Ruth Nandapi

0419 955 965

Ground Floor

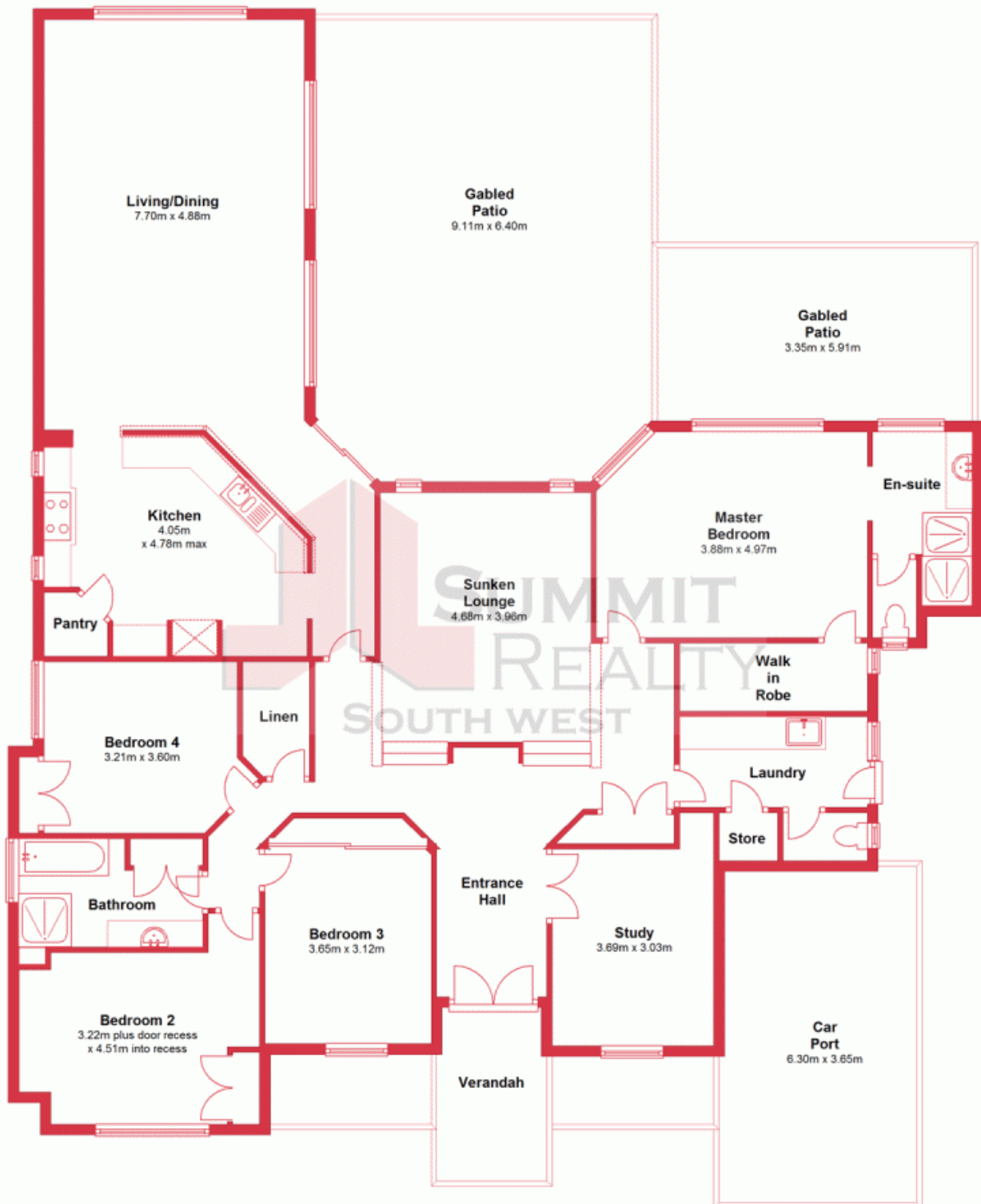

This plan has been prepared for marketing purposes only. Whilst every care is taken in the production of this plan, measurements, angles and positioning of doors and windows may not be accurate. Interested parties are strongly advised to undertake their own checks when establishing the suitability for furniture etc. Not To Scale. Plan produced using PlanUp.

9 Coronation Drive

9 Coronation Drive, Binningup
BINNINGUP, WA

