



130A Minninup Road SOUTH BUNBURY, WA



## AFFORDABLE LIVING IN SOUTH BUNBURY

Ideally located in the desirable suburb of South Bunbury is this neat and tidy two bedroom, one bathroom brick and tile home. Boasting a spacious interior with all original finishes throughout offering a fantastic opportunity to either move in and enjoy as is or add your own personal touches with a renovation. To the rear is a generous yard offering an abundance of space to establish the way that suits you best. Situated close to all amenities and priced to sell this is a must for an inspection. Other features include:

- Two spacious bedrooms
- Built in robes to main bedroom
- Semi ensuite connected to master bedroom
- Open plan living/dining area
- Decorative ceilings and corning to main living area
- Duplex/semi detached

For more details please visit :  
<https://www.summitbunbury.com.au/4733441>

**Price:** From \$199,000



**Tim Cooper**

0437 068 028

## Ground Floor

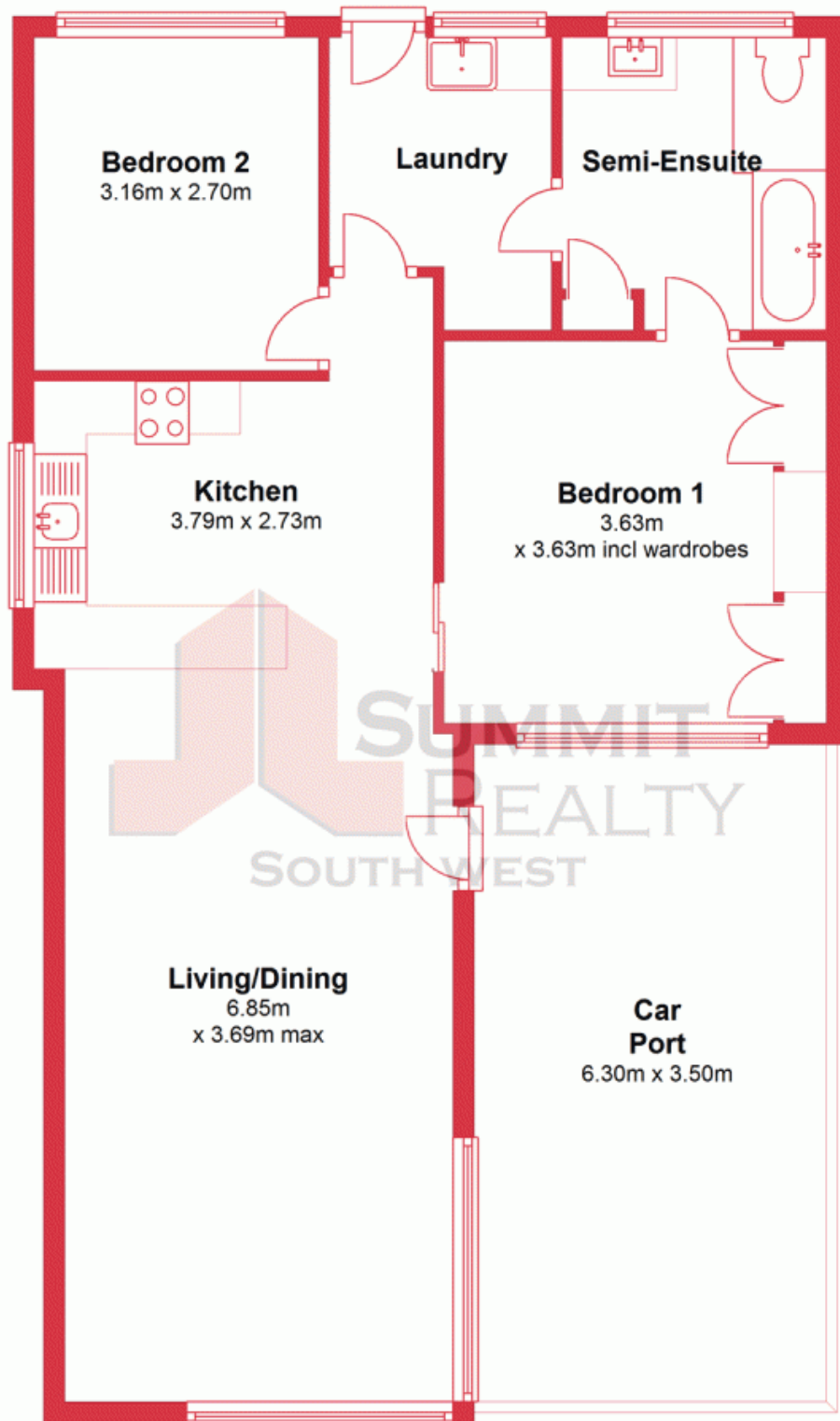

This plan has been prepared for marketing purposes only. Whilst every care is taken in the production of this plan, measurements, angles and positioning of doors/windows may not be accurate. Interested parties are strongly advised to undertake their own checks when establishing the suitability for furniture etc. Not To Scale. Plan produced using PlanUp.

130A Minninup Road

130a Minninup Road, South Bunbury  
SOUTH BUNBURY, WA

