



11 Matilda Avenue AUSTRALIND, WA



3



2



2

## Perfectly Poised in Popular Matilda!

You can't go wrong with this 3 bedroom 2 bathroom brick & tile home, whether your looking for your first home, downsizing or thinking of starting an investment portfolio.

Tiled entry opens onto the carpeted sunken lounge with bay window, sharing the reverse cycle LG air conditioning with the separate dining room.

Kitchen with fridge recess and built in pantry overlooking carpeted living area with exposed brick feature walls, ceiling fan and wood heater.

Attractive established gardens feature a white front picket fence include Olive and Fig trees and various rose varieties! Plus reticulated off mains.

803sqm block bordered with a white picket fence plus brick paved patio overlooking easy to maintain rear yard.

Features include: carport, bore, 2 woodsheds & bird aviaries.

**Price:** \$280000



**Lorraine Grassie**

For more details please visit :

<https://www.summitbunbury.com.au/4733464>

[www.summitbunbury.com.au](http://www.summitbunbury.com.au)

## Ground Floor

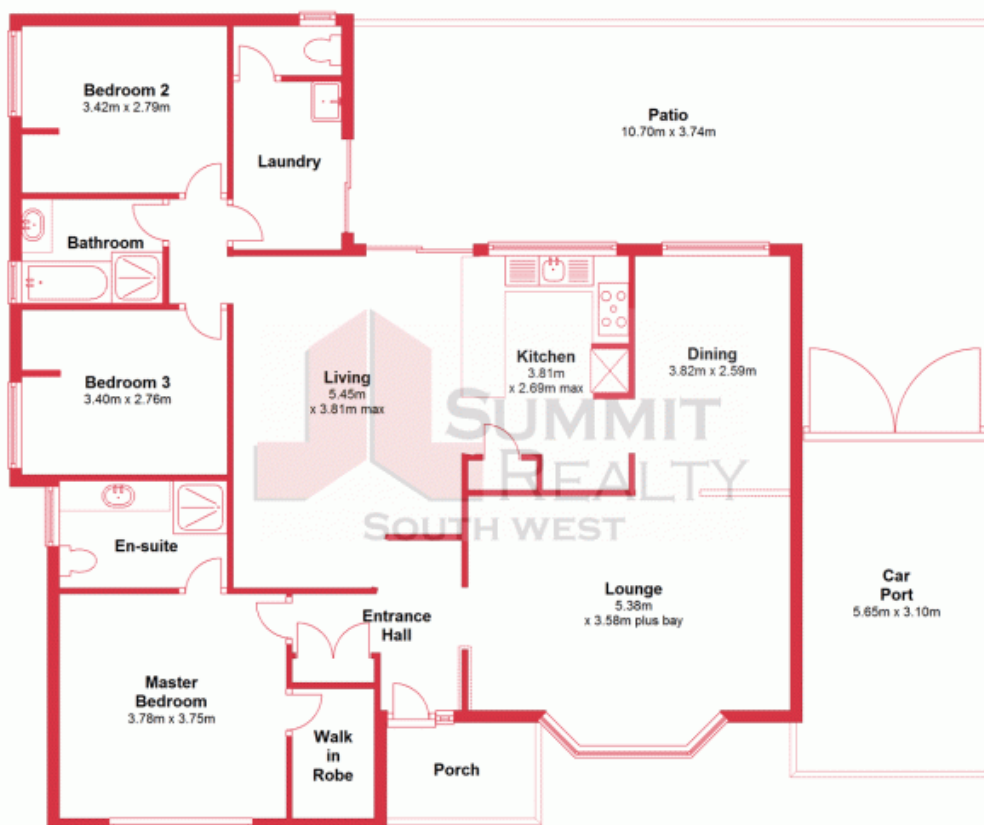

This plan has been prepared for marketing purposes only. Whilst every care is taken in the production of this plan, measurements, angles and positioning of doors/windows may not be accurate. Interested parties are strongly advised to undertake their own checks when establishing the suitability for furniture etc. Not To Scale.  
Plan produced using PlanUp.

11 Matilda Avenue, Australind

11 Matilda Avenue

AUSTRALIND, WA

