



28 Coachwood Way GELORUP, WA

 5
  3
  3

GELORUP HOMESTEAD

Brand new listing.

Price: \$619,000

The very moment you stroll through the garden entrance of this beautiful fully insulated brick and Zincalume family home you will discover the relaxing quality of country life.

The next stop, the kitchen has excellent space with a centre cutting and food preparation island bench, a gas top, wall oven and dishwasher with easy access to lounge, dining and living areas.

Take a moment and appreciate the stunning shine of the polished timber flooring and fittings throughout this delightful home. They truly are a "must see".

The formal lounge, dining and family room access out onto the well placed patio, just the

For more details please visit :

<https://www.summitbunbury.com.au/4733528>



Lorraine Grassie

Ground Floor

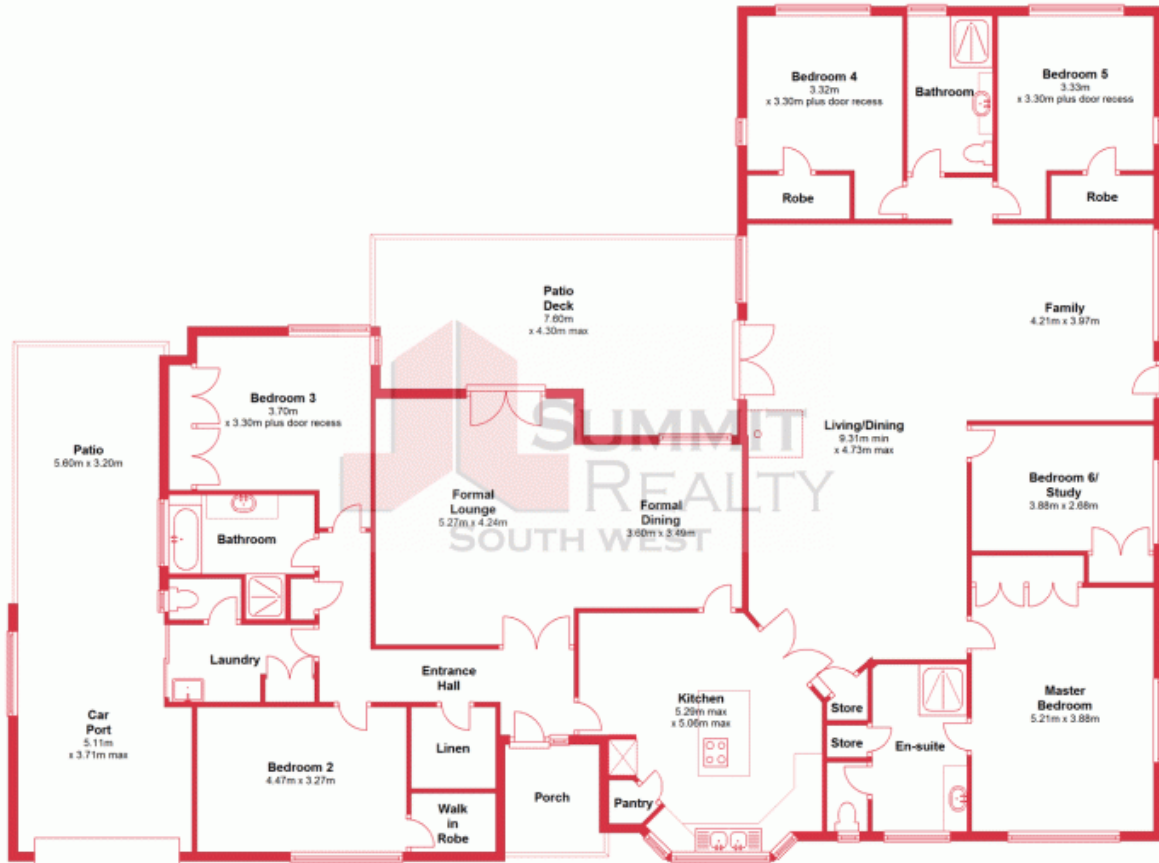

This plan has been prepared for marketing purposes only. Whilst every care is taken in the production of this plan, measurements, angles and positioning of doors/windows may not be accurate. Interested parties are strongly advised to undertake their own checks when establishing the suitability for furniture etc. Not To Scale. Plan produced using PlanLip.

28 Coachwood Way, Gelorup

28 Coachwood Way

GELORUP, WA

