



9 Maiden Park Road WITHERS, WA



4



2



2

LOOK NO FURTHER - ON NATURE'S DOORSTEP!

Just try finding anything else on the market at the moment that offers as many options as this home does....A whole lot of love and care has been poured into this home and it presents a wonderful opportunity for families. From the moment you step through the front door you are bound to notice this home is perfect for those buyers looking for easy, secure and low maintenance living and offers something special.

Feature include

- 4 bedrooms, main bedroom features a built-in robes with ceiling fan, 2 minor bedrooms have built-in robes
- Study/Office
- Kitchen has been renovated with new cupboards, overhead cupboards, plenty of drawers and ample bench space, dishwasher, large freestanding stainless steel oven, single fridge rec

For more details please visit :

<https://www.summitbunbury.com.au/4733571>



Tracy Mills

0429 000 887

Ground Floor

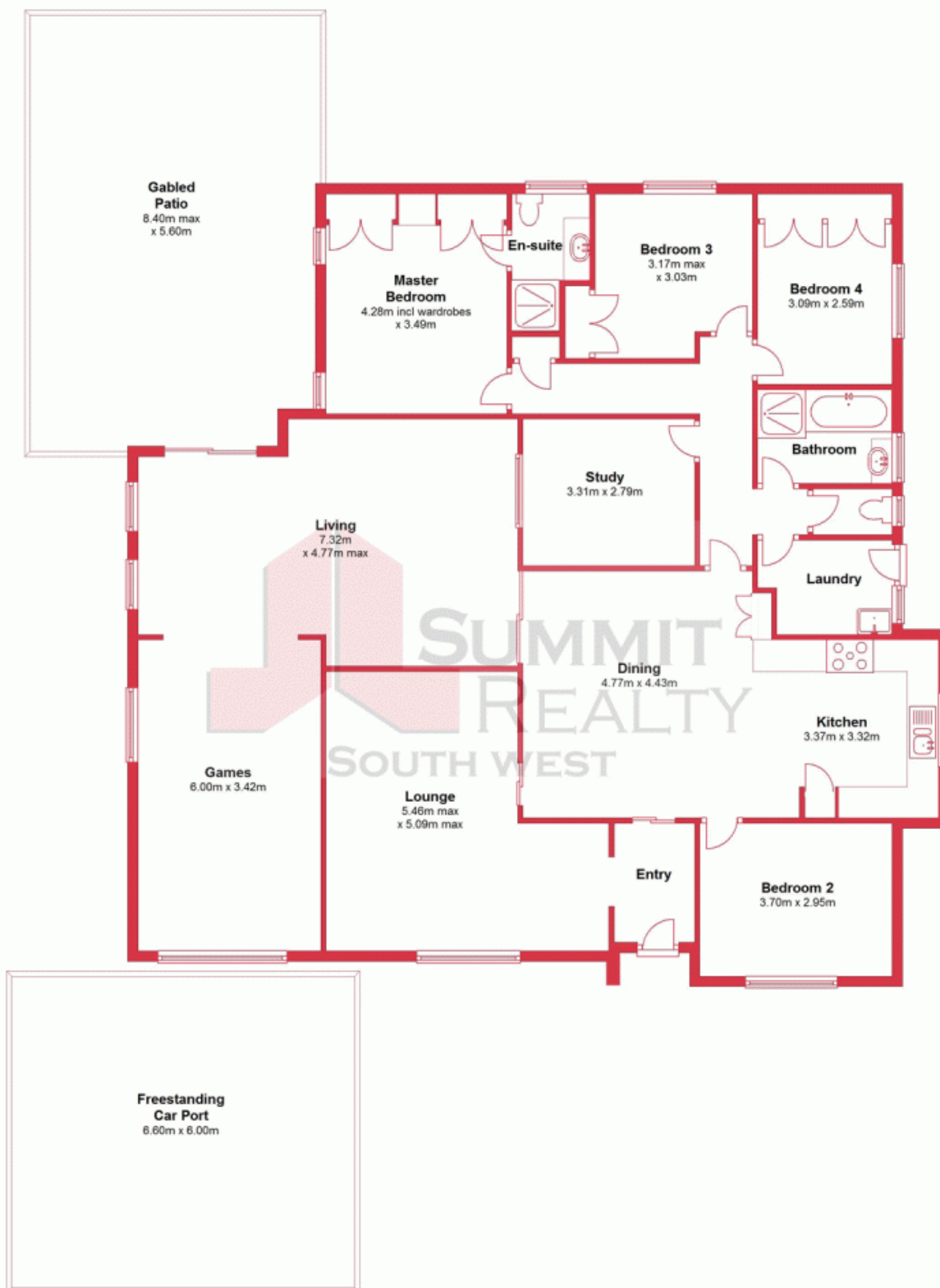

This plan has been prepared for marketing purposes only. Whilst every care is taken in the production of this plan, measurements, angles and positioning of doors/windows may not be accurate. Interested parties are strongly advised to undertake their own checks when establishing the suitability for furniture etc. Not To Scale. Plan produced using PlanUp.

9 Maiden Park Road

9 Maiden Park Road, Withers,
WITHERS, WA

