



29 Gregory Street SOUTH BUNBURY, WA

 4
  1
  1

## OVERFLOWING WITH OPPORTUNITY

Located in a quiet pocket of South Bunbury, resting on an enormous 1141m<sup>2</sup> block is this neat and tidy four bedroom, one bathroom home. Presenting an array of opportunities to the savvy buyer with its spacious, partially renovated interior and full size block offering subdivision potential (subject to council approval). Located to the rear of the home (via gated side access) is a separate freestanding double carport, large powered workshop as well as an abundance of yard space to keep the whole family happy. Call today for more information or to secure a viewing.

Other features include:

- Four large bedrooms, master bedroom features built in robes
- Spacious front lounge with carpeted floors and decorative ceilings
- Dining area adjoining the kitchen

For more details please visit :  
<https://www.summitbunbury.com.au/4733584>

**Price:** From \$420,000



**Tim Cooper**

0437 068 028

## Ground Floor

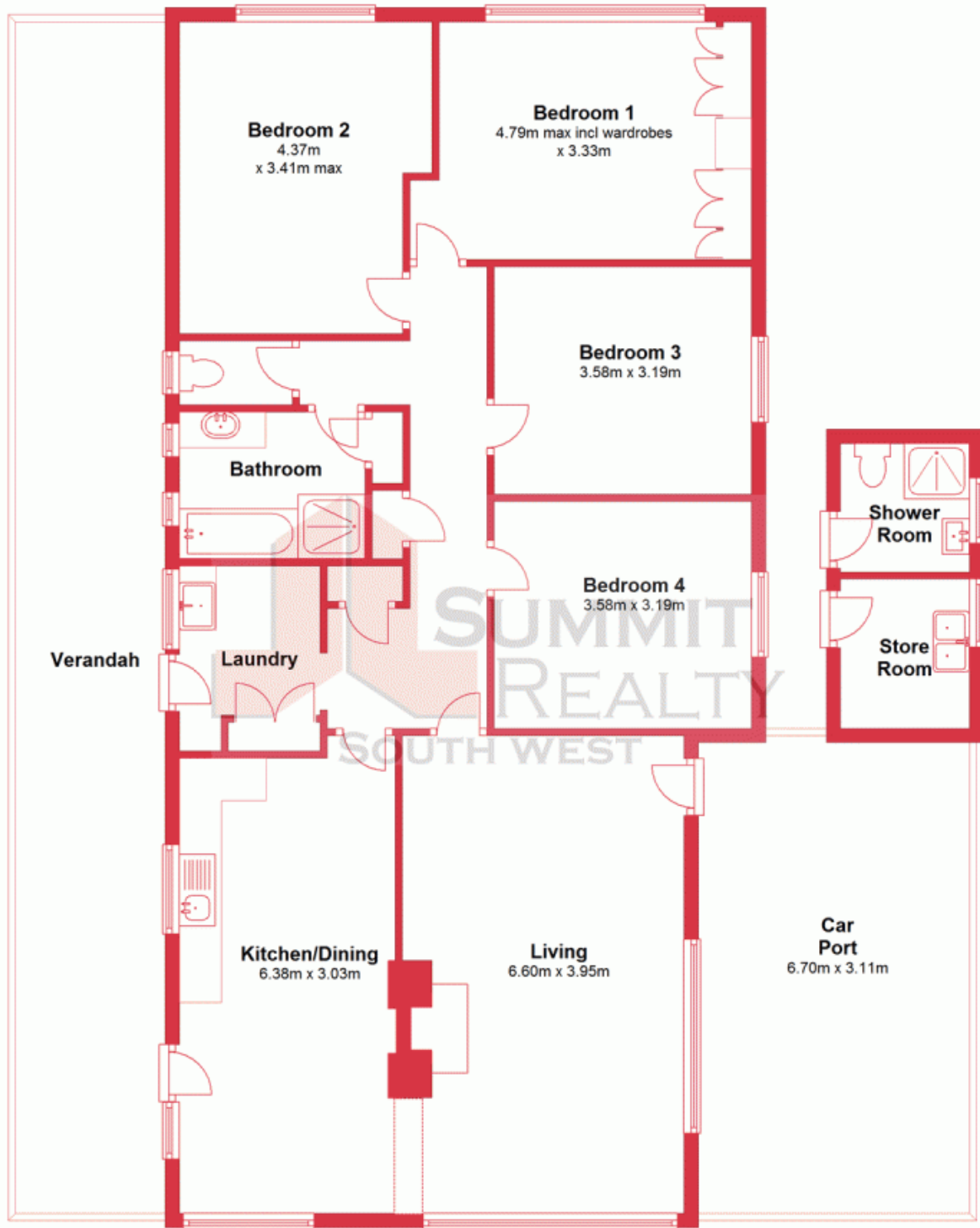

This plan has been prepared for marketing purposes only. Whilst every care is taken in the production of this plan, measurements, angles and positioning of doors/windows may not be accurate. Interested parties are strongly advised to undertake their own checks when establishing the suitability for furniture etc.  
Not To Scale.

Plan produced using PlanUp.

29 Gregory Street

29 Gregory Street, South Bunbury,  
SOUTH BUNBURY, WA

