



42 Glenfield Drive AUSTRALIND, WA

 5

 2

 2

5 Bedrooms + Shed = Less than \$400k?!?

Subtle exterior with a spacious interior:

While modest from the outset, you will be delighted to call this house home. Using positive design cues and allowing seamless transition from each living space, this superb Content Living family home can be enjoyed by all. Style and class exude from the chefs kitchen, with ample space in the pantry to store food for a family of six! Lock yourself away in the Family/Theatre room, or enjoy quiet time to read in the Formal Lounge at the front.

42 Glenfield Drive, Australind features:

- 5 Bedrooms, all with built-ins
- 2 Bathrooms
- Master suite with huge walk-in robe

Price: \$395,000+



Lorraine Grassie

For more details please visit :
<https://www.summitbunbury.com.au/4733586>

Ground Floor

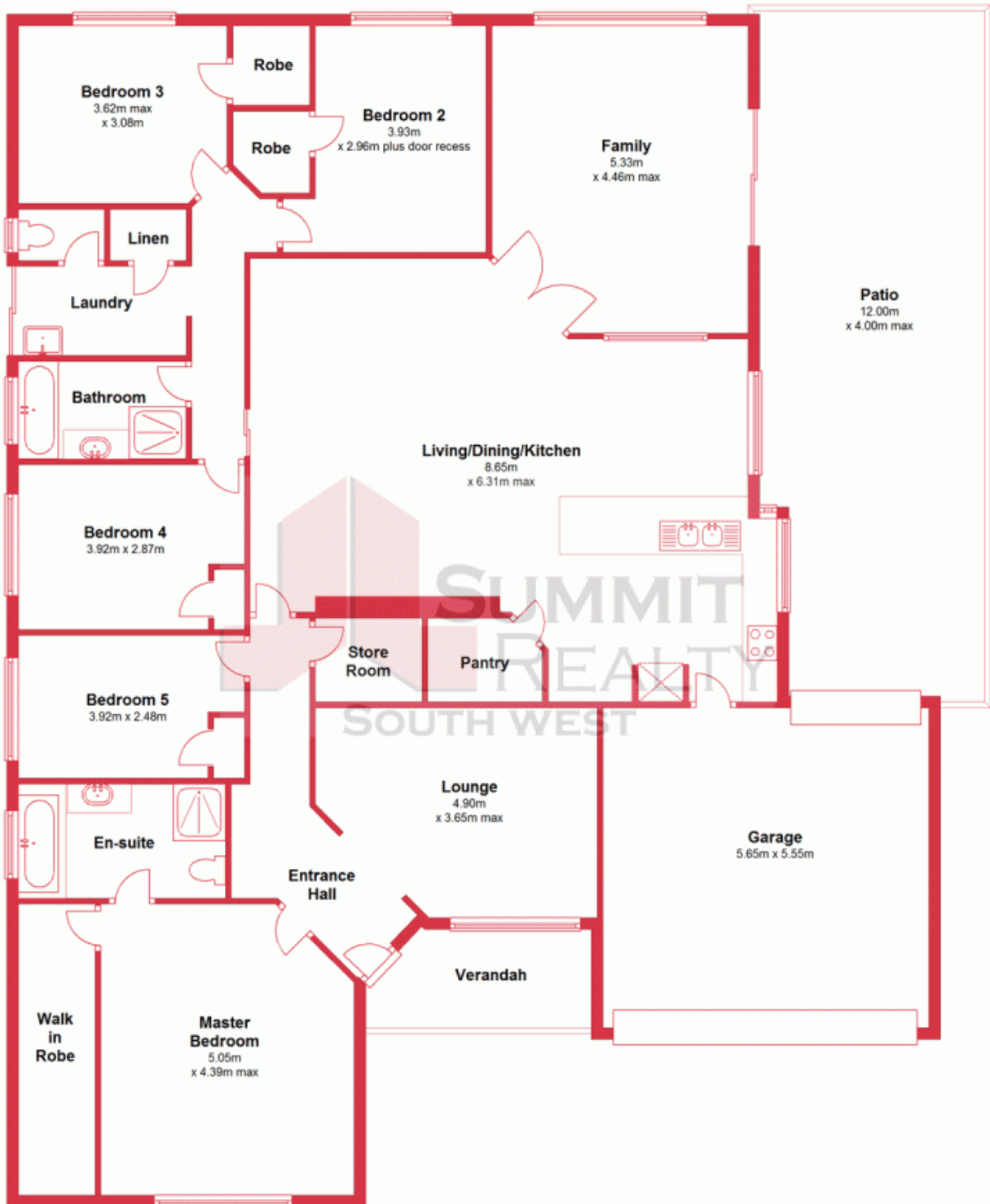

This plan has been prepared for marketing purposes only. Whilst every care is taken in the production of this plan, measurements, angles and positioning of doors/windows may not be accurate. Interested parties are strongly advised to undertake their own checks when establishing the suitability for furniture. Plan produced using PlanUp.

42 Glenfield Drive

42 Glenfield Drive, Australind,
AUSTRALIND, WA

