

96 Wisbey Street CAREY PARK, WA

3 2 2

Stunning Downsizer or First Home Offers High End Appeal

When downsizing isn't really downsizing, you're viewing 96 Wisbey Street. With subtle, attractive street appeal, this lock & leave delight will surprise you from the moment you arrive.

The home ushers you in via an impressive entry hall - complete with lofty ceilings and stunning feature flooring.

Not your standard 3 x 2, the interior is characterised by quality finishes, such as high ceilings, cornicing, skirting boards, porcelain tiled floors and ceiling roses. The layout is unique, rooms are spacious and there's plenty of storage throughout!

The central kitchen is well-equipped for keen home cooks. There's no shortage of drawer and cupboard storage, and plenty of bench space for meal preparation and bar stool entertain

For more details please visit :

<https://www.summitbunbury.com.au/4733590>

Price: \$350,000



Lorraine Grassie

Ground Floor

This plan has been reproduced from a supplied architect drawing. Plan 2 Move cannot guarantee the accuracy.

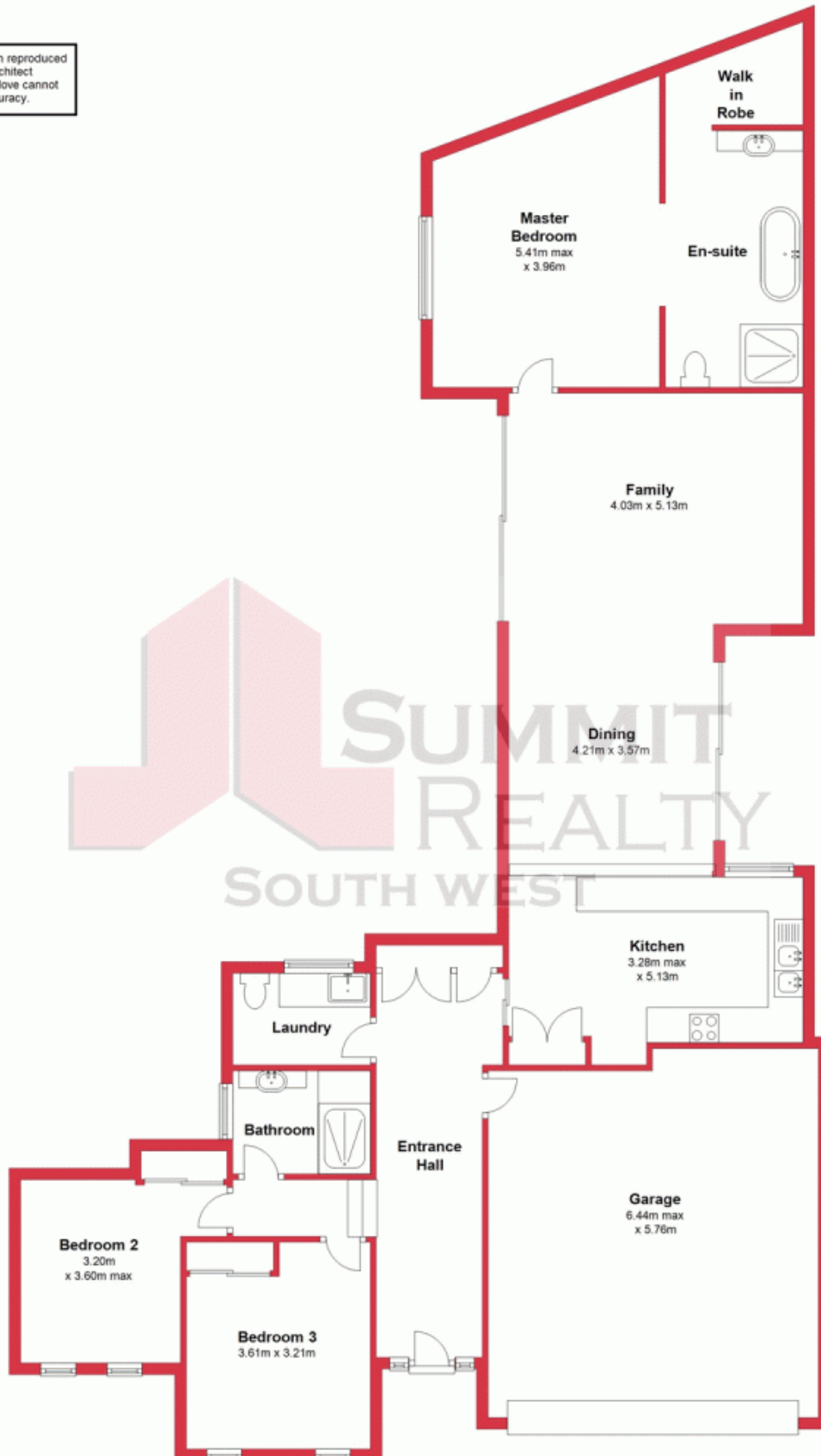

This plan has been prepared for marketing purposes only. Whilst every care is taken in the production of this plan, measurements, angles and positioning of doors/windows may not be accurate. Interested parties are strongly advised to undertake their own checks when establishing the suitability for furniture etc. Not To Scale.
Plan produced using PlanUp.

96 Wisbey Street

96 Wisbey Street, Carey Park,
CAREY PARK, WA

