



35 Lofthouse Avenue EATON, WA



AN IDEAL PLACE TO START

Conveniently located in the expanding suburb of Eaton, just a stones throw from the Eaton Fair Shopping Centre is this perfectly presented three bedroom, one bathroom home. Surprisingly spacious inside and maintained to an incredible standard, this home is sure to impress. Boasting a generous rear yard with a gated side access and a fully powered workshop this property offers little to be done but move in and enjoy. Call today to arrange a viewing.

Other features include:

- Three spacious bedrooms all with built in robes
- Large open plan living/dining area
- Tiled flooring throughout
- Feature face brick internal walls

For more details please visit :

<https://www.summitbunbury.com.au/4733632>

Price: From \$285,000



Tim Cooper

0437 068 028

Ground Floor

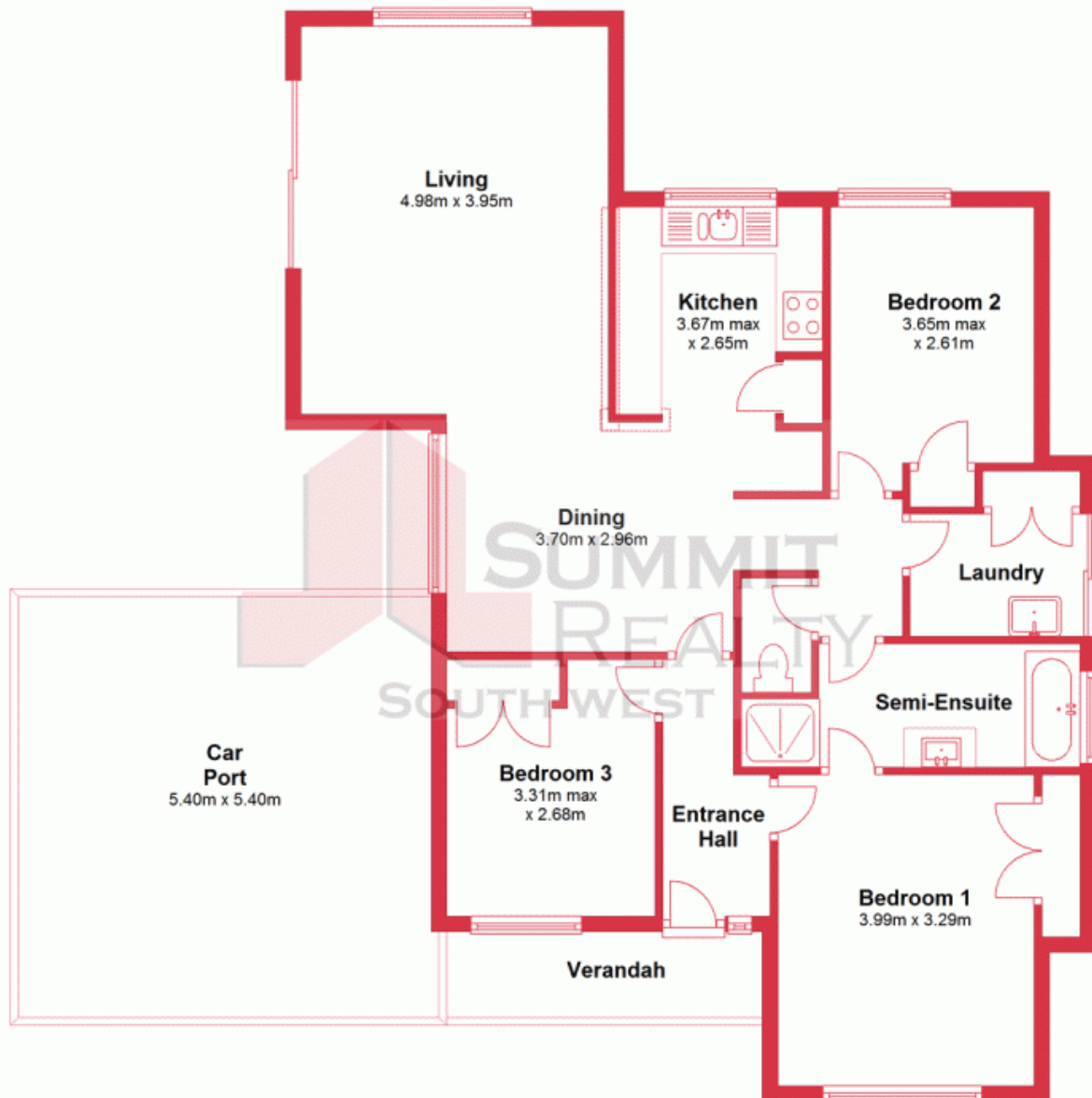

This plan has been prepared for marketing purposes only. Whilst every care is taken in the production of this plan, measurements, angles and positioning of doors/windows may not be accurate. Interested parties are strongly advised to undertake their own checks when establishing the suitability for furniture etc. Not To Scale.

Plan produced using PlanUp.

35 Lofthouse Avenue

**35 Lofthouse Avenue, Eaton
EATON, WA**

