



28A Claughton Way GLEN IRIS, WA

 4
  2
  2

JUST MOVE IN AND ENJOY

Conveniently located in the central suburb of Glen Iris is this beautifully presented four bedroom, two bathroom unit on an easy care 448m² block. Surprisingly spacious in its interior with good sized bedrooms and a well-appointed central kitchen. Positioned to the rear of the home is a generous alfresco area perfect for entertaining plus a small section of yard with artificial turf helping to keep maintenance to an absolute minimum. A fantastic opportunity for a downsizer, investor, or first home buyer this property is an absolute must to inspect.

Other features include:

- Four spacious bedrooms all with built in robes
- Large open plan living/dining area
- Timber look vinyl flooring throughout

For more details please visit :

<https://www.summitbunbury.com.au/4733636>



Tim Cooper

0437 068 028

Ground Floor

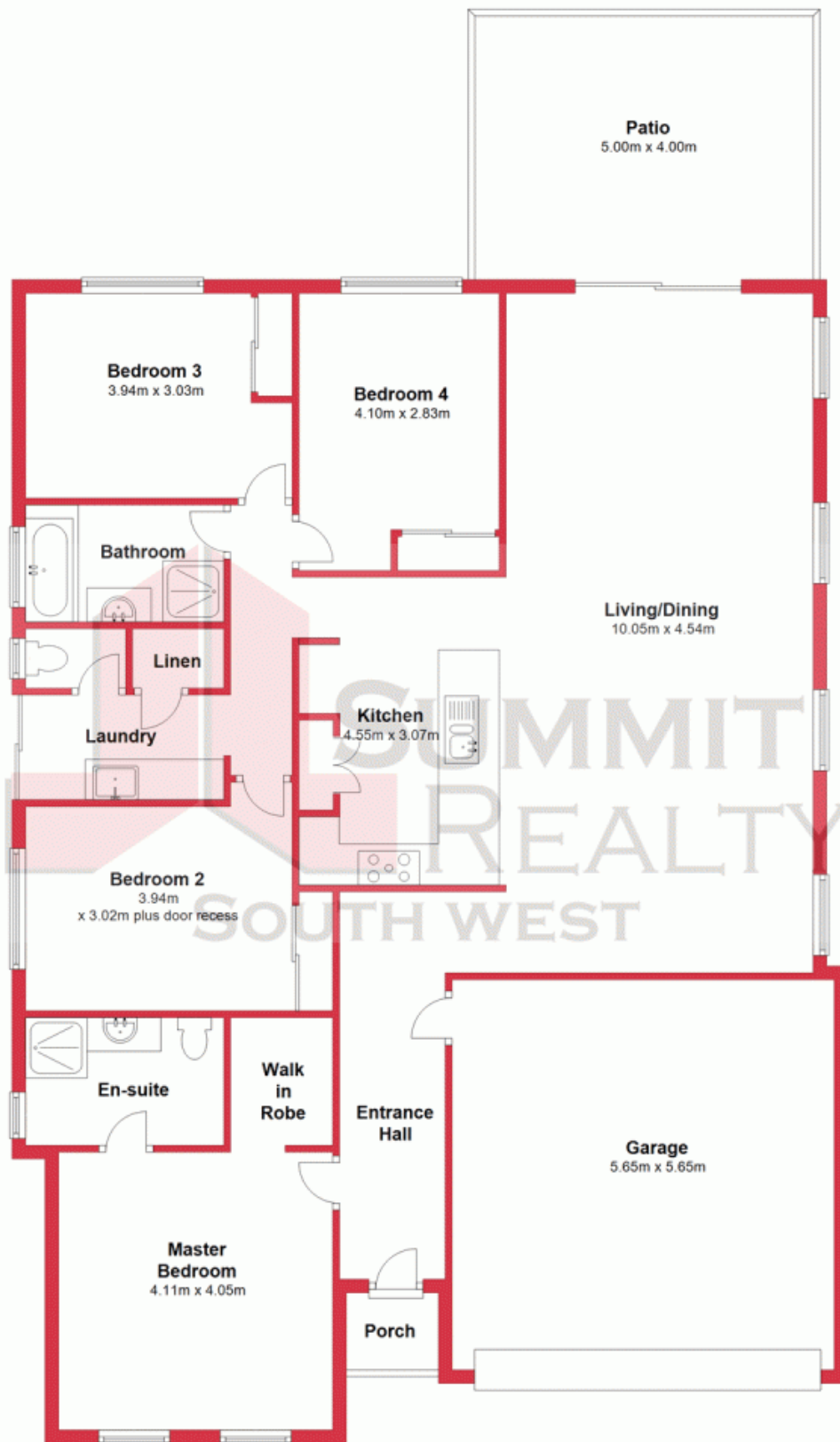

This plan has been prepared for marketing purposes only. Whilst every care is taken in the production of this plan, measurements, angles and positioning of doors/windows may not be accurate. Interested parties are strongly advised to undertake their own checks when establishing the suitability for furniture etc. Not To Scale.
Plan produced using PlanUp.

28A Claughton Way

28a Claughton Way, Glen Iris
GLEN IRIS, WA

