



28 Belvedere Crescent EATON, WA

 3
  1
  2

EATONS BEST VALUE!

This neat and tidy brick and tile home sits on a large 911m2 block and offers you the perfect start, a smart investment or a cosy downsizer. Step inside and enjoy the recently renovated kitchen, new flooring throughout and a modern fresh appeal.

Out the back offers you a great patio for entertaining or watching the kids play and explore within the well-established large grassed areas.

Well positioned in Eaton with nearby primary school and easy access to the local Eaton Fair shopping centre, Eaton Community college and the Recreational Facilities.

This home features:

- 3 bedrooms and 1 bathroom

For more details please visit :

<https://www.summitbunbury.com.au/4733637>

Price: Offers Over \$259,000



Lorraine Grassie

Ground Floor

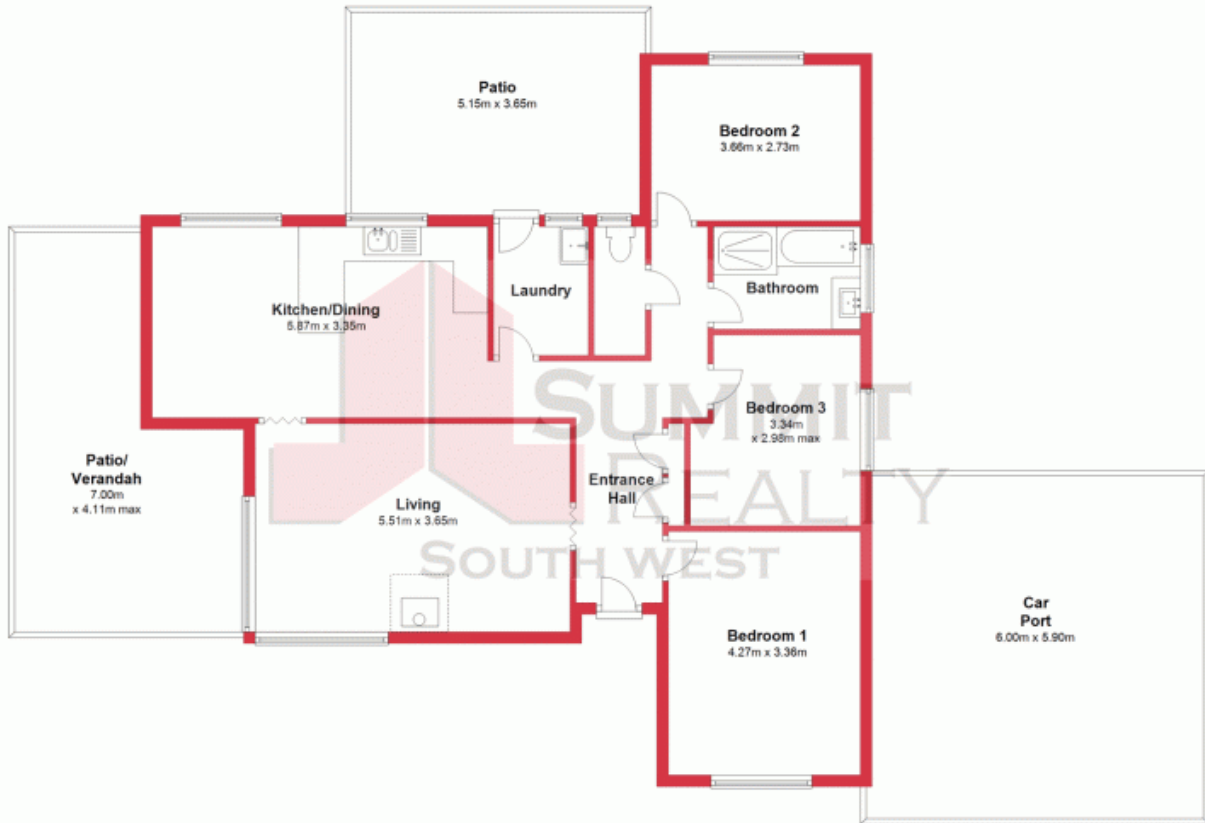

This plan has been prepared for marketing purposes only. Whilst every care is taken in the production of this plan, measurements, angles and positioning of doors/windows may not be accurate. Interested parties are strongly advised to undertake their own checks when establishing the suitability for furniture etc. Not To Scale. Plan produced using PlanUp.

28 Belvedere Crescent, Eaton

28 Belvedere Crescent

EATON, WA

