



7 Greendale Place GELORUP, WA

 4

 2

 2

THE PERFECT HOME IN THE PERFECT SETTING

Price: From \$700,000

Other features include:

- Four spacious bedrooms, three of which feature built in robes
- Main bedroom has ensuite/toilet and WIR, privacy from children's wing
- Separate office next to main entrance
- Large open plan living/dining area
- Split level with high ceilings
- Spacious sunken family/games room to the rear
- Well-appointed kitchen with stone bench tops
- Ducted evaporative cooling throughout
- Split system air conditioning to main living area and granny flat
- Double open carport
- Salt water 45,000L Long Weekender pool by WA fibre glass pools, 8.5m X 4m with spa seating

For more details please visit :
<https://www.summitbunbury.com.au/4733674>



Tim Cooper

0437 068 028

Ground Floor

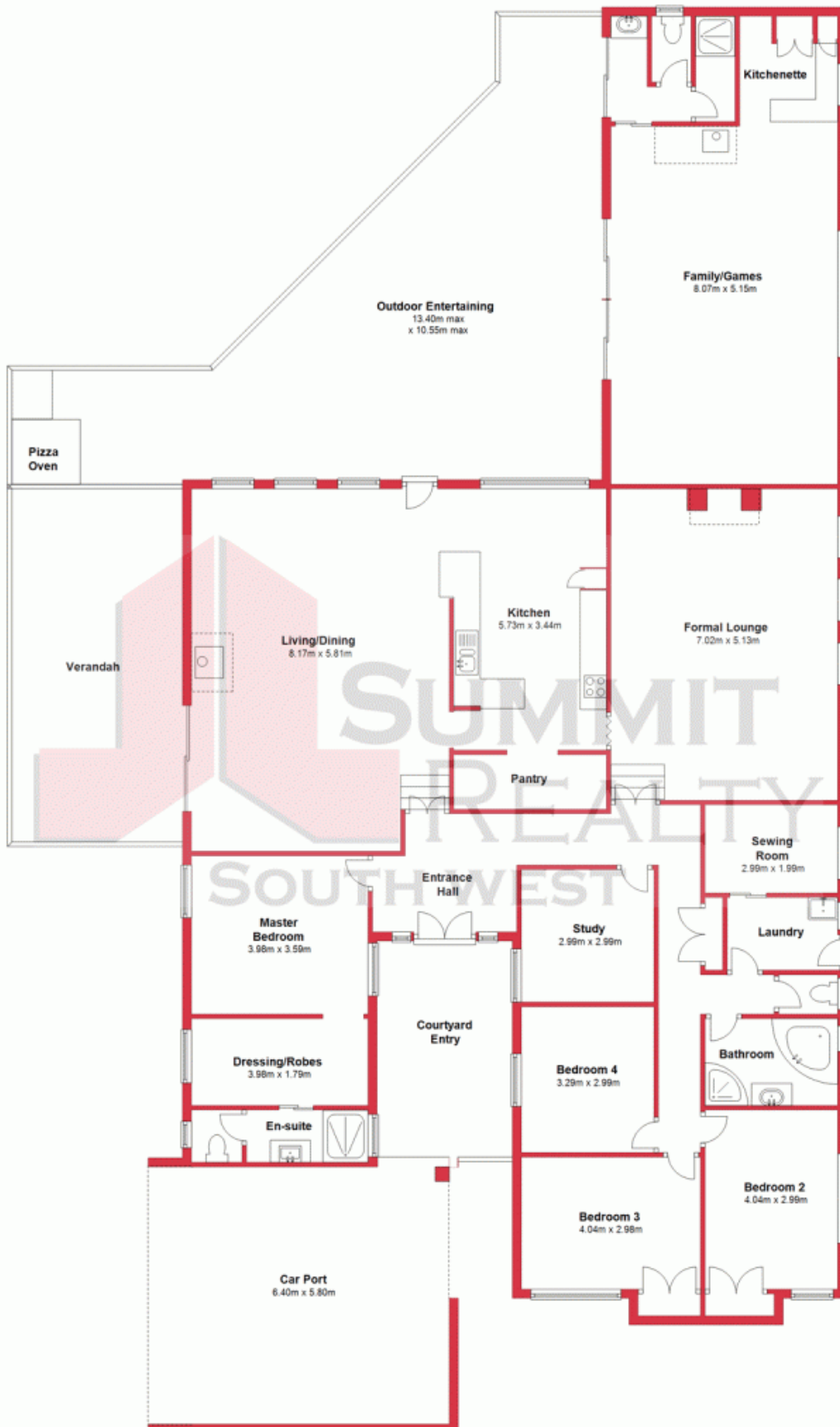

This plan has been prepared for marketing purposes only. Whilst every care is taken in the production of this plan, measurements, angles and positioning of doors and windows may not be accurate. Interested parties are strongly advised to undertake their own checks when establishing the suitability for furniture etc. Not To Scale.
Plan produced using PlanUp.

7 Greendale Place

GELORUP, WA

