



6 Poller Way AUSTRALIND, WA



4



2



2

## FABULOUS FAMILY HOME

**Price:** \$420000

Other features include:

- Four large bedrooms all with built in robes
- Formal lounge located to the front of the home which features built in bar
- Well-appointed kitchen with stone benches and Neff appliances
- Sunken lounge room to the rear
- Separate office with built in cabinetry
- Open plan dining area off kitchen
- Laminate timber floors to all bedrooms and formal lounge
- Ducted reverse cycle air conditioning throughout
- Double lock up garage with remote door
- Powered brick workshop (Approx. 6m x 6m)
- Two lock up garden shed



**Tim Cooper**

0437 068 028

For more details please visit :

<https://www.summitbunbury.com.au/4733681>

## Ground Floor

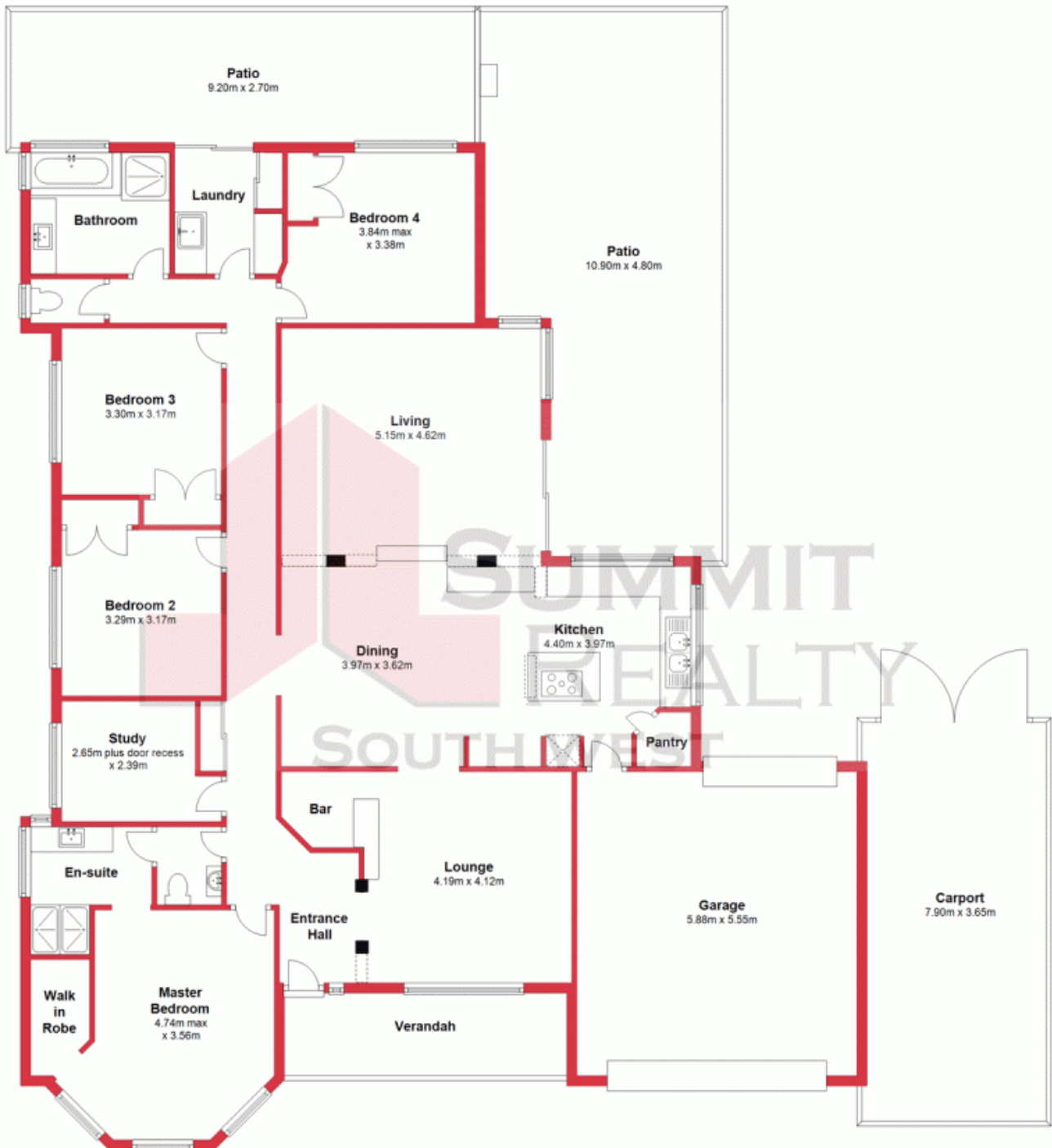

This plan has been prepared for marketing purposes only. Whilst every care is taken in the production of this plan, measurements, angles and positioning of doors/windows may not be accurate. Interested parties are strongly advised to undertake their own checks when establishing the suitability for their needs etc. Not To Scale.

Plan produced using PlanUp.

6 Poller Way

6 Poller Way, Australind, WA

