



1/16 Wellington Street BUNBURY, WA

 2
  1
  2

## PRIME LOCATION

You will find yourself 2 minutes from the heart of the CBD where you have everything that you need, with cafes, transport, parks and bus station coupled with also a few minutes walk away from the beach. Bunbury is an ever growing city with multiple award winning restaurants and hotels right on your door step - what could be better!

Living at Wellington Street brings you the finest unit living has to offer. This newly renovated 2 bedroom unit is kitted out to a high specifications befitting of this prime residential location.

The kitchen is suitably high end with ample cupboard space and workable bench areas, and it is also well connected for ease to the dining.

Designed for the owner-occupier and investor alike, this apartment includes:

- \*Large master bedroom with built in triple sliding mirrored wardrobes
- \*Spacious Open Plan Living Areas

For more details please visit :

<https://www.summitbunbury.com.au/4733764>

**Price:** From \$325,000



**Tim Cooper**

0437 068 028

## Ground Floor

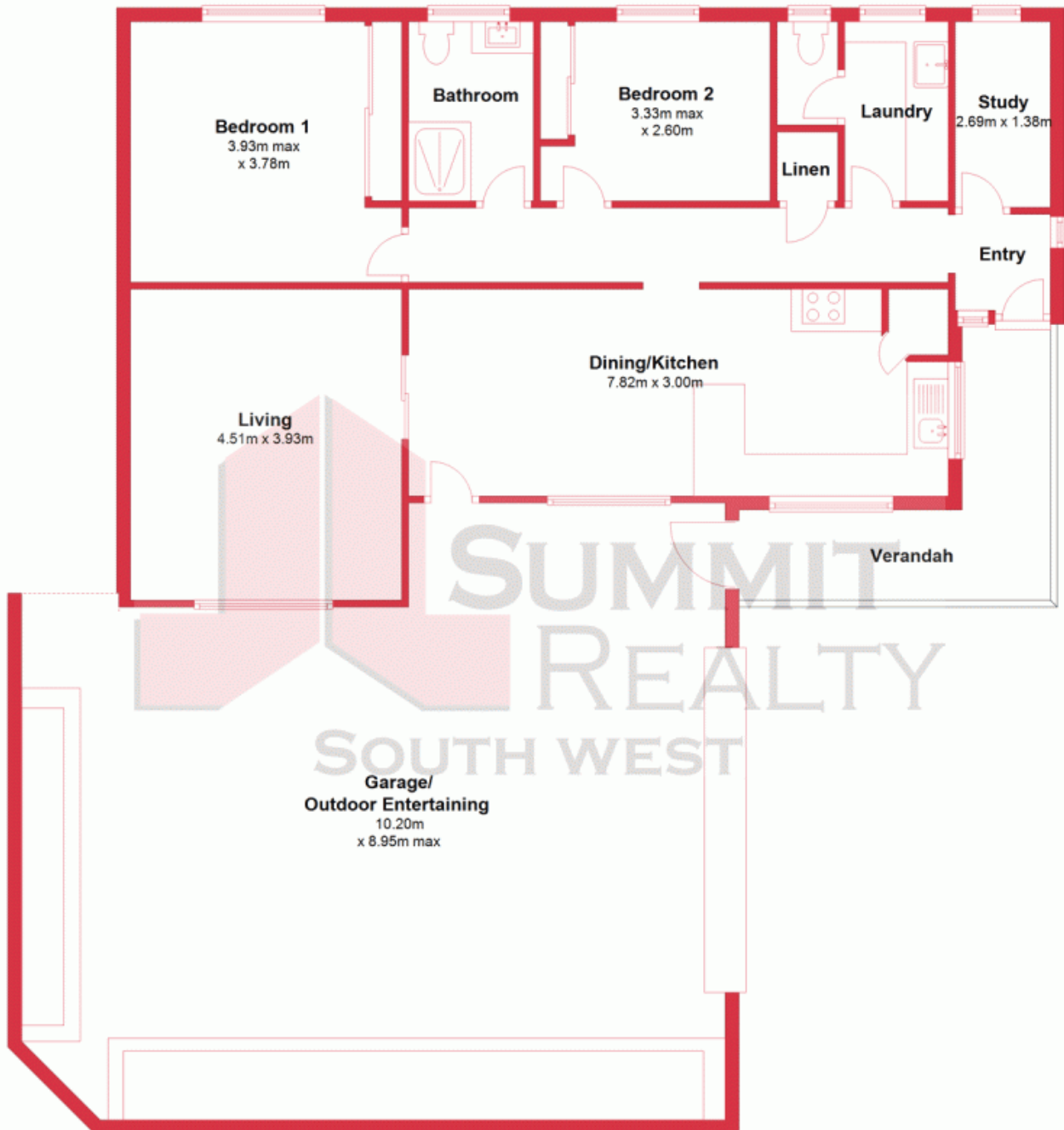

This plan has been prepared for marketing purposes only. Whilst every care is taken in the production of this plan, measurements, angles and positioning of doors/windows may not be accurate. Interested parties are strongly advised to undertake their own checks when establishing the suitability for furniture etc. Not To Scale.

Plan produced using PlanUp.

1/16 Wellington Street

1/16 Wellington St, Bunbury  
BUNBURY, WA

