



8A Medic Street COLLIE, WA

 4
  2
  2

HOP SKIP & JUMP

Looking for a decent size house with a very manageable yard close to the action- Well with just a hop, skip and a jump from the central business district this 2008 built home is just what you've been waiting for. With a focus on space and practicality it ticks all the boxes and is big enough for the whole family to enjoy.

With a list of features as long as your arm this property would cater for a variety of buyers including those looking to reduce in yard size yet retain a very spacious home to those wanting the convenience of town just a short stroll away.

WHY YOU SHOULD BUY ME.....

- Constructed in 2008 of double brick and Iron on a 414m2 block.
- Open plan kitchen / living / dining.
- Well equipped kitchen, thoughtfully designed with plenty of bench and cupboard space, Is

For more details please visit :

<https://www.summitbunbury.com.au/4733782>

Price: \$315,000



Lorraine Grassie

Ground Floor

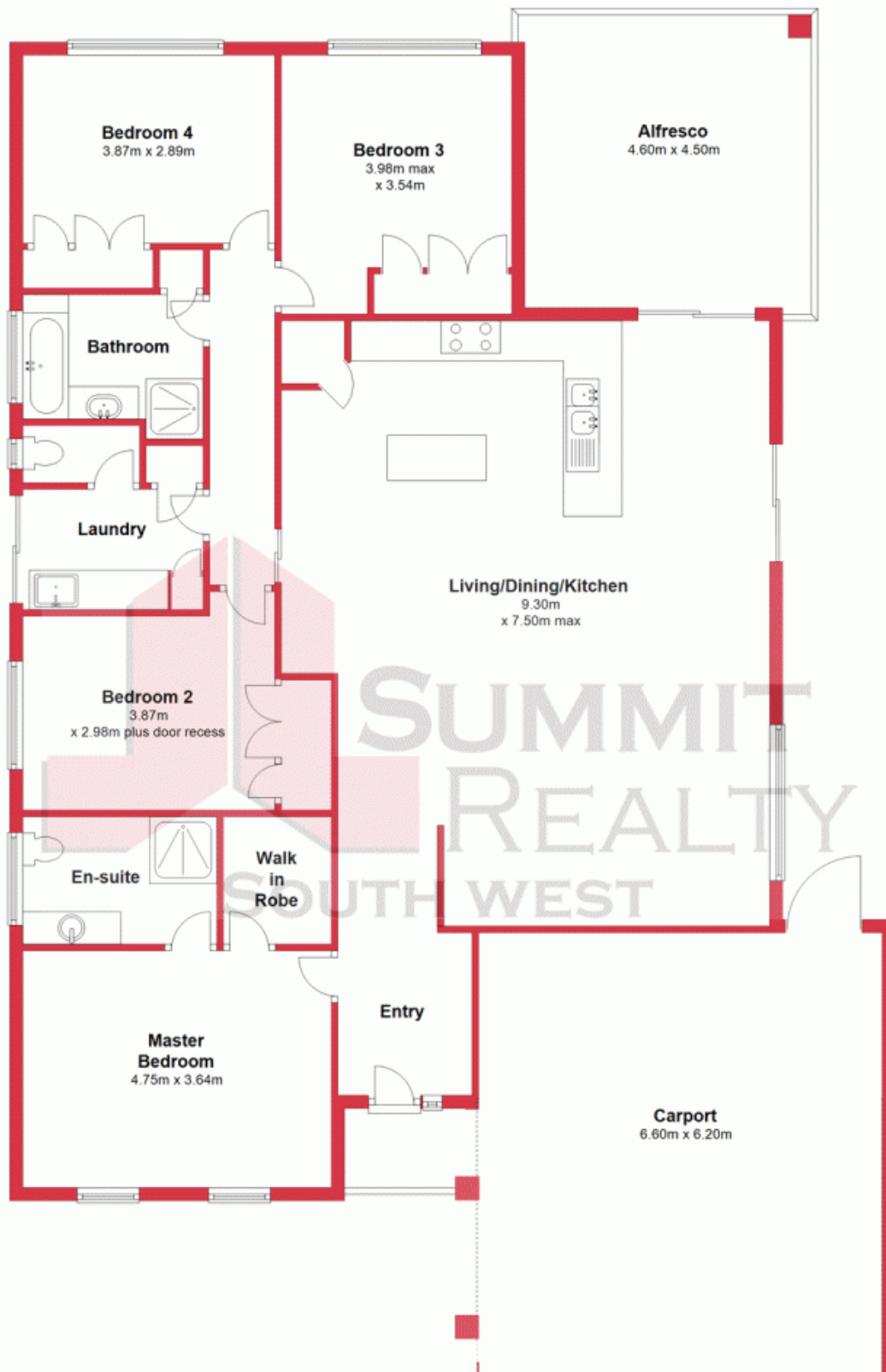

This plan has been prepared for marketing purposes only. Whilst every care is taken in the production of this plan, measurements, angles and positioning of doors/windows may not be accurate. Interested parties are strongly advised to undertake their own checks when establishing the suitability for furniture etc. Not To Scale.
Plan produced using PlanUp.

8A Medic Street

8A Medic Street, Collie
COLLIE, WA

