



7 Lindfield Road AUSTRALIND, WA



4



2



2

GRAND IN SIZE AND DESIGN

This beautifully presented family home has been expertly built by Summit Homes and lies in an ideal position in the family friendly estate of Kingston.

Defined by space and sophistication, this 4 bedroom residence offers a flowing interior that includes extra-large bedrooms, activity room, roomy theatre and a stunning open plan living area that features a cathedral ceiling and flows through to the huge alfresco area.

A crisp and modern kitchen will have you cooking up a storm and offers you quality stainless appliances, stone bench tops and ample bench and storage space; combining space, style and functionality.

The Master suite is generous both in size and inclusions. You will be spoilt for choice with his and hers walk in robes, vanities and showers; there will never be a fight (for space).

For more details please visit :

<https://www.summitbunbury.com.au/4733852>

Price: Offers Over \$439,000



Lorraine Grassie

Ground Floor

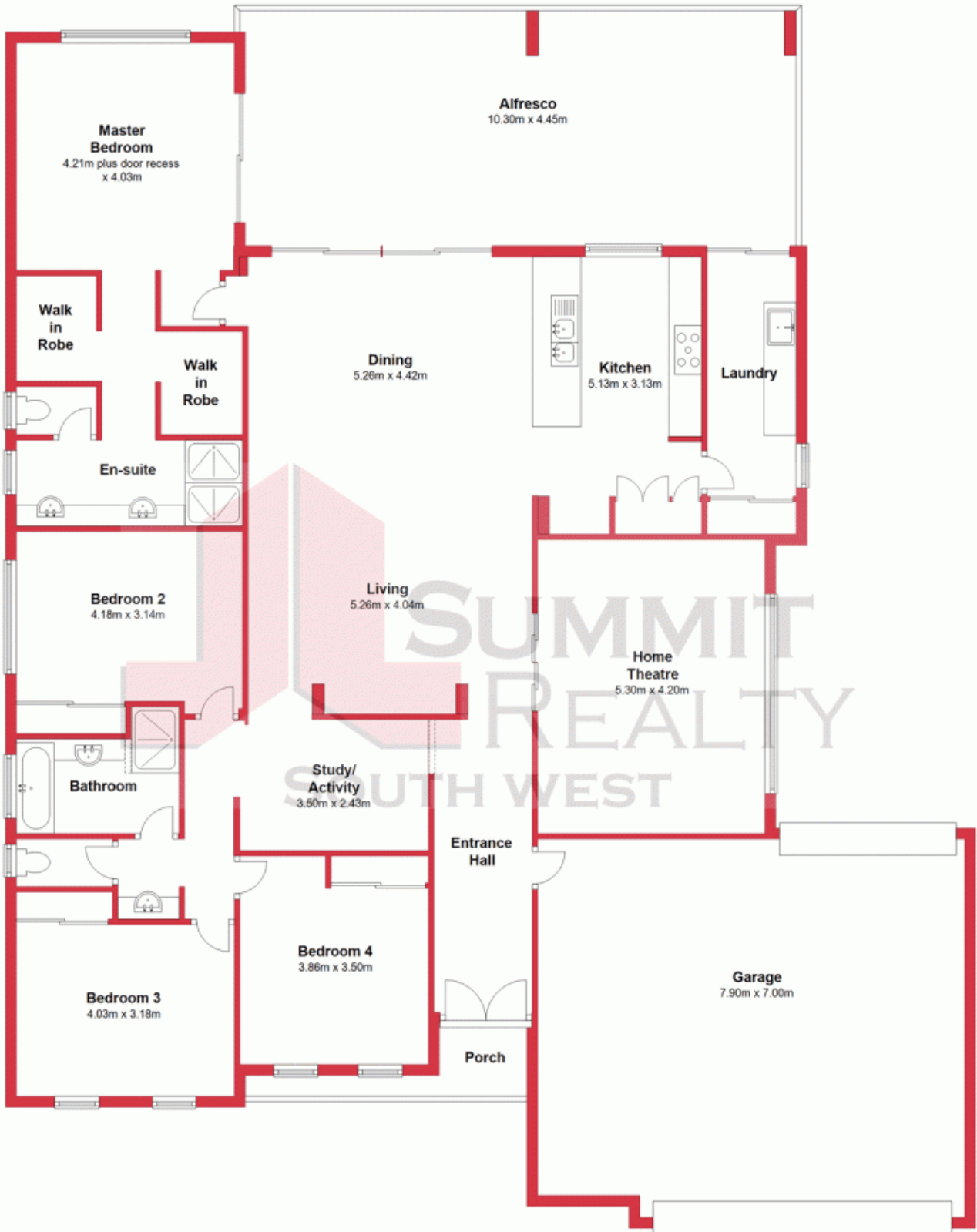

This plan has been prepared for marketing purposes only. Whilst every care is taken in the production of this plan, measurements, angles and positioning of doors/windows may not be accurate. Interested parties are strongly advised to undertake their own checks when establishing the suitability for furniture etc. Not To Scale.

Plan produced using PlanUp.

7 Lindfield Road

7 Lindfield Road, Australind
AUSTRALIND, WA

