



13 Malabor Retreat EATON, WA

 3
  1
  2

Great First Home or Downsizer

When you have a number of affordable homes to look at in Eaton, be sure to include this lovely three bedroom one bathroom home. This solid brick and tile home is in a great location close to the children friendly Lofthouse Park, minutes drive from the Eaton Fair Shopping Centre and easy walk of bike ride to local schools. Other features include:

- Open plan kitchen, dining and living room with split air-conditioning.
- Three large bedrooms with built-in-robos
- One main bathroom & separate toilet
- Large patio for entertaining family and friends
- Separate laundry
- Double colourbond workshop
- Currently tenanted with details available upon request

This home is great value with a motivated seller. For further information or to book your

For more details please visit :

<https://www.summitbunbury.com.au/4733869>

Price: \$290,000 - \$310,000



Lorraine Grassie

Ground Floor

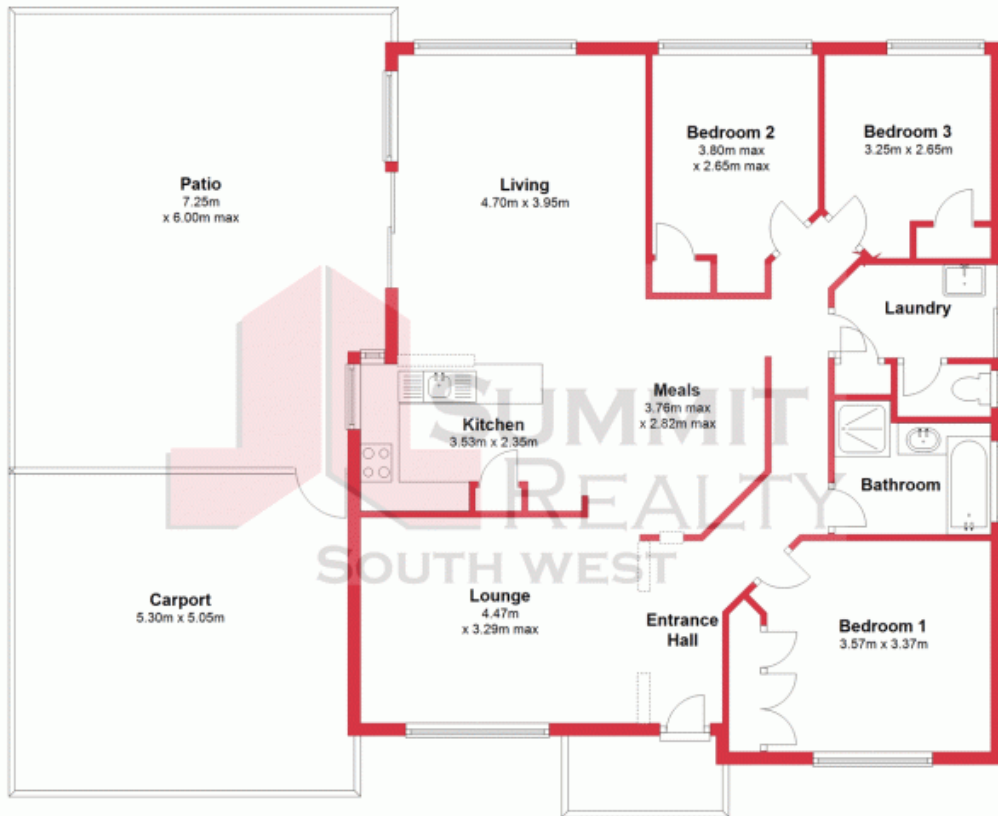

This plan has been prepared for marketing purposes only. Whilst every care is taken in the production of this plan, measurements, angles and positioning of doors/windows may not be accurate. Interested parties are strongly advised to undertake their own checks when establishing the suitability for furniture etc. Not To Scale.
Plan produced using PlanUp.

13 Malabor Retreat, Eaton

13 Malabor Retreat

EATON, WA

