



81 Mardo Avenue AUSTRALIND, WA

 3
  1
  2

A TERRIFIC START AWAITS YOU!

Sitting comfortably on a 635m² block, directly across from the Leschenault Catholic Primary School and just a short drive to the Australind Shopping Centre, this well-presented property is an ideal first home or an excellent investment!

Featuring everything you could look for in a family home, with a spacious master, through to the multiple living areas and a great sized kitchen you can comfortably cook the family meals in.

Evaporative ducted air-conditioning throughout, solar panels, ceiling fans and a reverse cycle air con to the living, finishes the home off perfectly and promises comfort all year round.

Built in 1999, this property also features:

- Opposite Leschenault Catholic Primary School and close to Australind Primary and High Sc

For more details please visit :

<https://www.summitbunbury.com.au/4733871>

Price: \$329000



Lorraine Grassie

Ground Floor

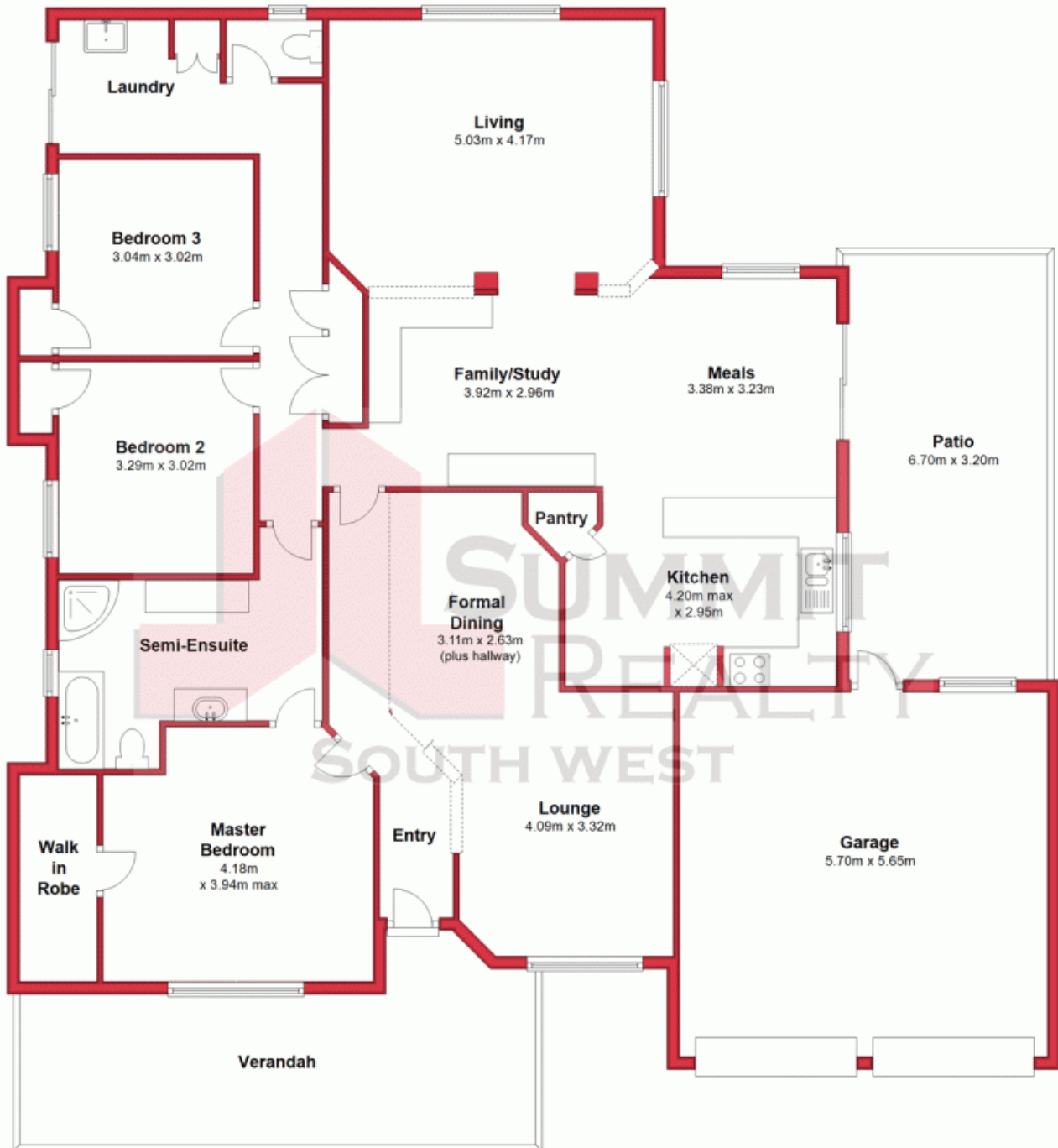

This plan has been prepared for marketing purposes only. Whilst every care is taken in the production of this plan, measurements, angles and positioning of doors/windows may not be accurate. Interested parties are strongly advised to undertake their own checks when establishing the suitability for furniture etc. Not To Scale.
Plan produced using PlanUp.

81 Mardo Avenue

81 Mardo Avenue, Australind
AUSTRALIND, WA

