



20 Clydesdale Drive EATON, WA

 3

 1

 1

## LOADS OF POTENTIAL

Situated on a 790m<sup>2</sup> block at 20 Clydesdale, Eaton is this nice neat and secure 3 bedroom 1 bathroom home. Ideal for first home buyers this property has plenty of potential and is great value for getting into the market. Side access is a huge bonus and even comes with a shed. Give Pat a call now for a private viewing.

Features include;

- Great size block 790m<sup>2</sup>
- 3 bedroom
- 1 bathroom
- Low maintenance home
- Side access
- Shed freshly painted

**Price:** From \$239,000



**Lorraine Grassie**

For more details please visit :

<https://www.summitbunbury.com.au/4733939>

## Ground Floor

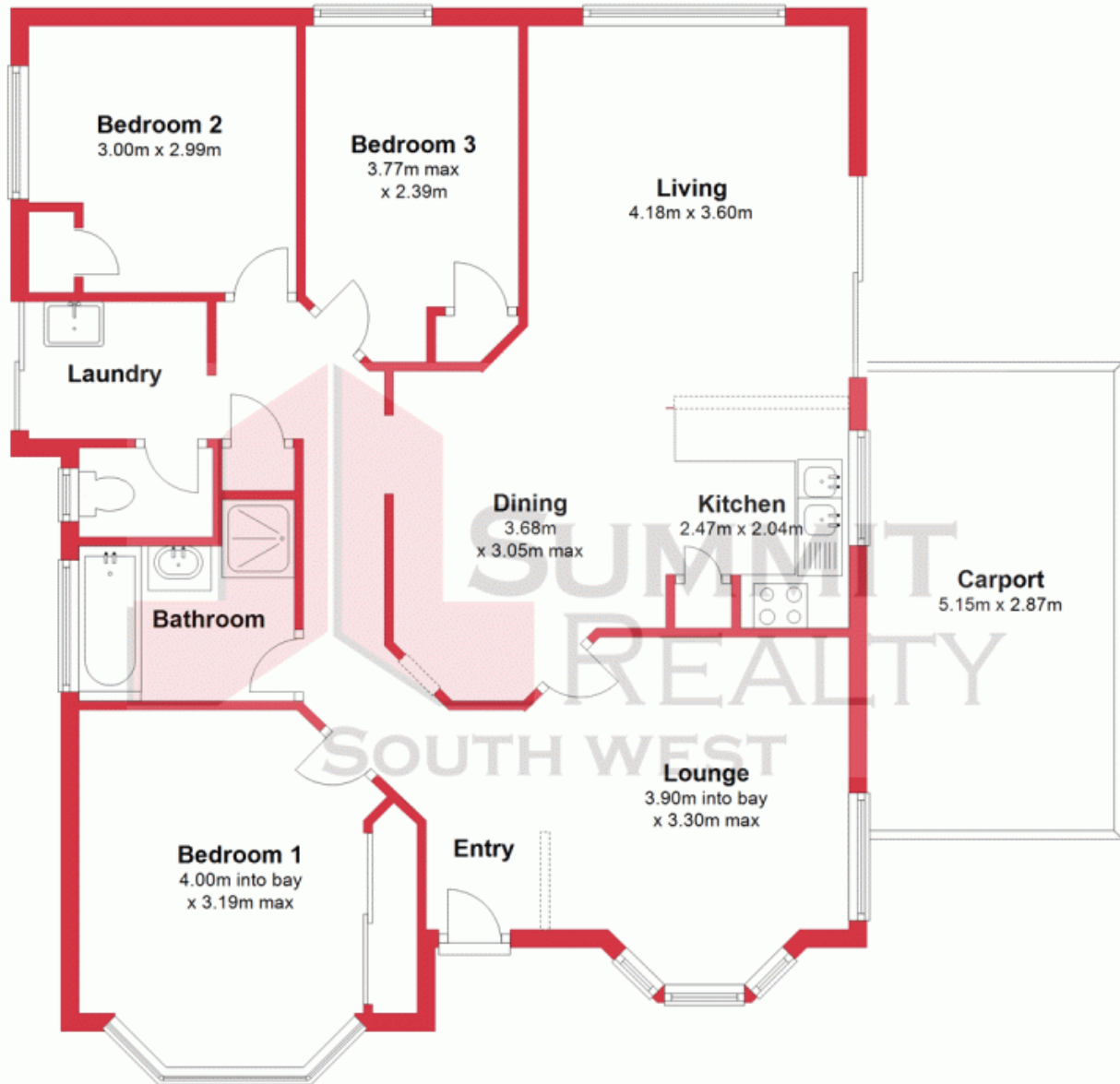

This plan has been prepared for marketing purposes only. Whilst every care is taken in the production of this plan, measurements, angles and positioning of doors/windows may not be accurate. Interested parties are strongly advised to undertake their own checks when establishing the suitability for furniture etc. Not To Scale. Plan produced using PlanUp.

20 Clydesdale Drive

20 Clydesdale Drive, Eaton  
EATON, WA

