



4 Ashford Place SOUTH BUNBURY, WA

3

1

1

LOCATION, LOCATION, LOCATION!

Ever wanted to live within 200 metres of the beach- Here is your chance, located on a massive 832m2 block this well presented 3 bedroom 1 bathroom home will leave you with options galore. This house oozes potential with a massive low maintenance backyard accompanied by a 6x3m powered workshop there really is something in this for all interested parties. Inside is neat and tidy with all bedrooms featuring ceiling fans and natural light. Something this close to the beach at that price surely will not last long so call today to arrange a private viewing.

Other features include:

- Three well sized bedrooms all with ceiling fans
- Master bedroom has built in robes
- Good size kitchen with ample bench space
- Separate dining area
- Generous size living area

For more details please visit :

<https://www.summitbunbury.com.au/4733962>

Price: From \$390,000



Tim Cooper

0437 068 028

Ground Floor

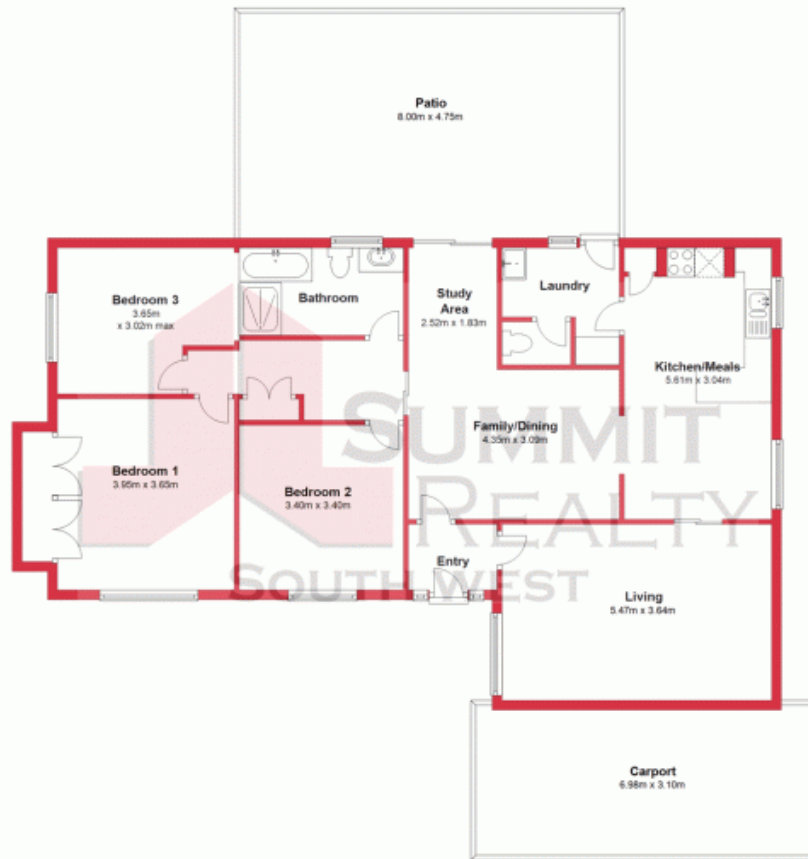

This plan has been prepared for marketing purposes only. Whilst every care is taken in the production of this plan, measurements, angles and positioning of doors/windows may not be accurate. Interested parties are strongly advised to undertake their own checks when establishing the suitability for furniture etc. Not To Scale.
Plan produced using PlanUp.

4 Ashford Place, South Bunbury

4 Ashford Place

SOUTH BUNBURY, WA

