



2 Pratt Road EATON, WA



4



2



3

ULTIMATE LIFESTYLE PROPERTY

It is an absolute pleasure to present this ultimate lifestyle property where you can spend your days crabbing, fishing, kayaking and picnicking on the banks of the Collie River, just a 150-metre stroll away, or enjoy an alfresco lunch under your massive entertainers patio while you overlook the stunning outdoors.

The large 2000m² block is surrounded by lush green trees and feels even larger with the Collie River reserve bordering the property.

If you are looking for a lifestyle property - then this is the one to view!

This home also features:

For more details please visit :

<https://www.summitbunbury.com.au/4734012>

Price: Offers Over \$650,000



Lorraine Grassie

Ground Floor

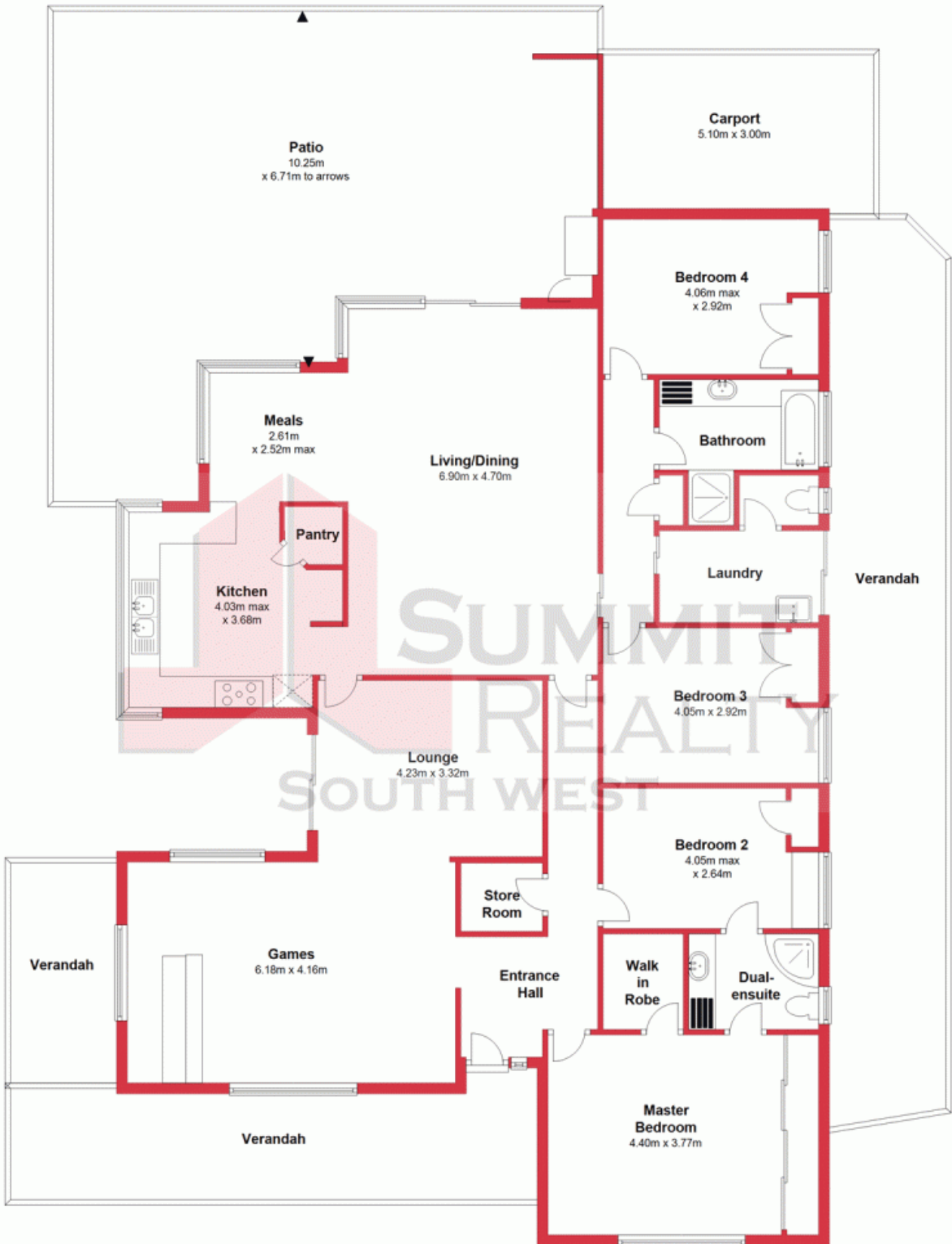

This plan has been prepared for marketing purposes only. Whilst every care is taken in the production of this plan, measurements, angles and positioning of doors/windows may not be accurate. Interested parties are strongly advised to undertake their own checks when establishing the suitability for furniture etc. Not To Scale.

Plan produced using PlanUp.

2 Pratt Road

**2 Pratt Road, Eaton
EATON, WA**

