



57 George Avenue BRUNSWICK, WA

 3
  2
  2

NEAT AS A COUNTRY PIN

Located at the foot of the Roeland hills in the popular rural town of Brunswick sits this well-kept 3-bedroom, 2-bathroom home on a large 808m² block.

Immaculately presented and offering you a low maintenance lifestyle, the floor plan encompasses a Master bedroom with walk in robe and ensuite, two well sized secondary bedrooms both complete with built in robes, separate family room, well-equipped kitchen and an open plan living and dining with wood fireplace and reverse cycle air-conditioning.

Built-in 2006 this property features:

Price: \$310000



Lorraine Grassie

For more details please visit :
<https://www.summitbunbury.com.au/4734018>

Ground Floor

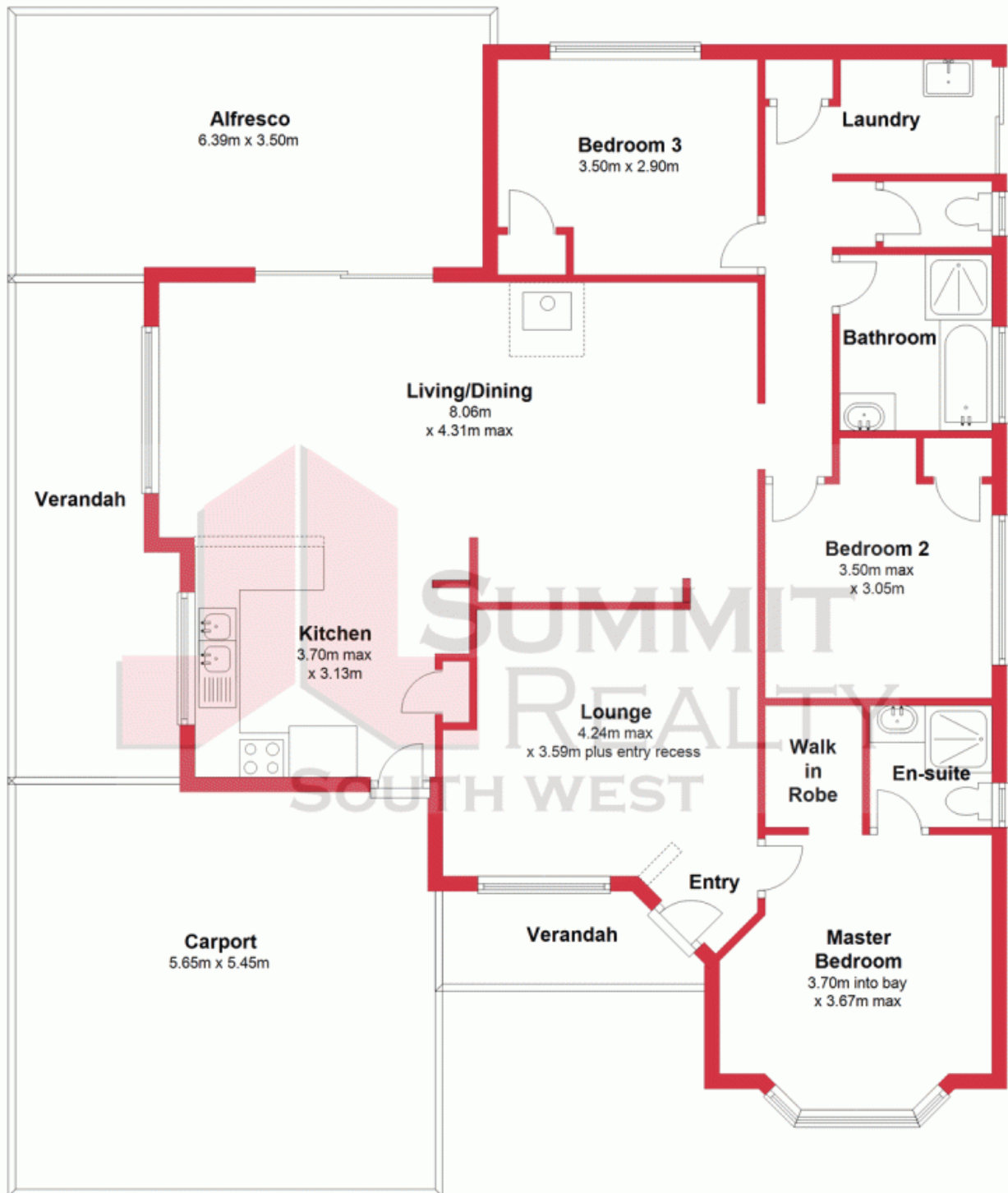

This plan has been prepared for marketing purposes only. Whilst every care is taken in the production of this plan, measurements, angles and positioning of doors/windows may not be accurate. Interested parties are strongly advised to undertake their own checks when establishing the suitability for furniture etc. Not To Scale.
Plan produced using PlanUp.

57 George Avenue

57 George Avenue, Brunswick
BRUNSWICK, WA

