



3 Batavia Place AUSTRALIND, WA

 4
  2
  2

SOPHISTICATED FAMILY RESIDENCE

Loaded with everything you desire in a luxury home; this premier 4 bedroom residence is the epitome of style and sophistication.

Delivering an array of immaculate living zones flowing over two spacious levels, with almost 400m² of living, the floor plan encompasses a sleek designer kitchen, sumptuous master suite, massive open plan living, dining and kitchen, games room with potential bar/kitchenette, large activity room, study area and ample storage options.

As expected in a property of this calibre, you are afforded an abundance of space and quality in a location you will love.

Built in 2007, this property features:

Price: \$795,000 - \$825,000



Lorraine Grassie

For more details please visit :
<https://www.summitbunbury.com.au/4734022>

Lower Ground

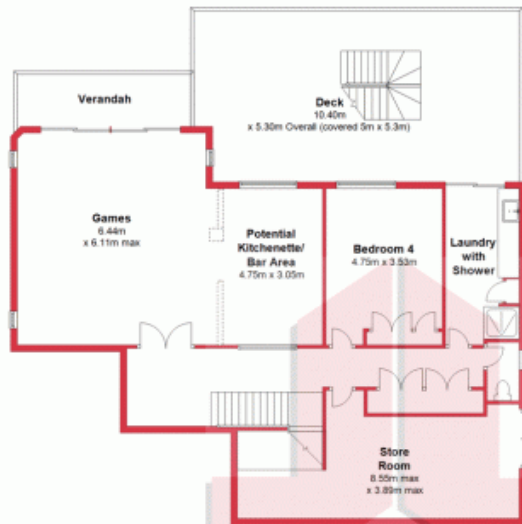

Ground Floor

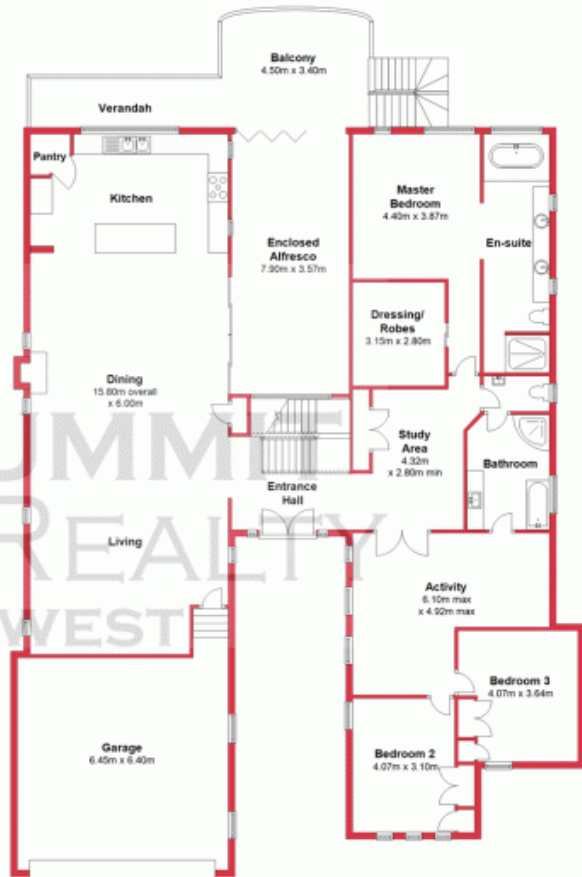

This plan has been prepared for marketing purposes only. Whilst every care is taken in the production of this plan, measurements, angles and positioning of doors/windows may not be accurate. Interested parties are strongly advised to undertake their own checks when establishing the suitability for furniture etc. Not To Scale.
Plan produced using PlanUp.

3 Batavia Place, Australind

3 Batavia Place

AUSTRALIND, WA

