



1/14 Coote Place USHER, WA

 3
  1
  1

PERCHED HIGH ON THE HILL

This fantastic three bedroom one bathroom home is on a large elevated 424m2 block. With great living areas and situated in a peaceful neighbourhood it is a great starter home or investment. Located just metres from Usher Medical Centre and Pharmacy with St Josephs Primary, shopping, hospital and Sports Centre close by. Easy access to CBD along Ocean drive.

Some of the features on offer are:

Feature front door, semi return verandas & French style windows all a nod to federation styling

Two living areas, beginning with a generously sized lounge room, enjoying views

Open plan family shares views

Double doors lead to outside veranda

Two secondary bedrooms with BIRs

Keep your cool with climate control: living areas & 3 bedrooms have split Reverse Cycle A/

For more details please visit :

<https://www.summitbunbury.com.au/4734041>

Price: From \$250,000



Tim Cooper

0437 068 028

Ground Floor

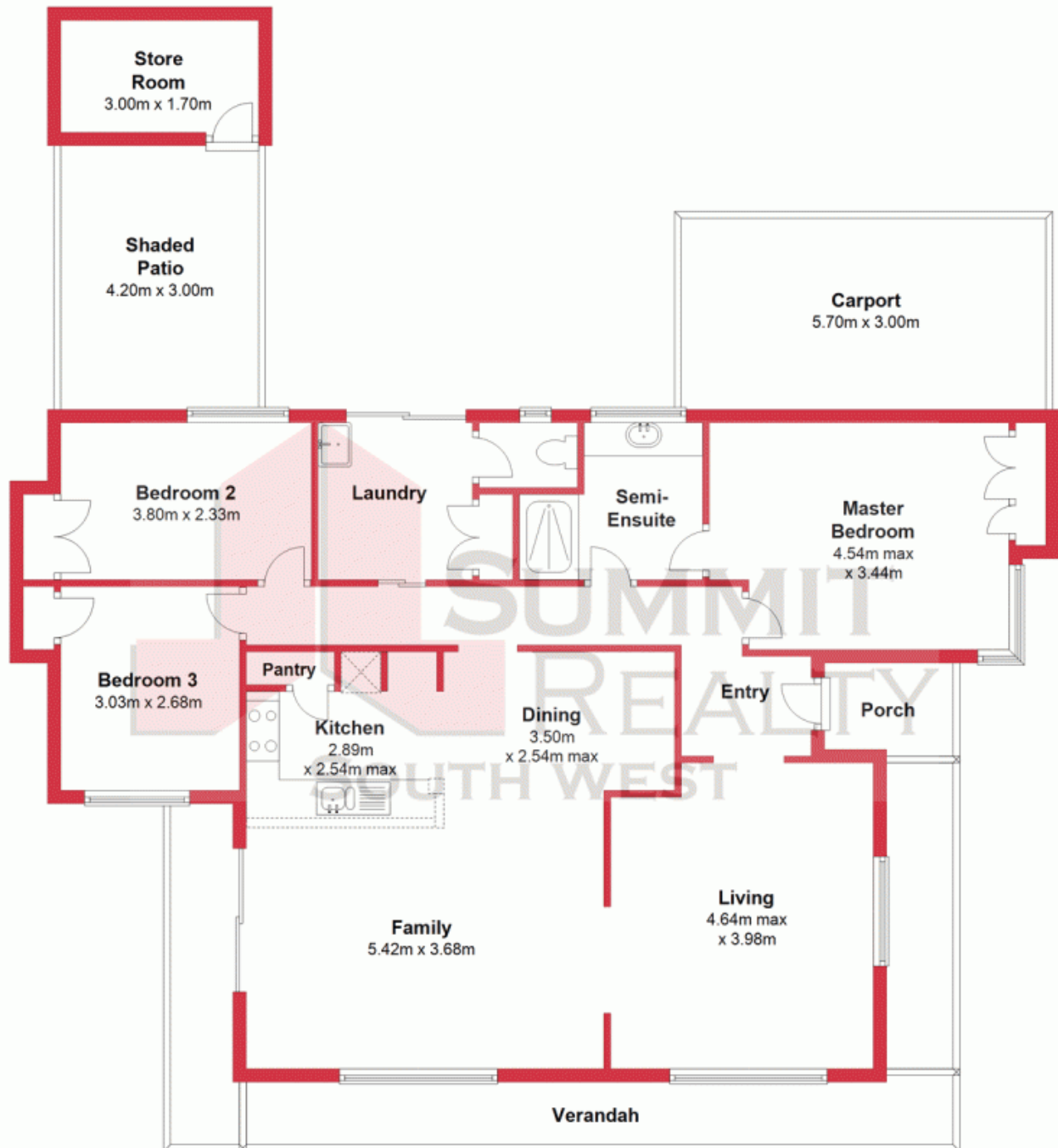

This plan has been prepared for marketing purposes only. Whilst every care is taken in the production of this plan, measurements, angles and positioning of doors/windows may not be accurate. Interested parties are strongly advised to undertake their own checks when establishing the suitability for furniture etc. Not To Scale.

Plan produced using PlanUp.

1/14 Coote Place

14a Coote Place, Usher, WA

