



22 Graphite Turn DALYELLUP, WA



TRULY SPACIOUS

Attractively positioned opposite a bush corridor this home holds the promise of very comfortable living for its fortunate new owners.

Welcoming you to this family sized property is a deep entry with enough veranda to sit and enjoy the beautiful retained native garden complimenting the home. The natural colours in the building reflect its surroundings very well.

The multiple living areas mean there is space for all the family to spread out and enjoy time on their own or chose to party together.

Features of note include:

For more details please visit :
<https://www.summitbunbury.com.au/4734044>

Price: \$355,000-\$375,000



Lorraine Grassie

Ground Floor

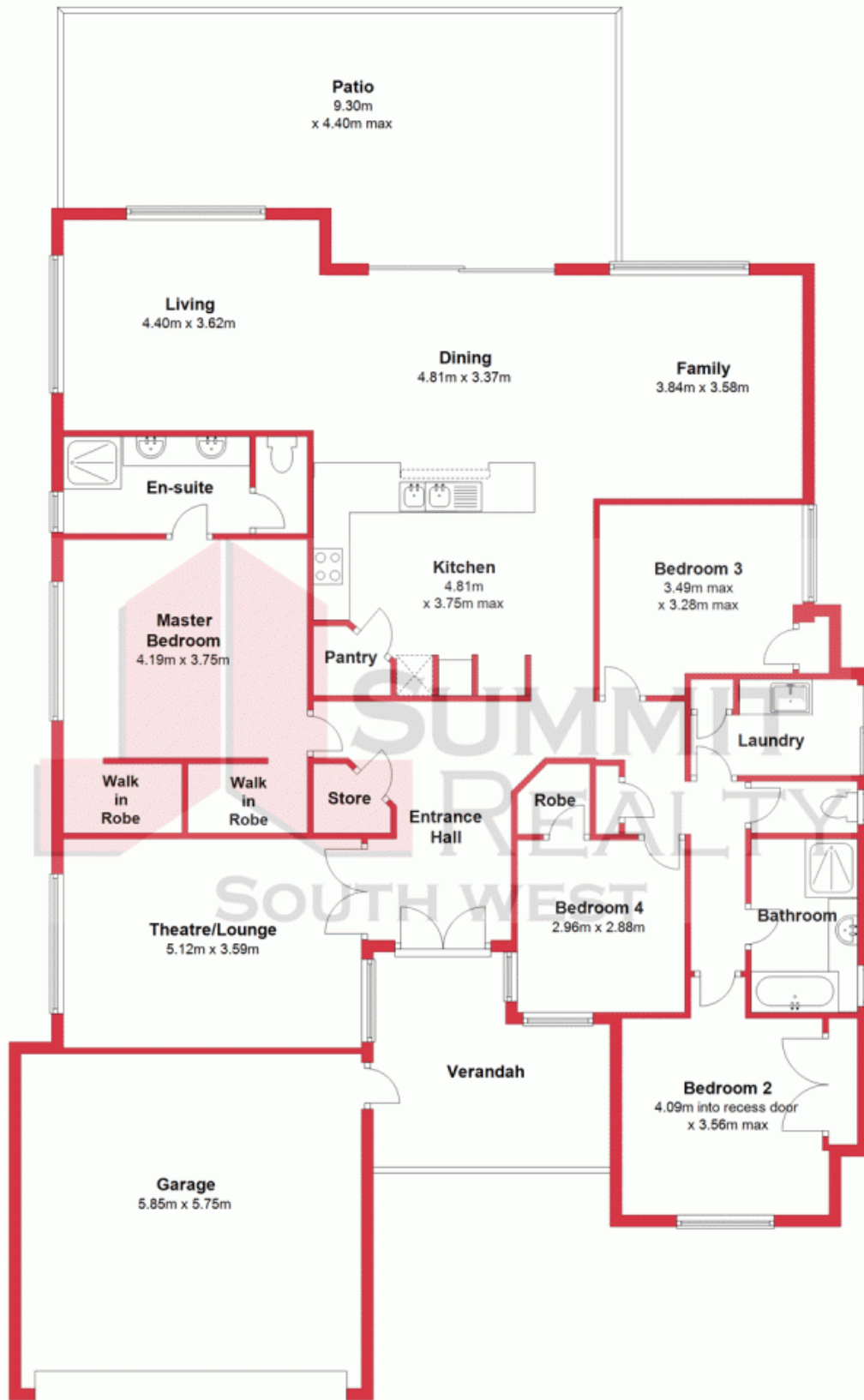

This plan has been prepared for marketing purposes only. Whilst every care is taken in the production of this plan, measurements, angles and positioning of doors/windows may not be accurate. Interested parties are strongly advised to undertake their own checks when establishing the suitability for furniture etc. Not To Scale.

Plan produced using PlanUp.

22 Graphite Turn

22 Graphite Turn, Dalvellup
DALVELLUP, WA

